

Mirror Models 35804 US Diamond T 972 Dump Truck



# Assembly instructions

# Diamond T 972 Dump Assembly Guide

Diamond T 972 was a dump truck based on a 4 ton 6x6 chassis, powered with a Hercules RXC six-cylinder gasoline engine and equipped with a five-speed overdrive transmission and a direct and under drive transfer, manufactured from roughly 1940 until 1945 by the Diamond T Motor Car Company in Chicago. Design and development of the model 968 began in 1939, it was adapted for production in 1940, and produced from 1941 to 1945. From 1943 most trucks were fitted with open cab. These vehicles were also supplied to the Allied countries through the Lend-Lease Act, and after the WWII numbers of them were still in use in various countries for many years

## Parts:

Sprue A - single chassis parts, 2x sprue B - chassis parts and wheels, sprue C - engine, sprue D - bonnet and front cab parts, sprue S - cab parts, sprue X - cargo body parts, sprue U - clear parts, chain, decals, PE sheet

Go through assembly guide before you start your work. Some gates on this kit sprues are larger, because we don't want any ejector marks on parts, and also very thin true-to scale parts require larger gates to avoid filling issues, you need to use a little razor blade or sharp scalpel to remove these parts carefully.

## Working with PE parts:

Heat up PE parts with lighter before use, brass will soften and become easy to bend and work with

Tamiya Super Thin Glue Gunze Mr. Cement or other ABS plastic glues are recommended for plastic parts, let the glue work for a few seconds, then push parts together, melted plastic will fill the gaps between parts. You can also melt sprue frame and use it as an amazing filler for small works, or use this glue to wash out tiny seam lines on little parts or make texture on some parts etc. Fair amount of glue is necessary to melt ABS that is harder than usual styrene, but most of sprues in this kit are produced in usual polystyrene.

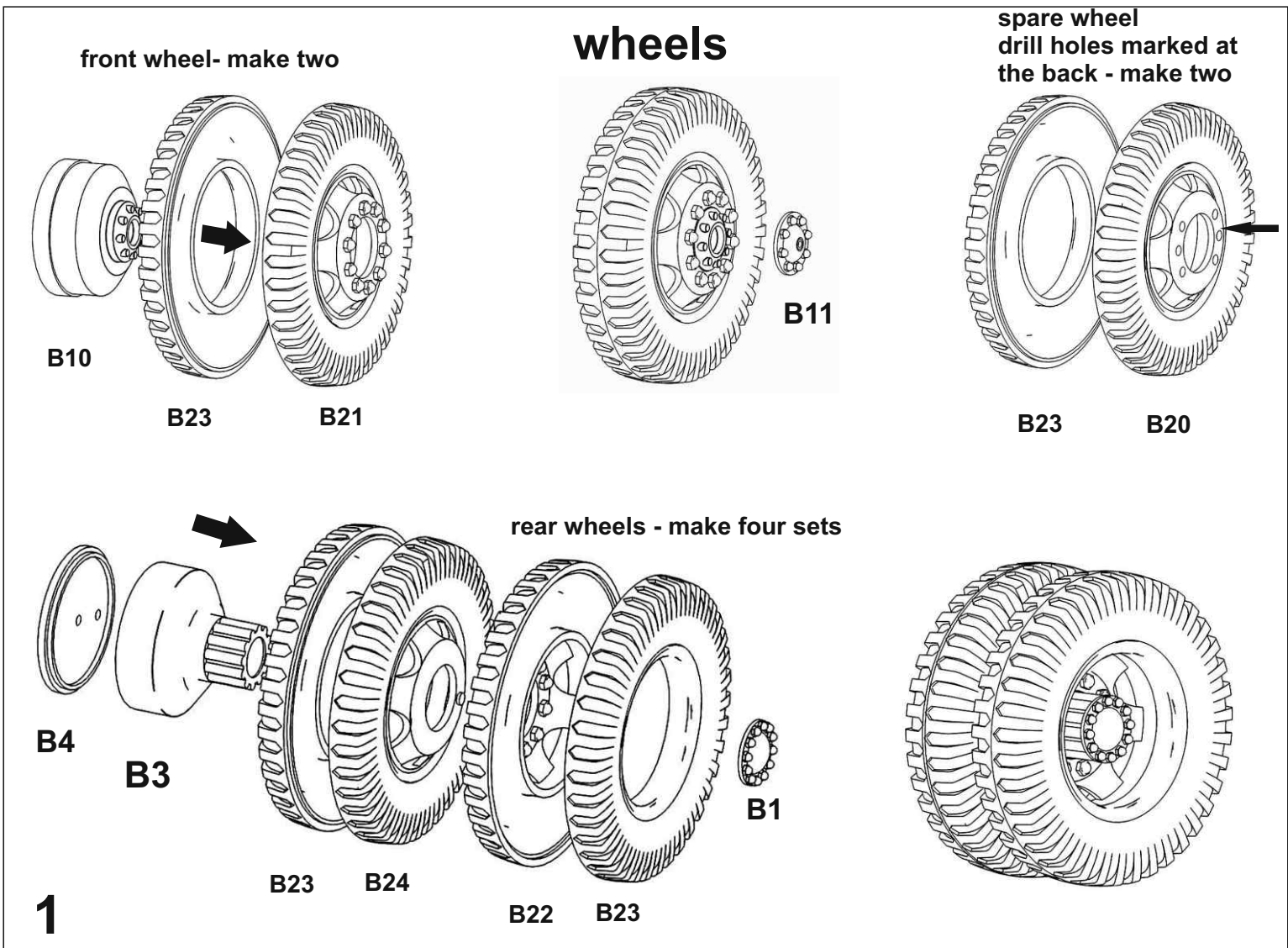

# Engine

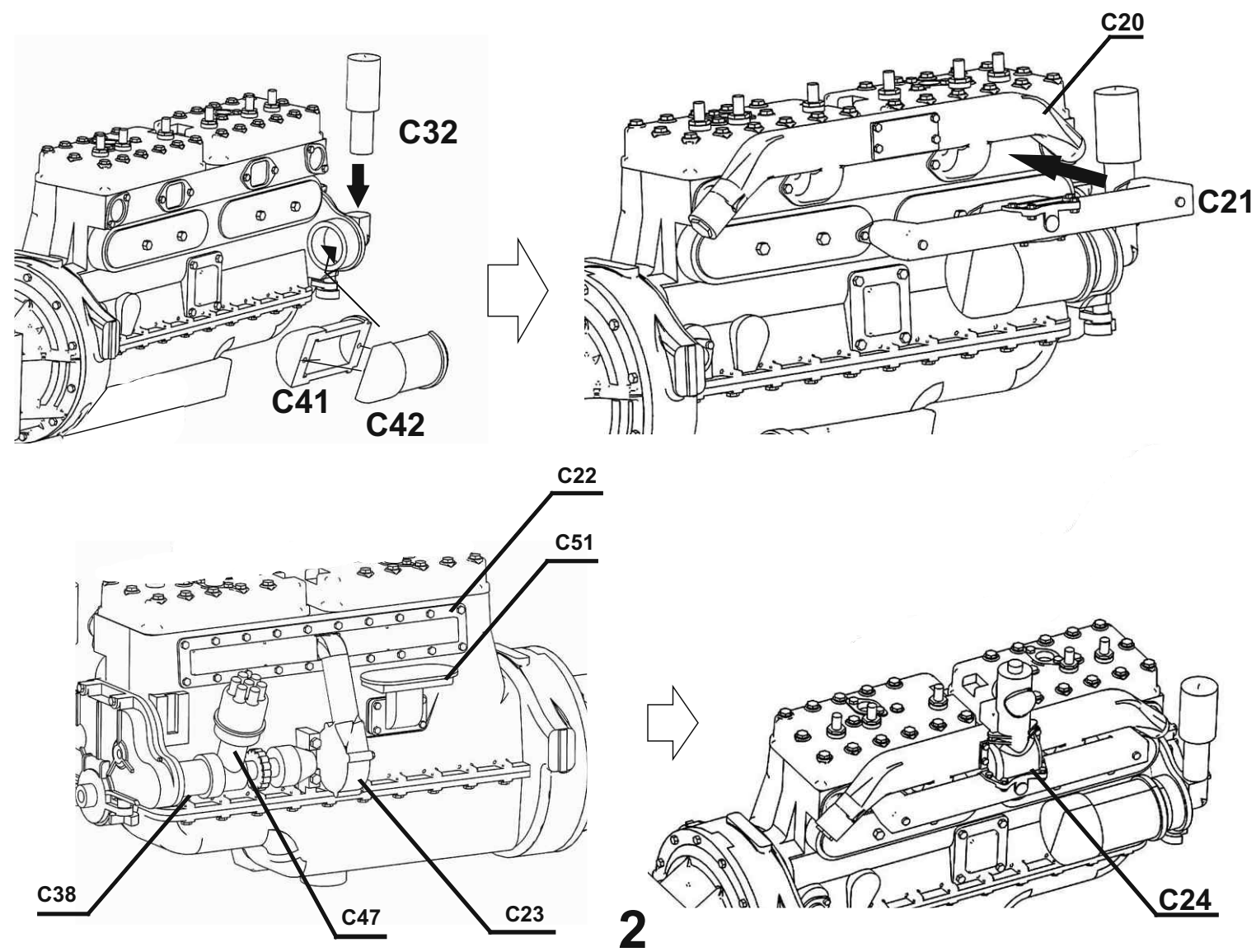
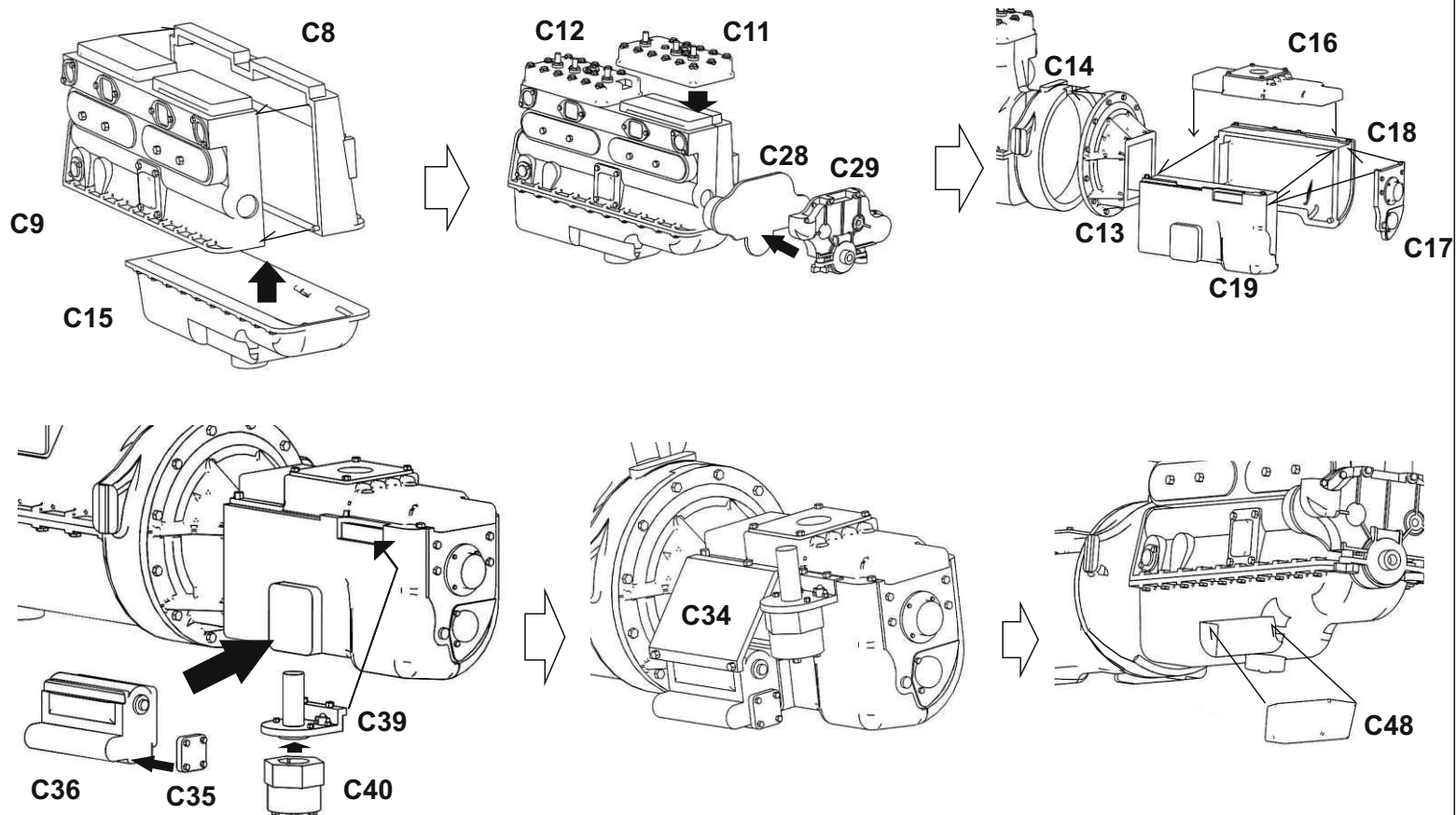

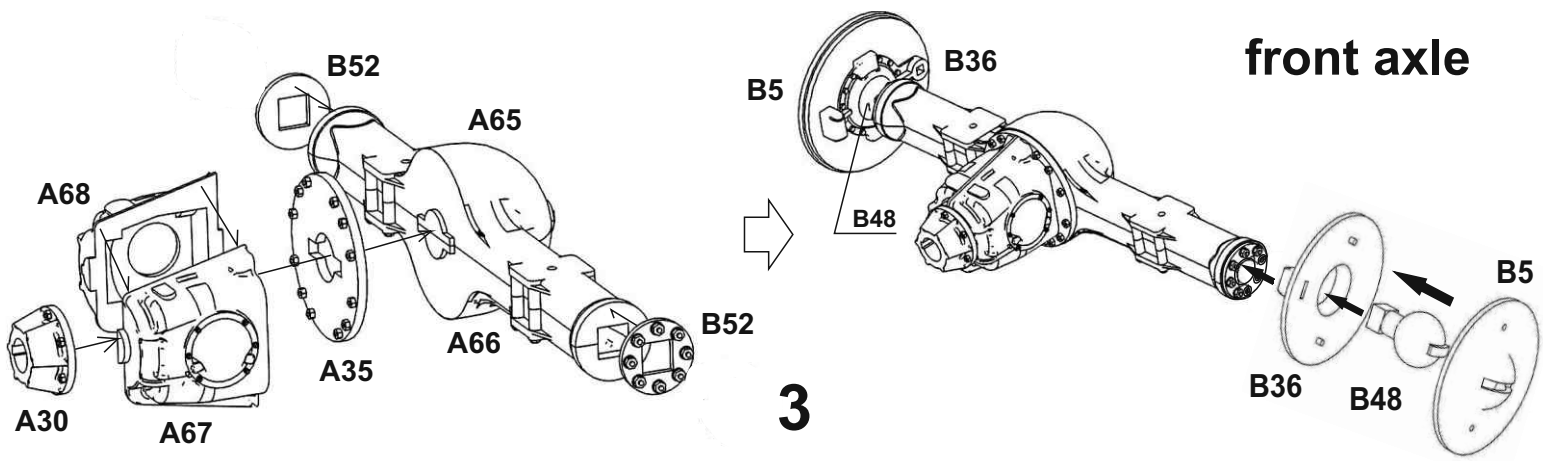
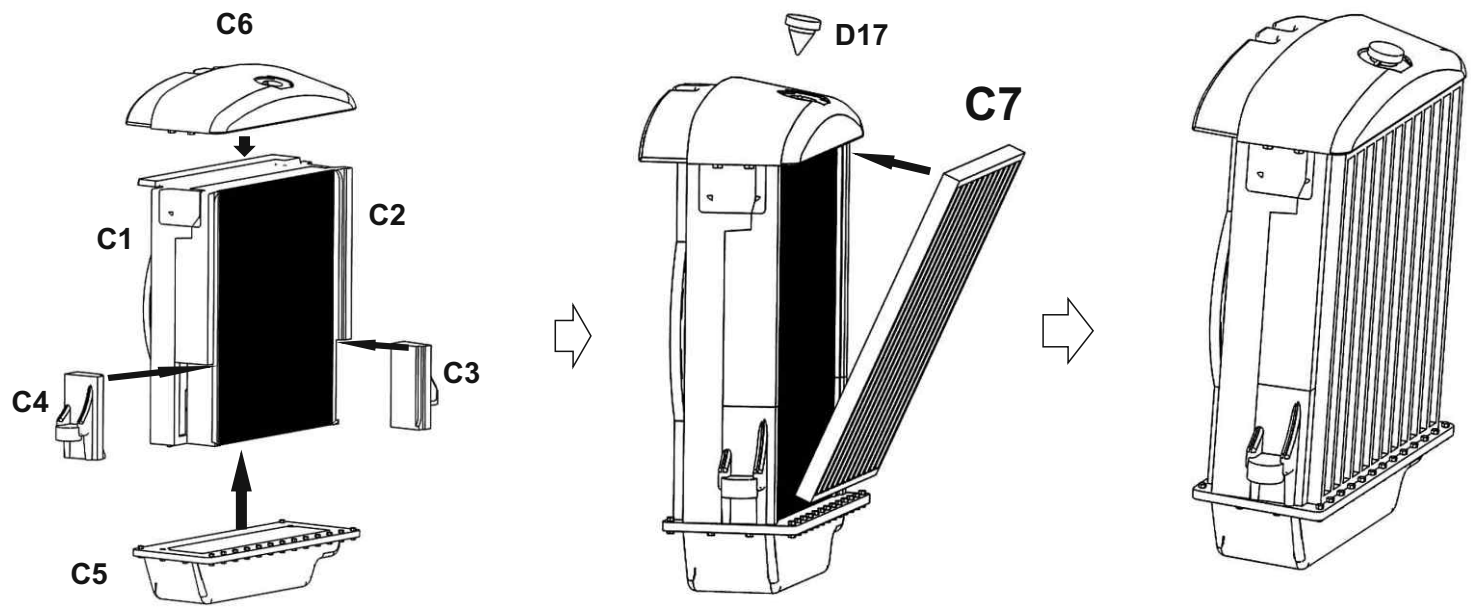
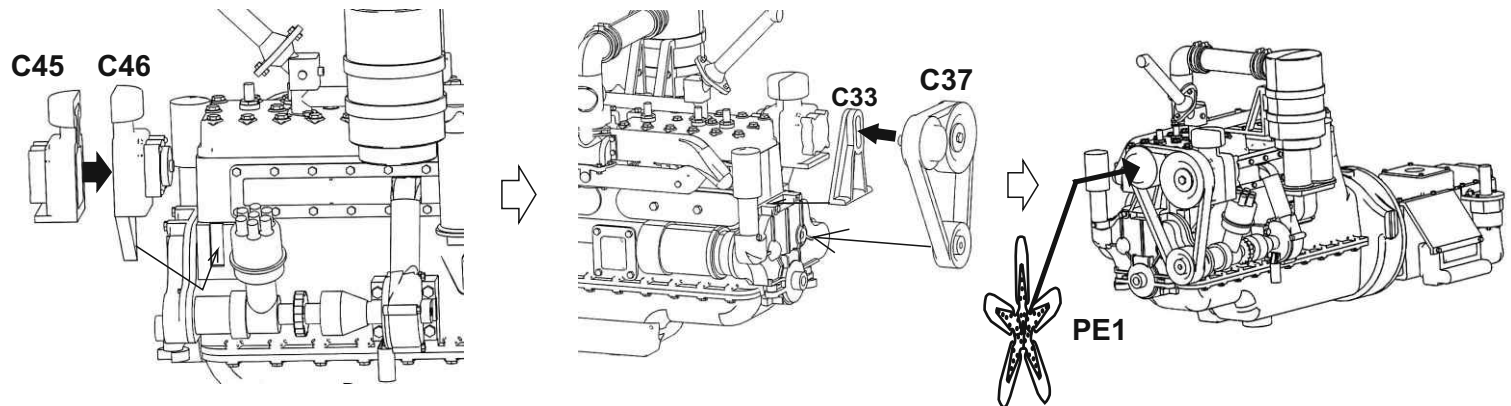
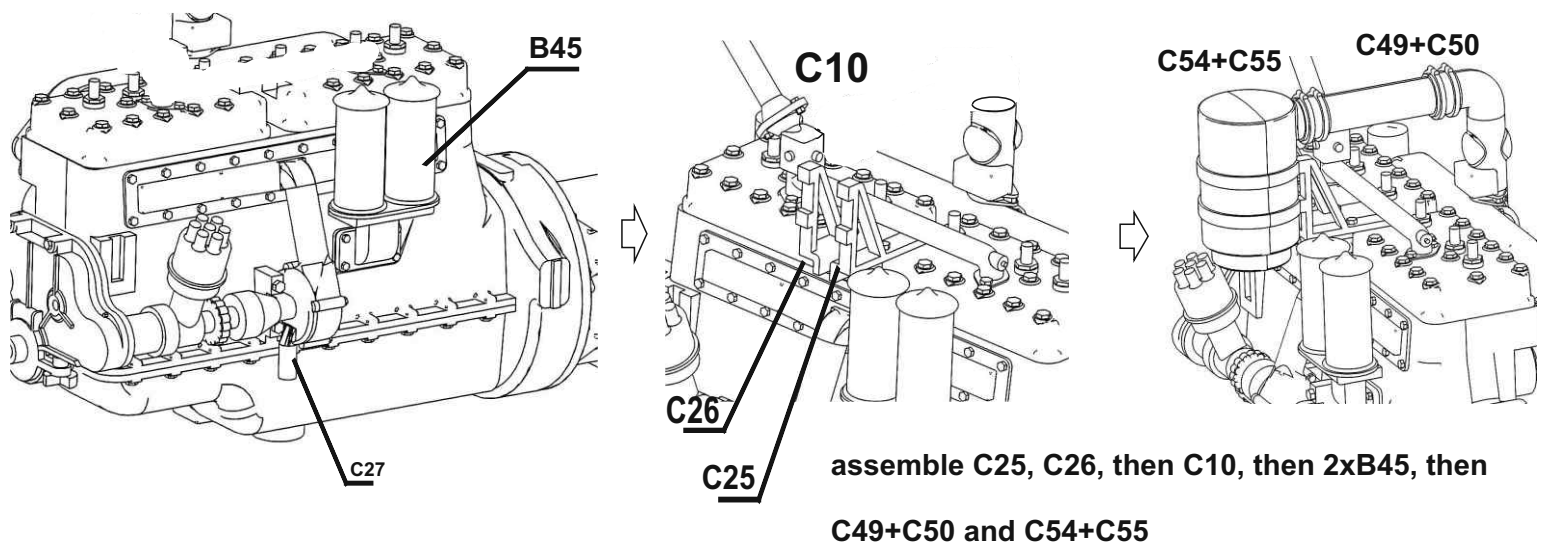

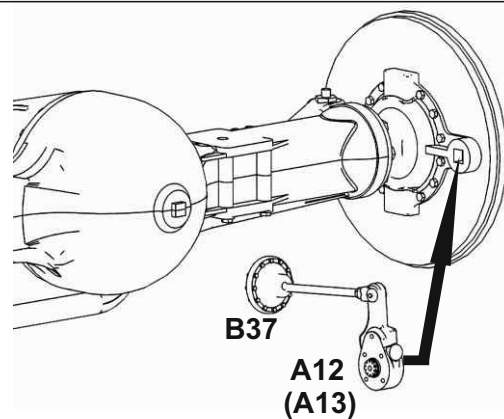
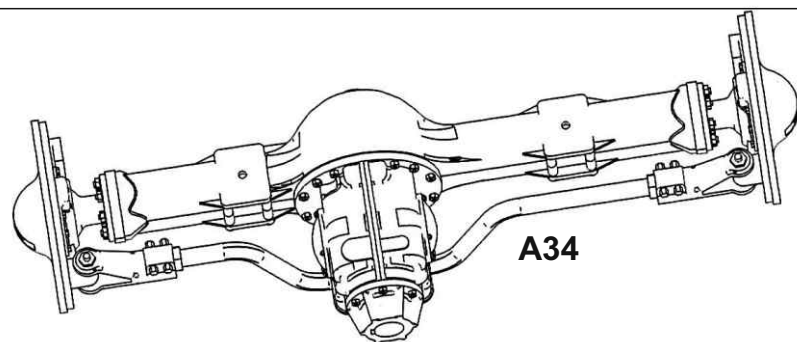

## Chassis

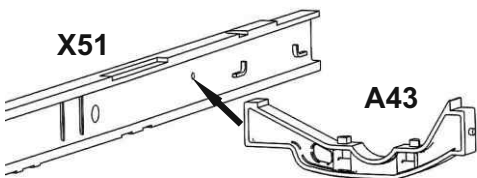

Assemble A43 into frame, but do not glue it until you fit engine later on, you might need to move it slightly forward or back, depending how accurate you have worked on back transmissions, make sure you use X51 and X52 frame parts from dump sprue

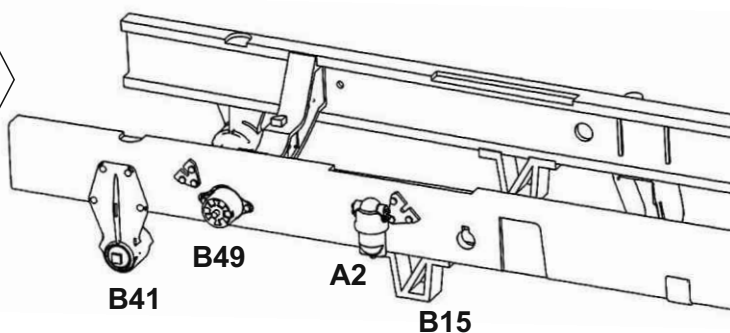
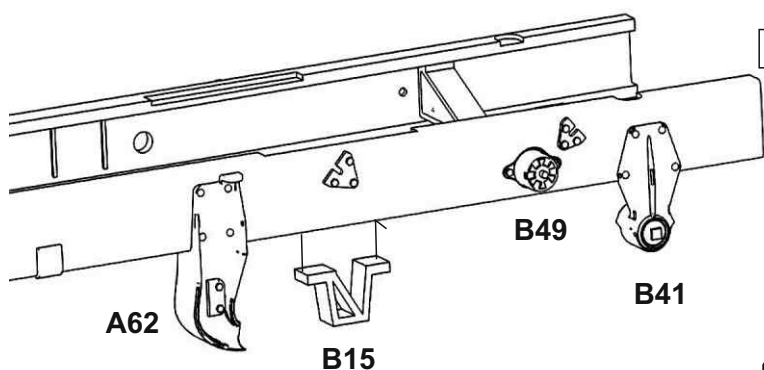
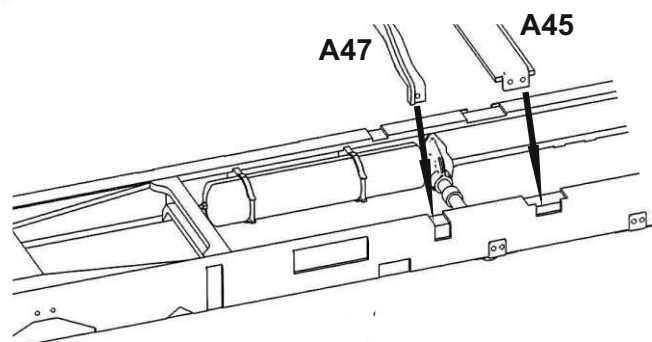
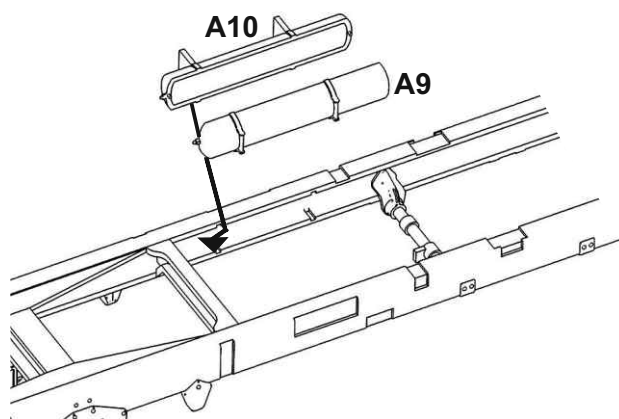
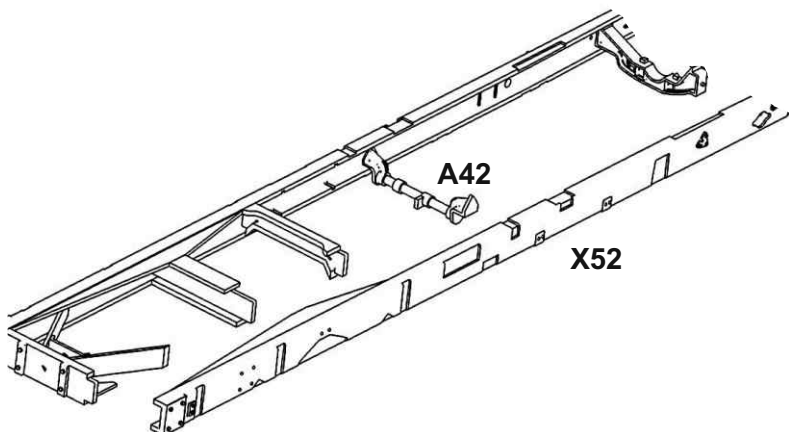
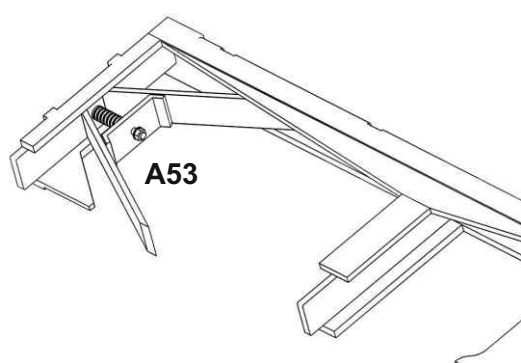
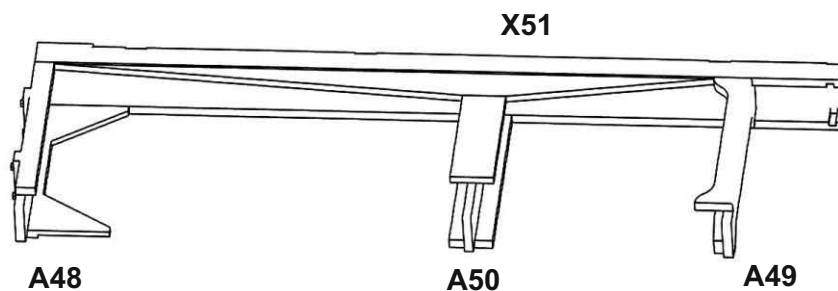

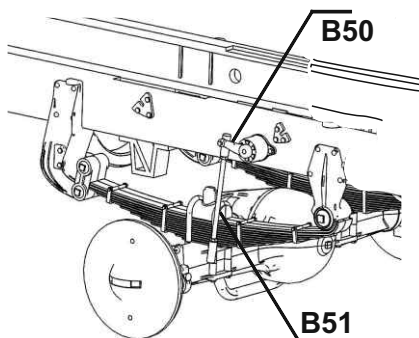
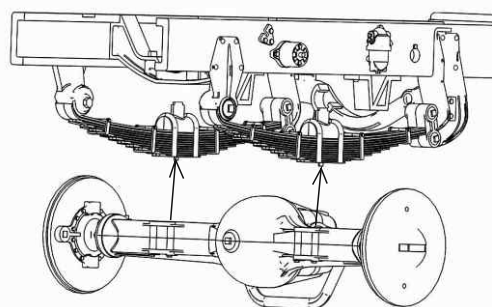
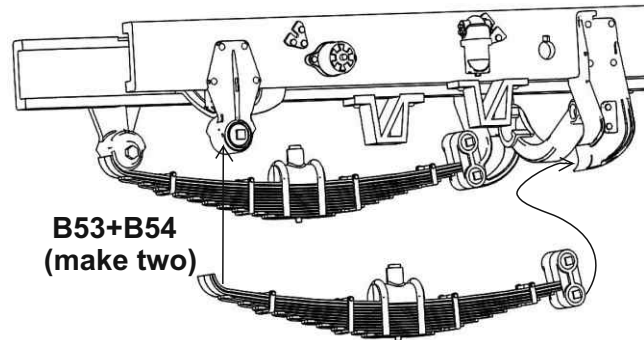
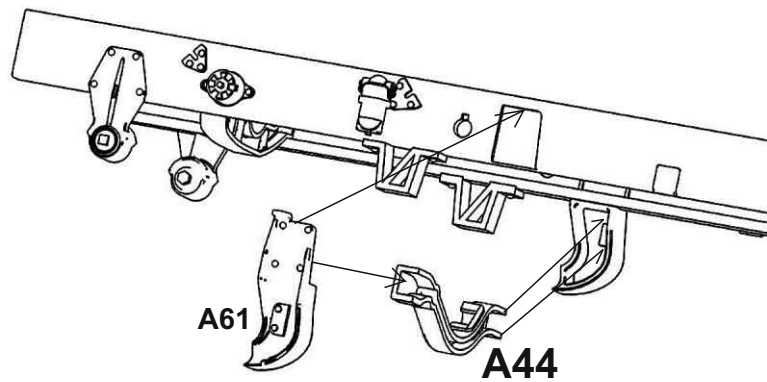

left side

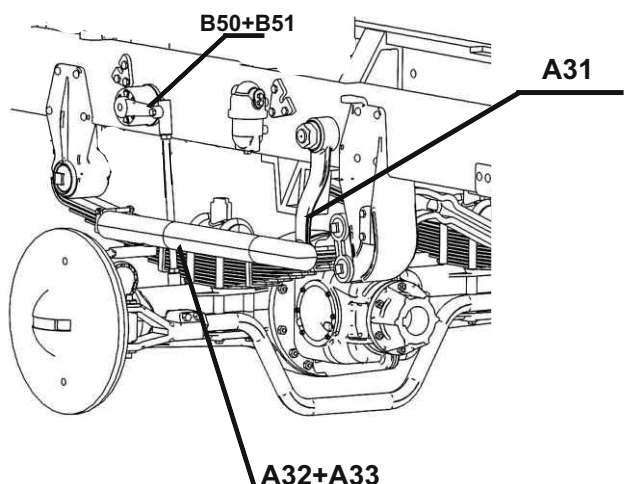
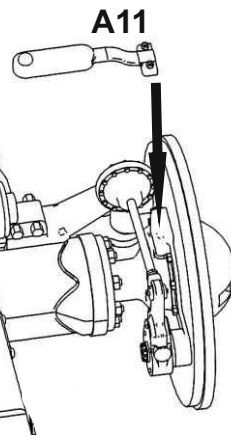

B29

make two

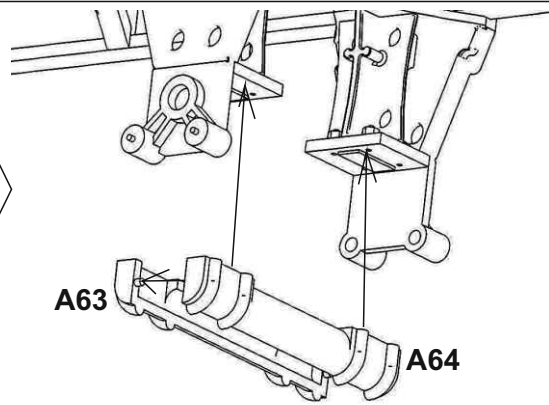
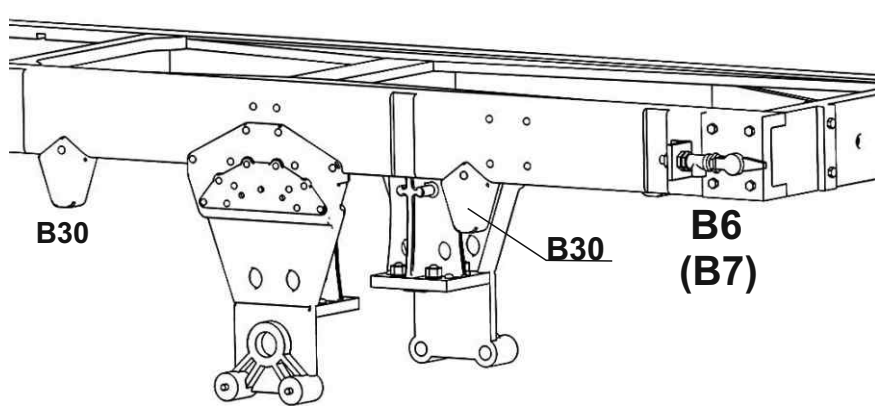
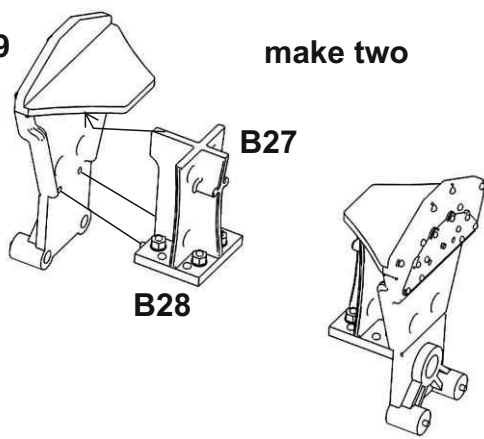

make two  
"XX"

B81

B70

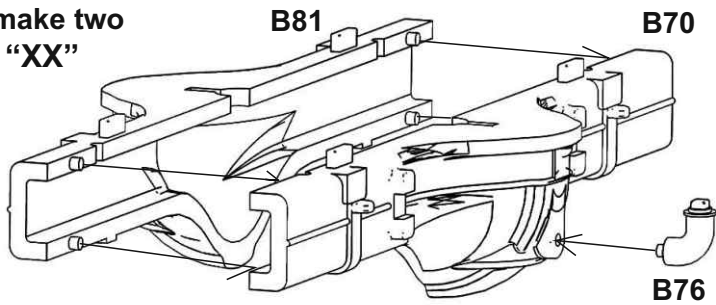

B31

B83

make two  
"AA"

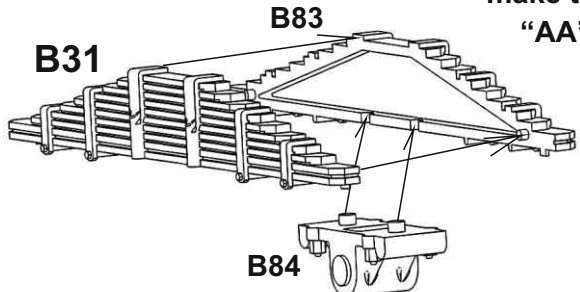



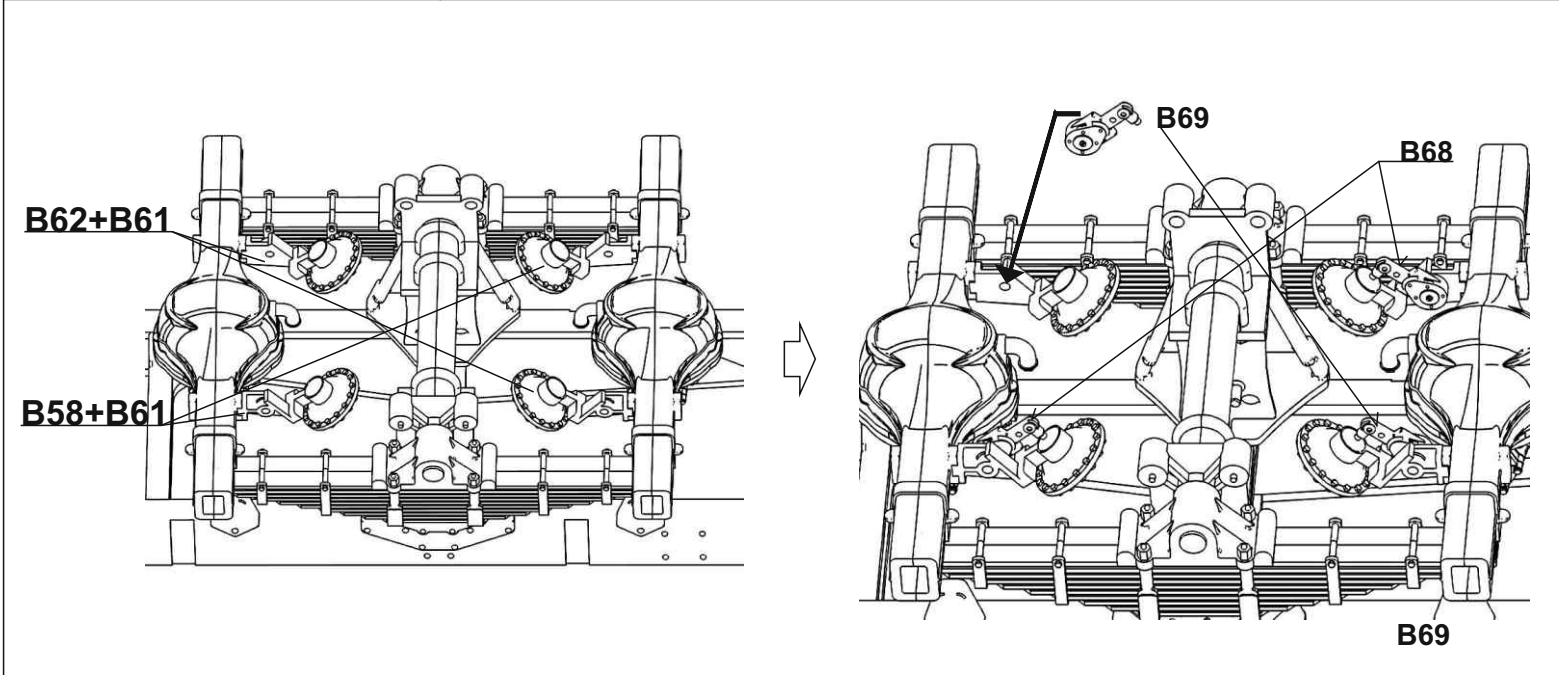
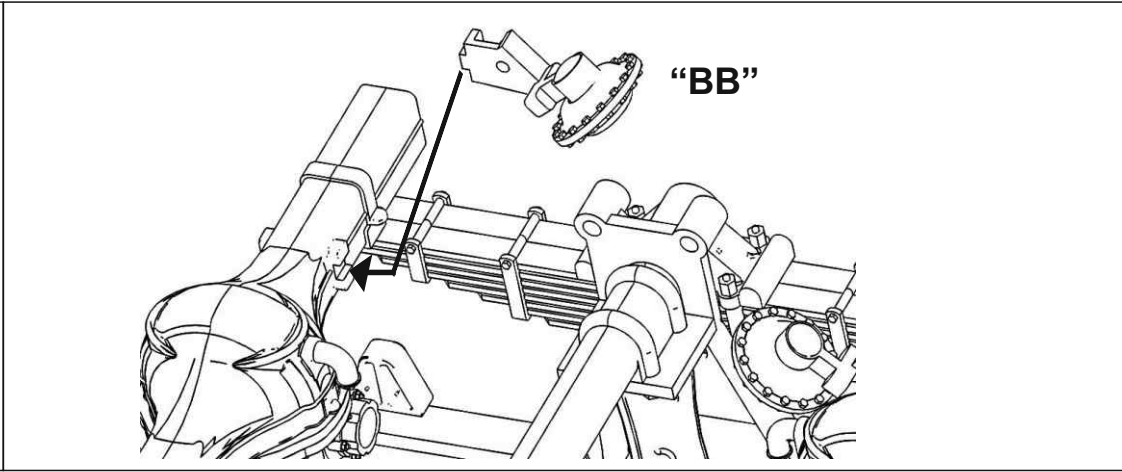
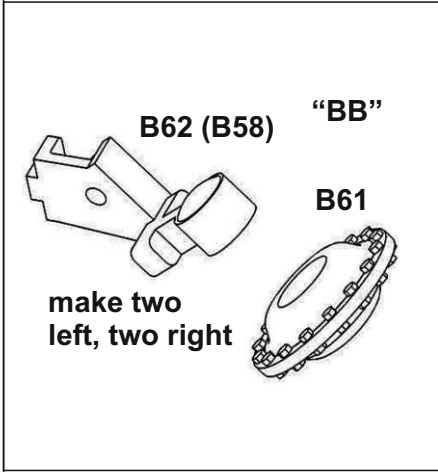
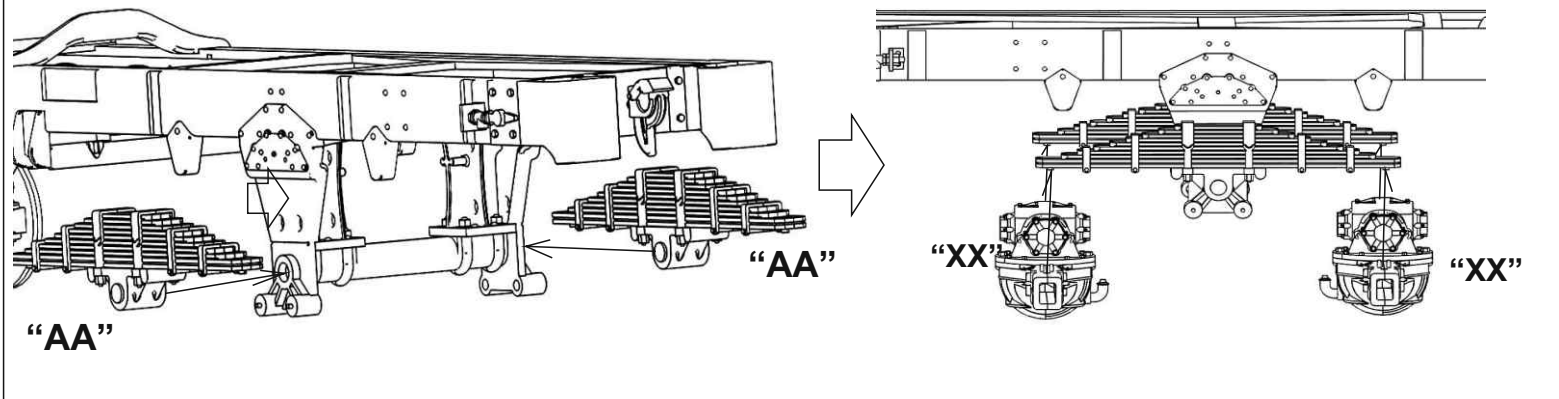
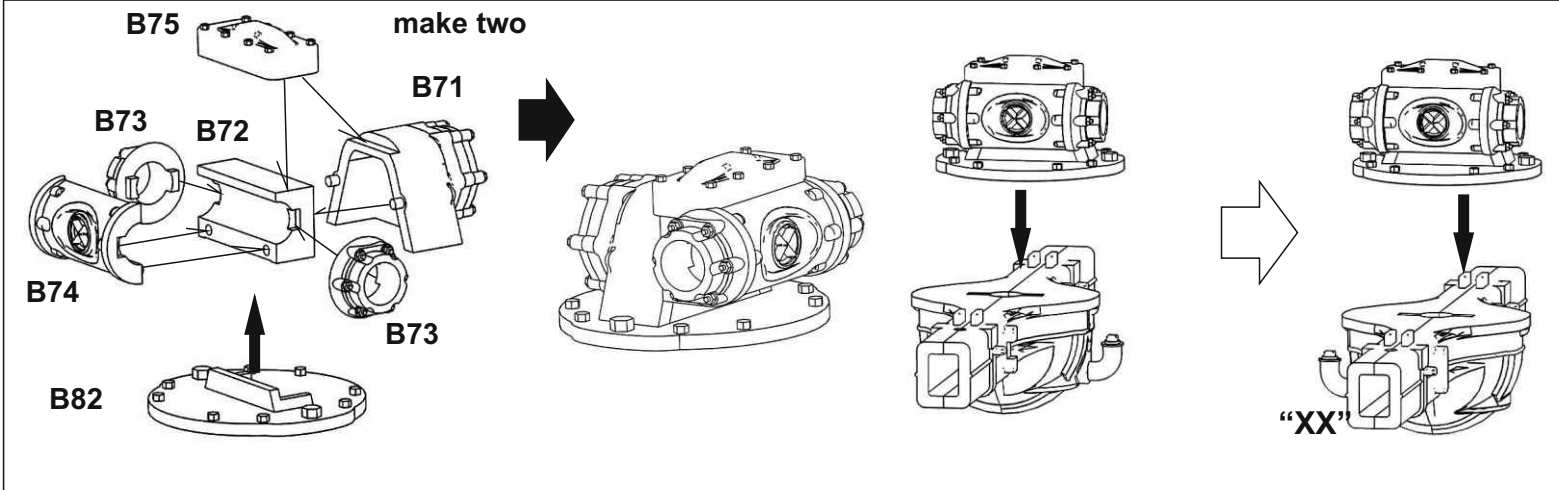

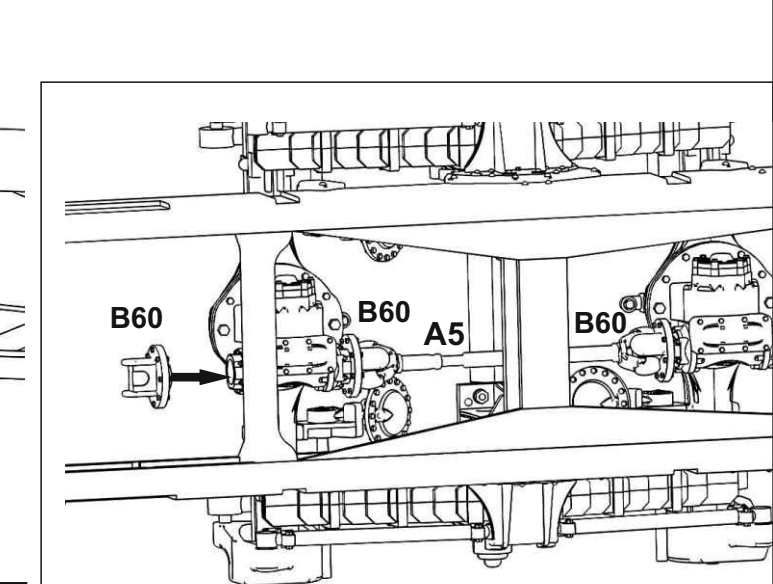
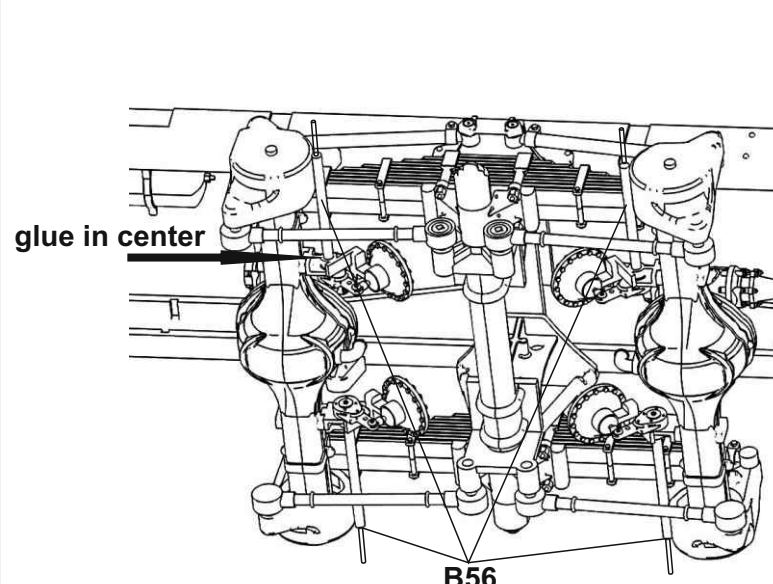
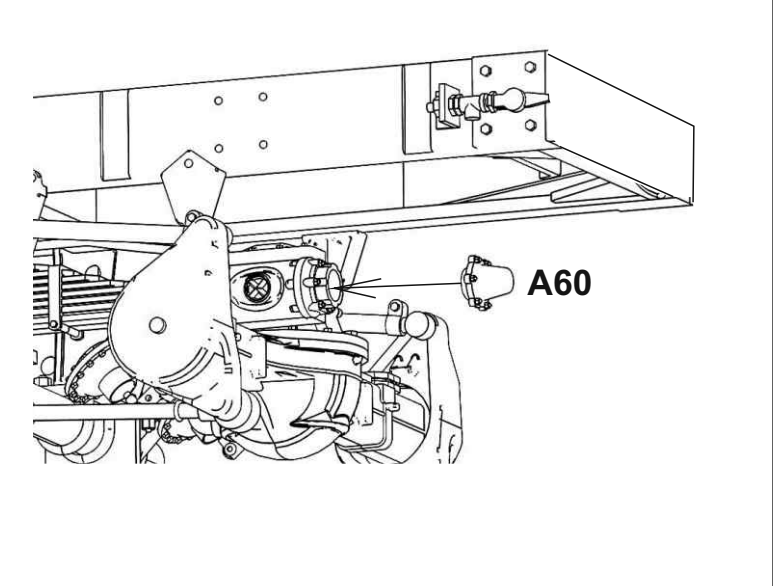
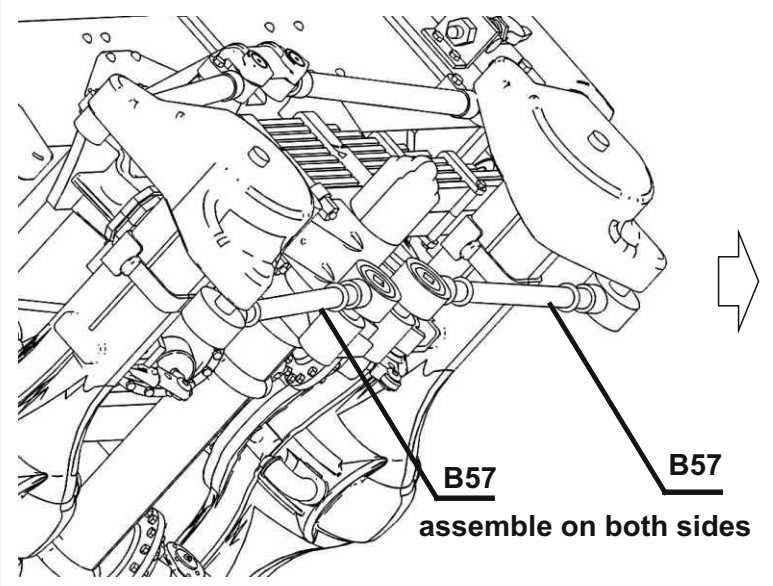
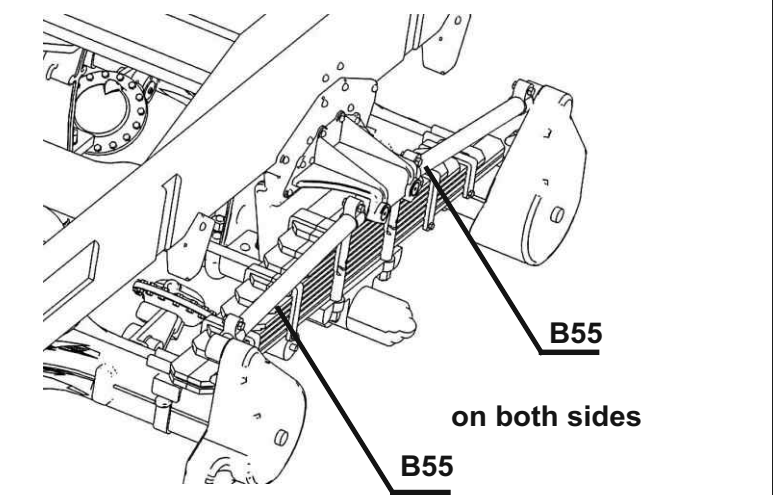
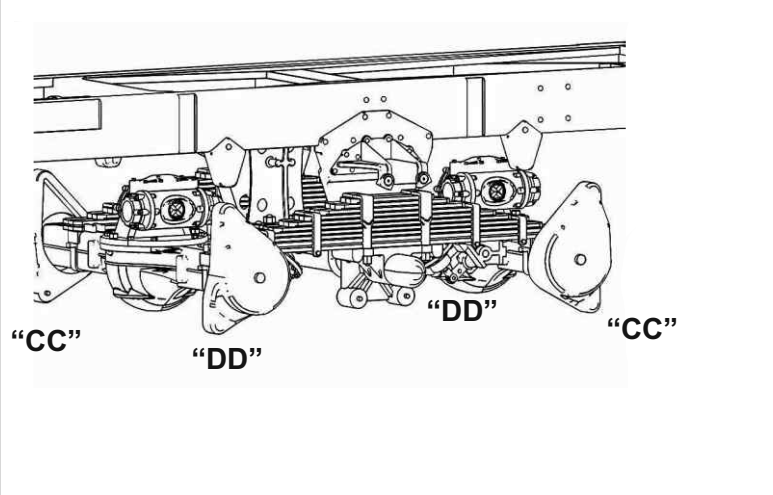
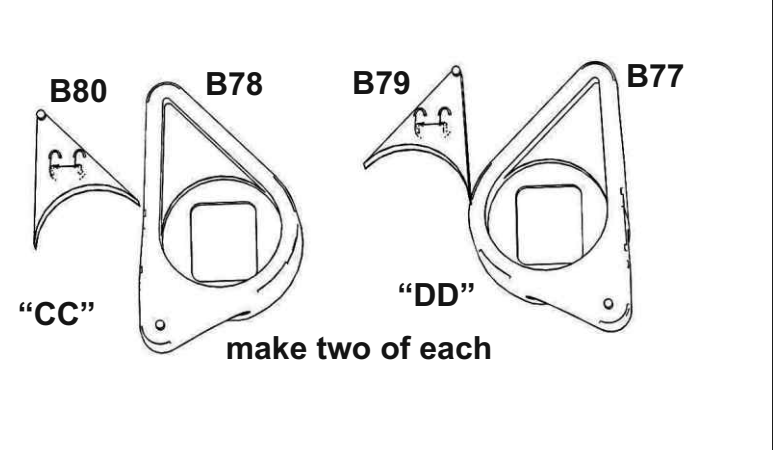
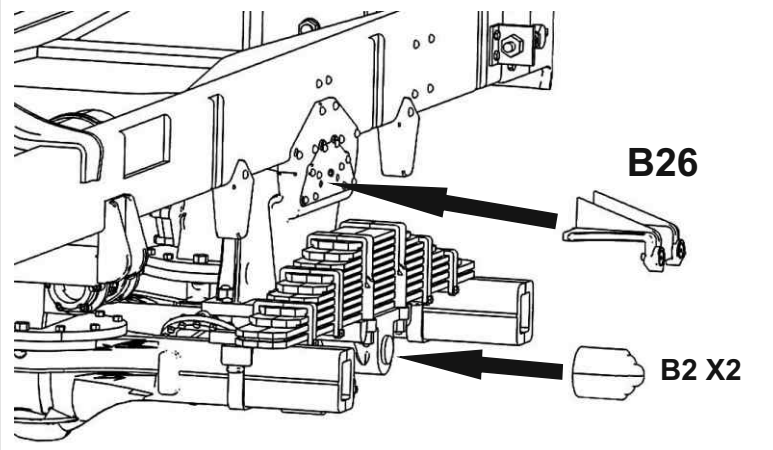



**“GG”**

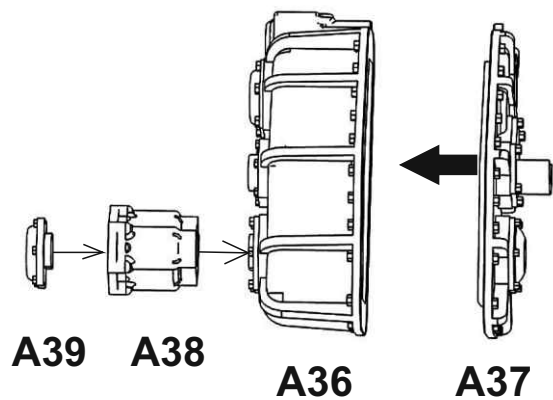

**“HH”**

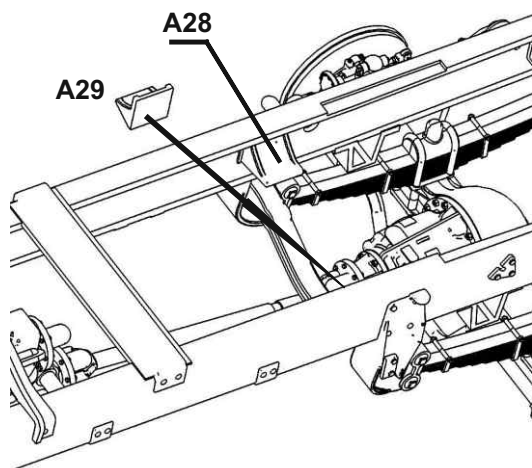
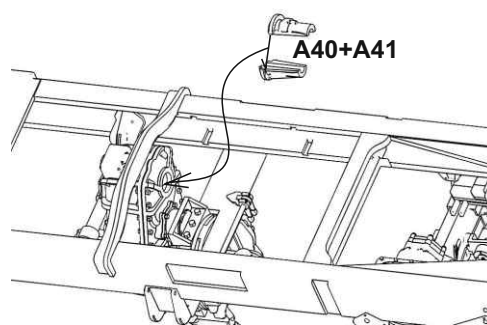
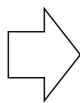
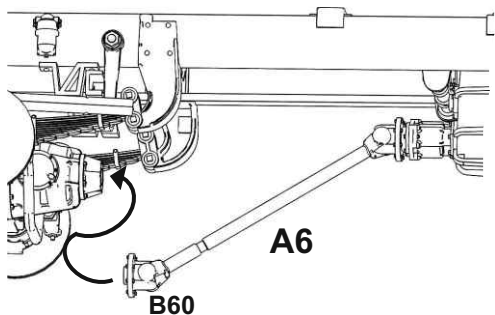
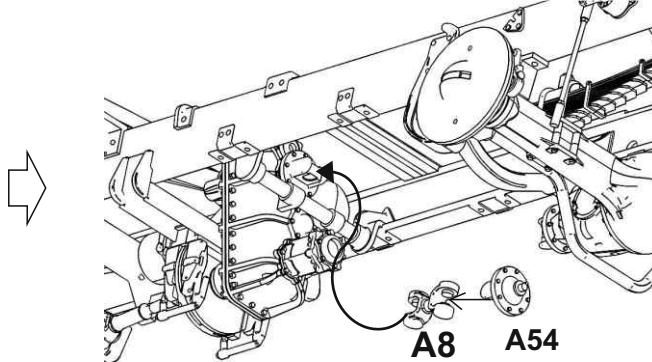
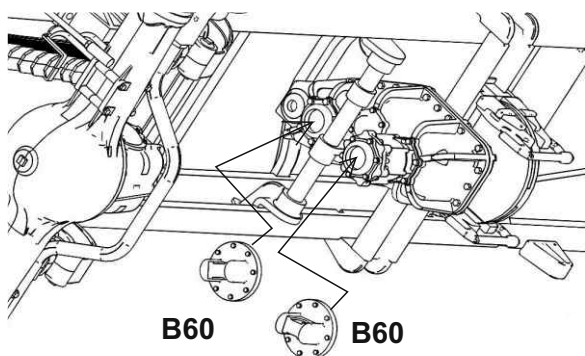
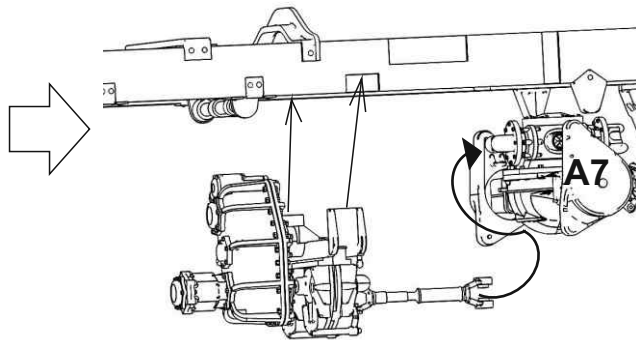
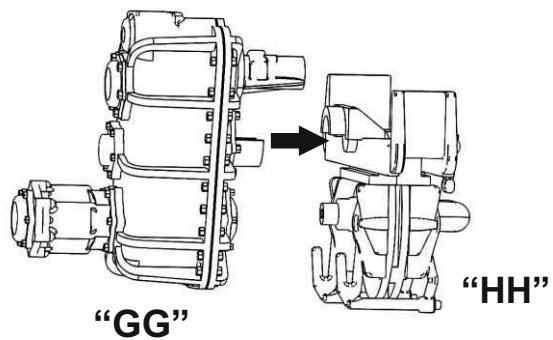
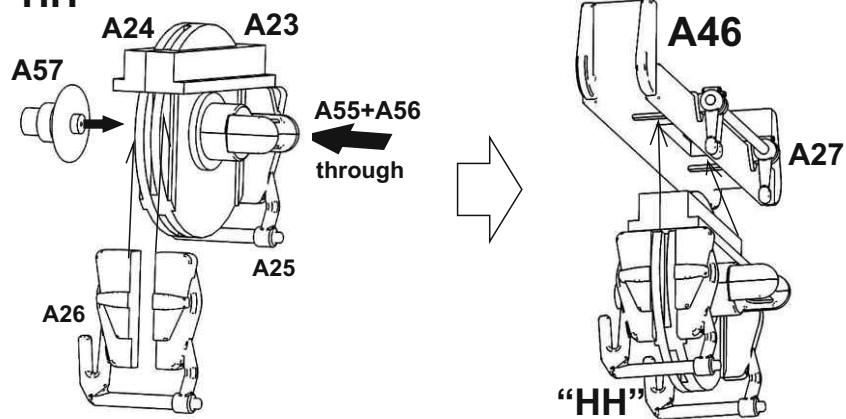

Fit engine at the back first, let it down - if needed, move engine crossbeam A43 slightly front or back and once fitted glue engine and also A43 in position

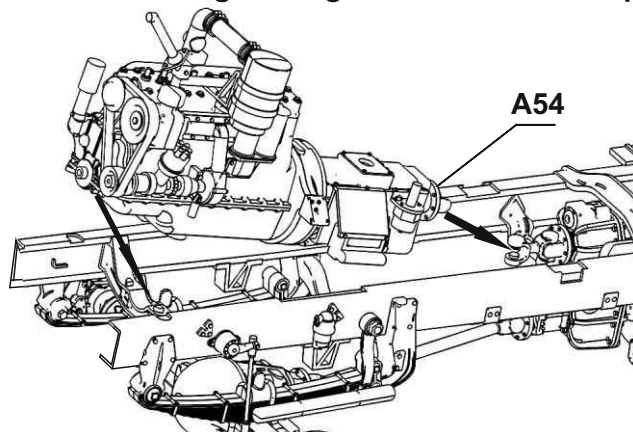

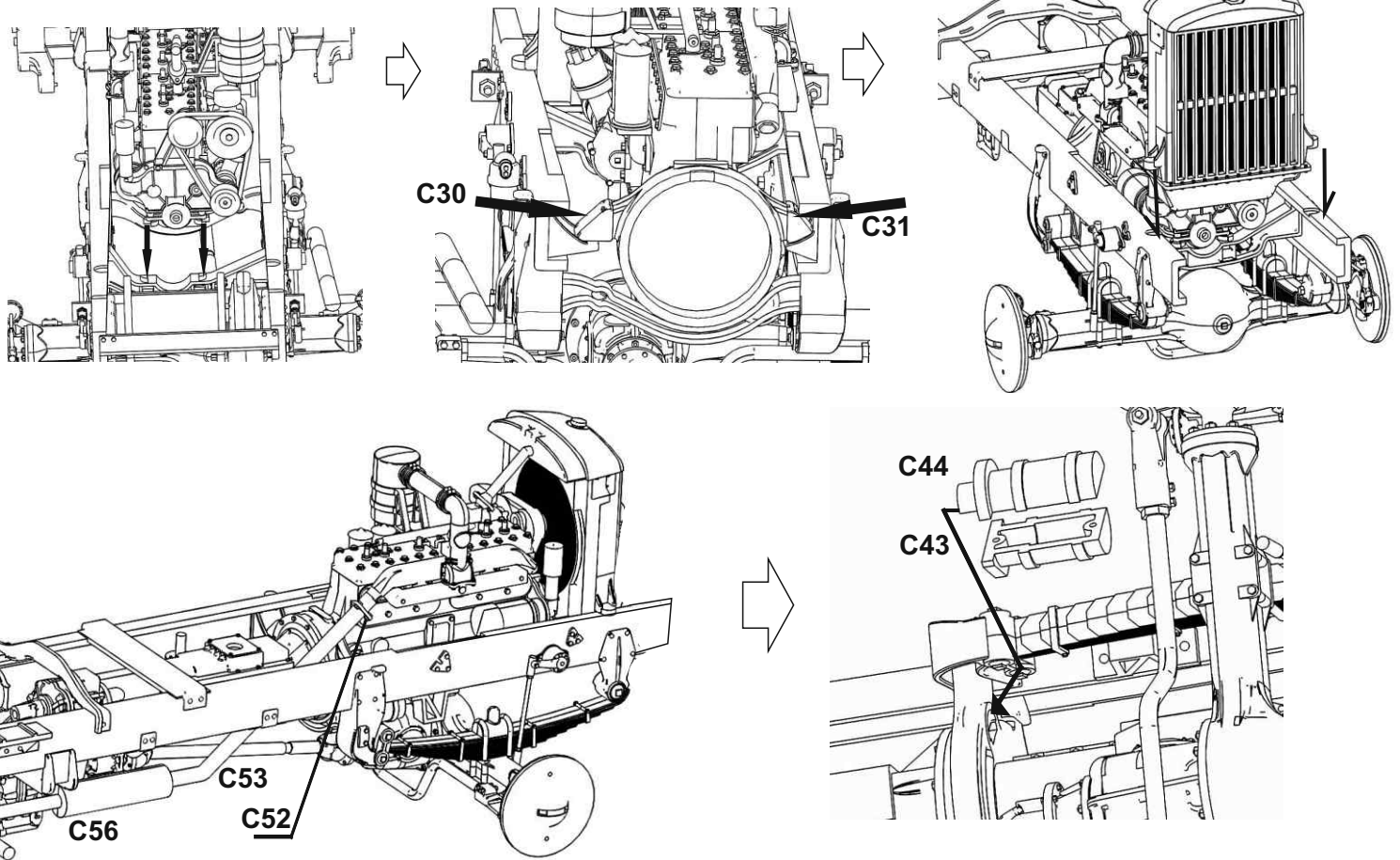

## CAB

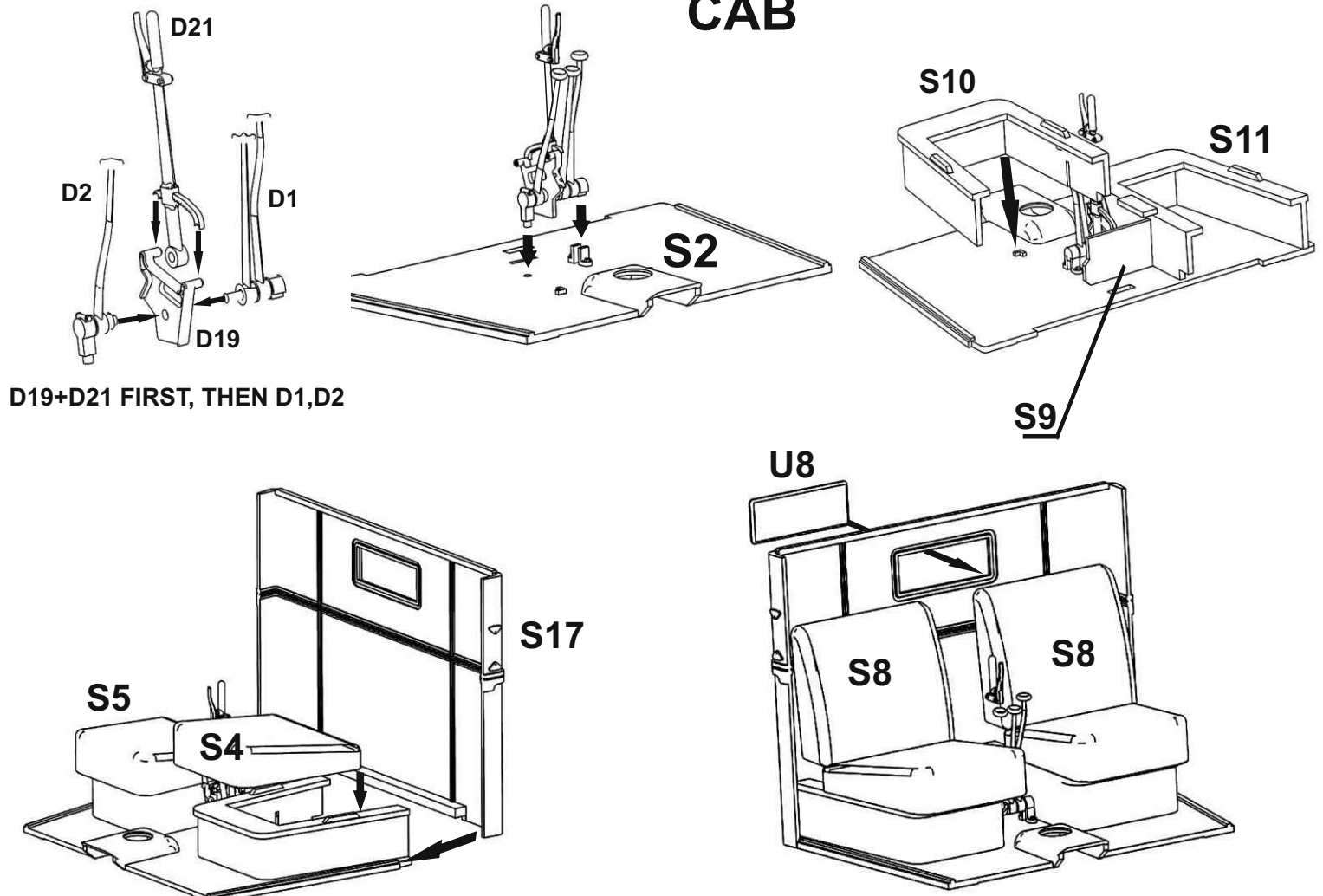

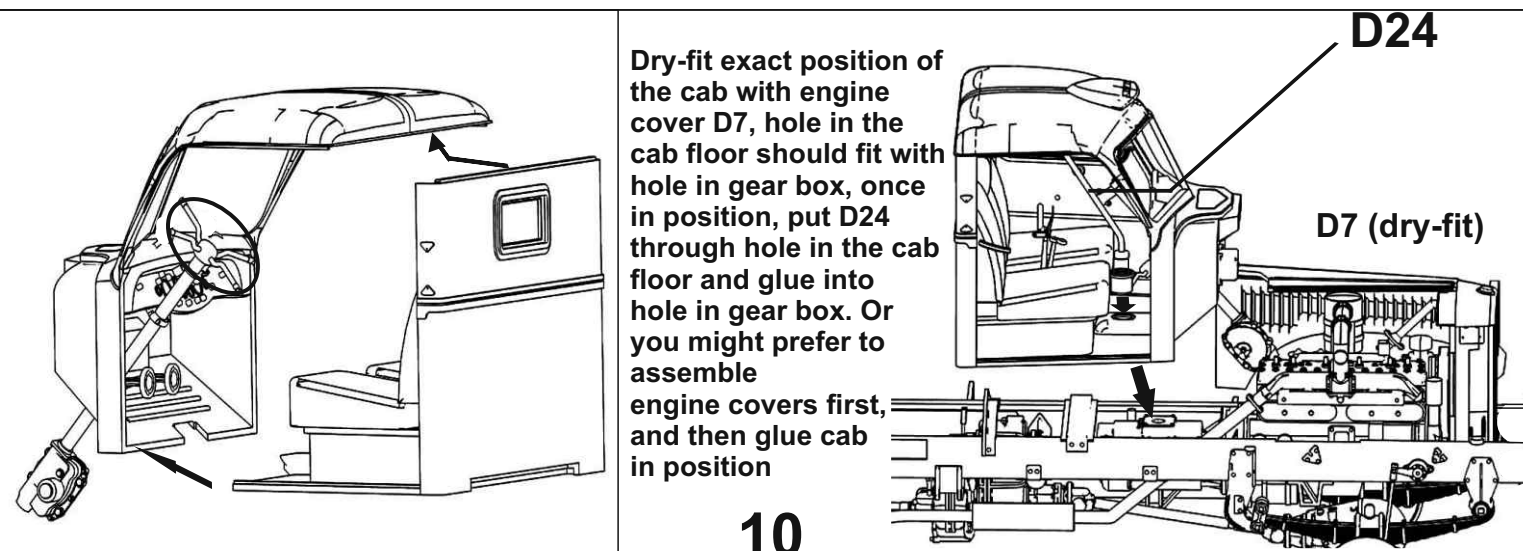
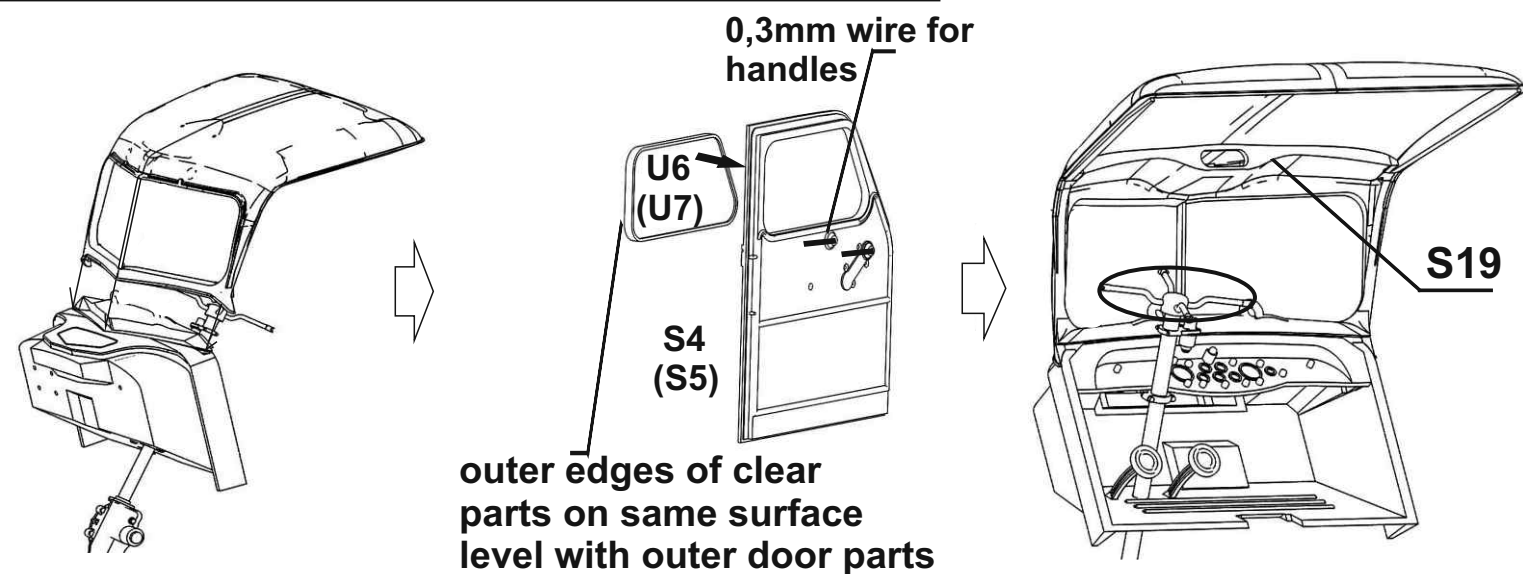
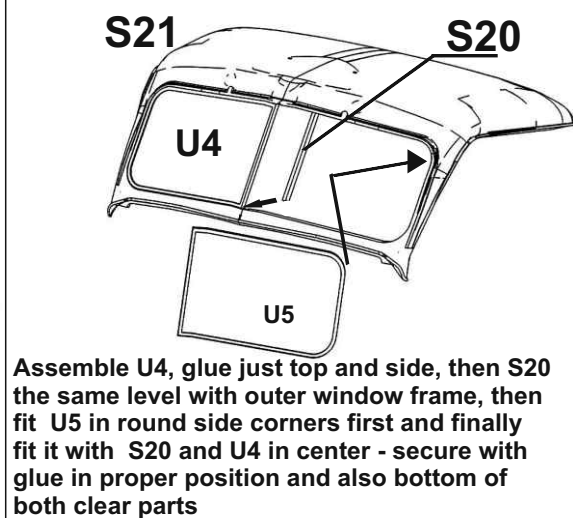
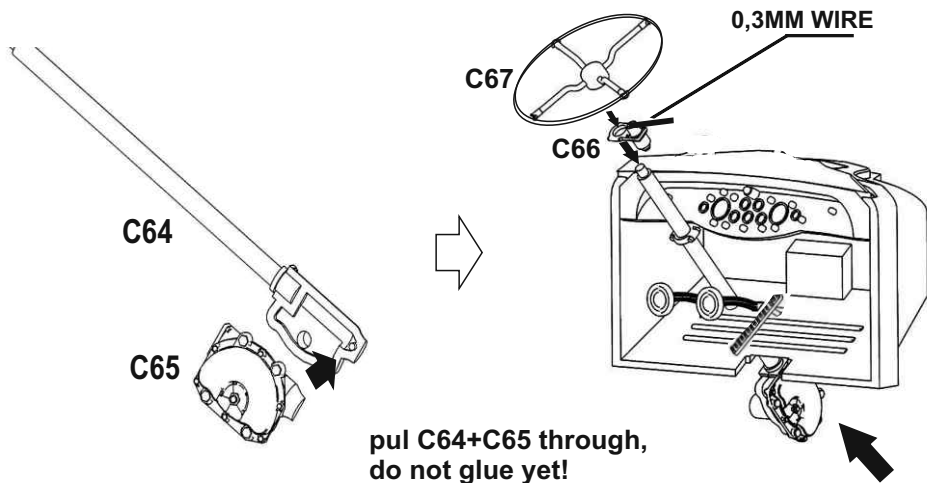
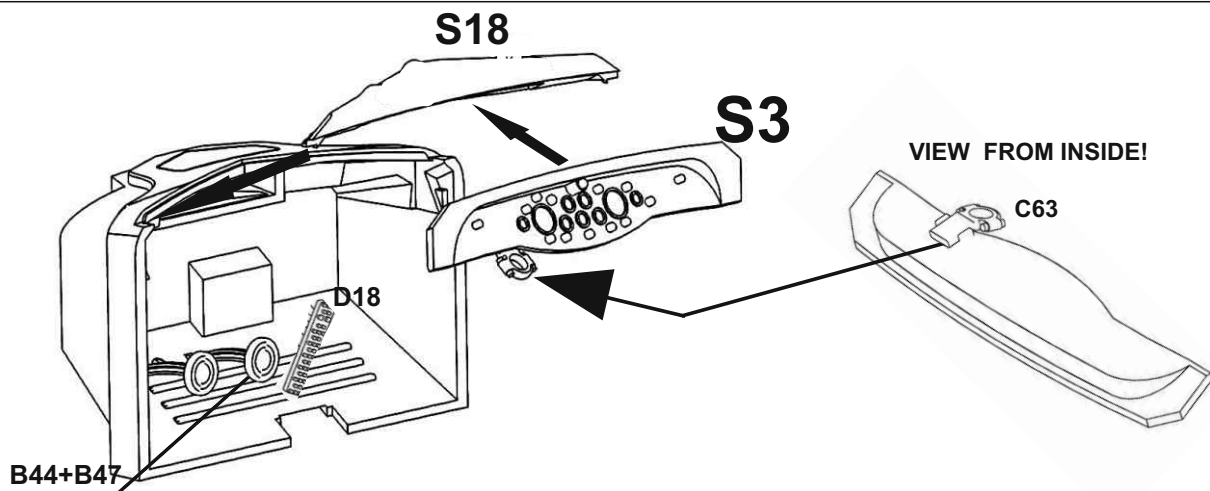
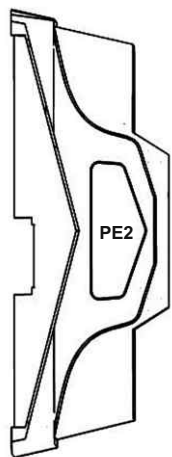

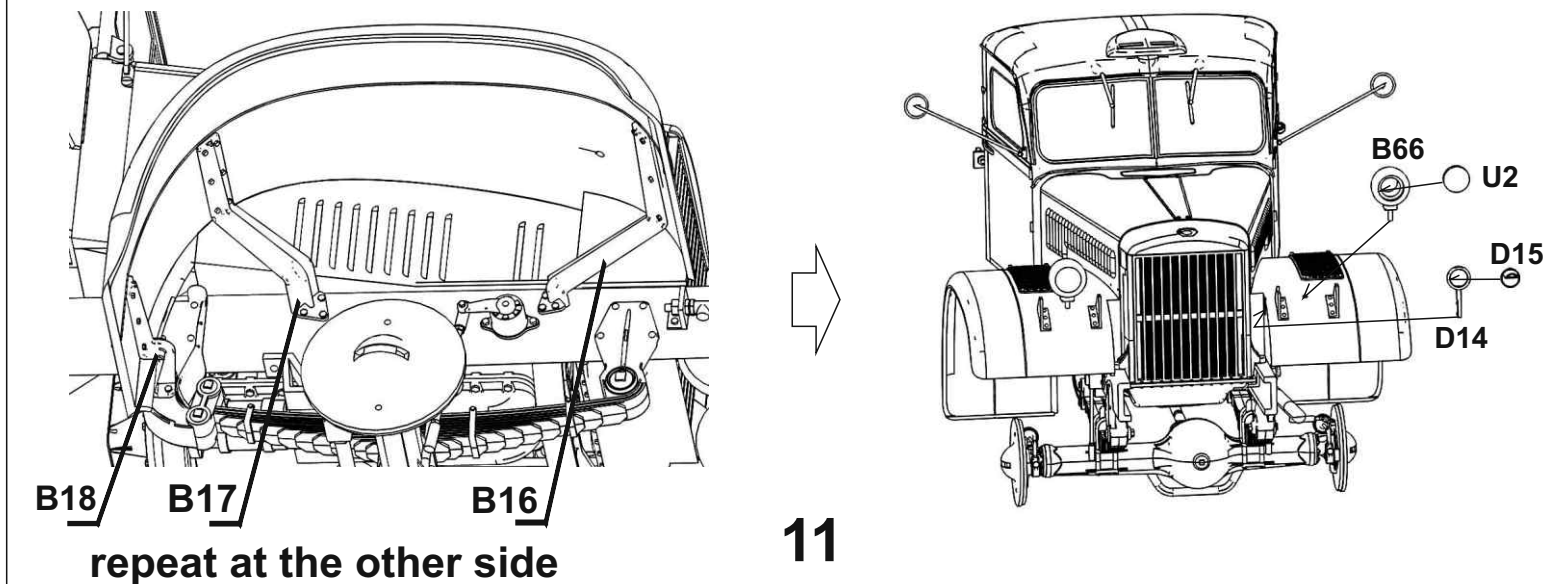
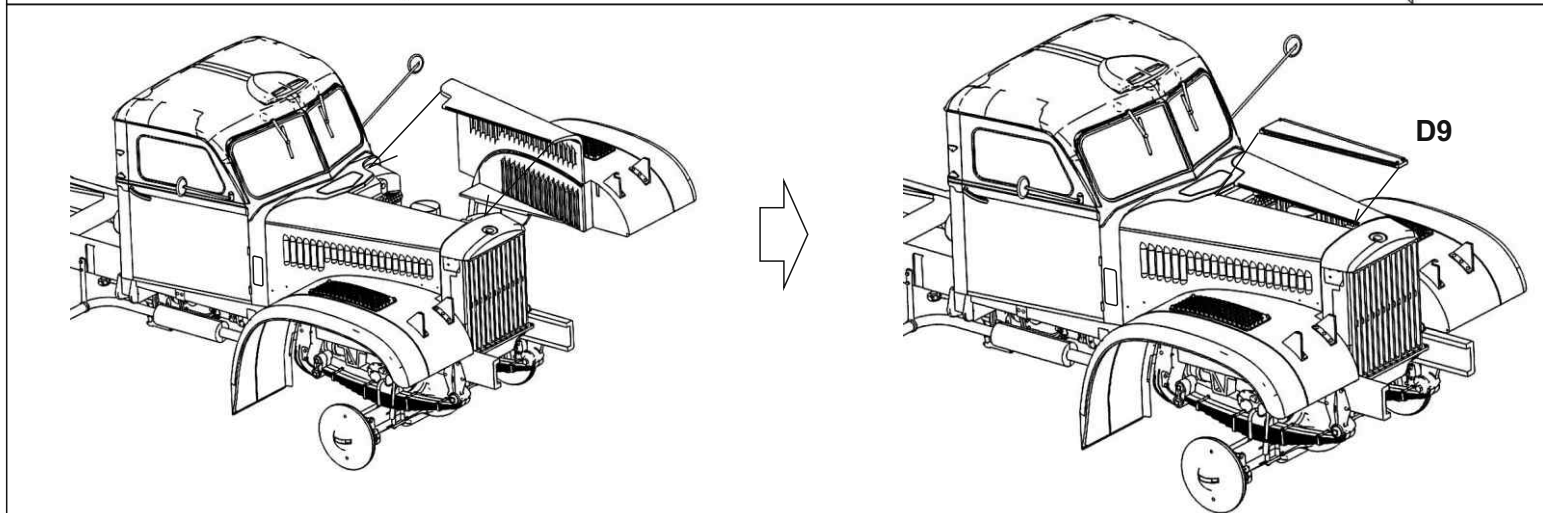
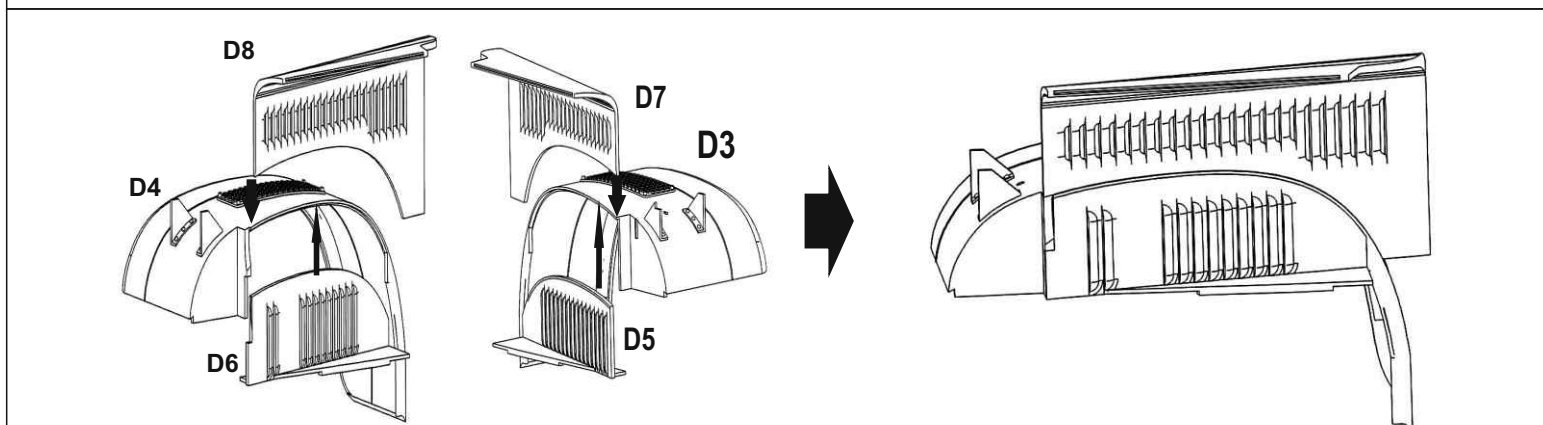
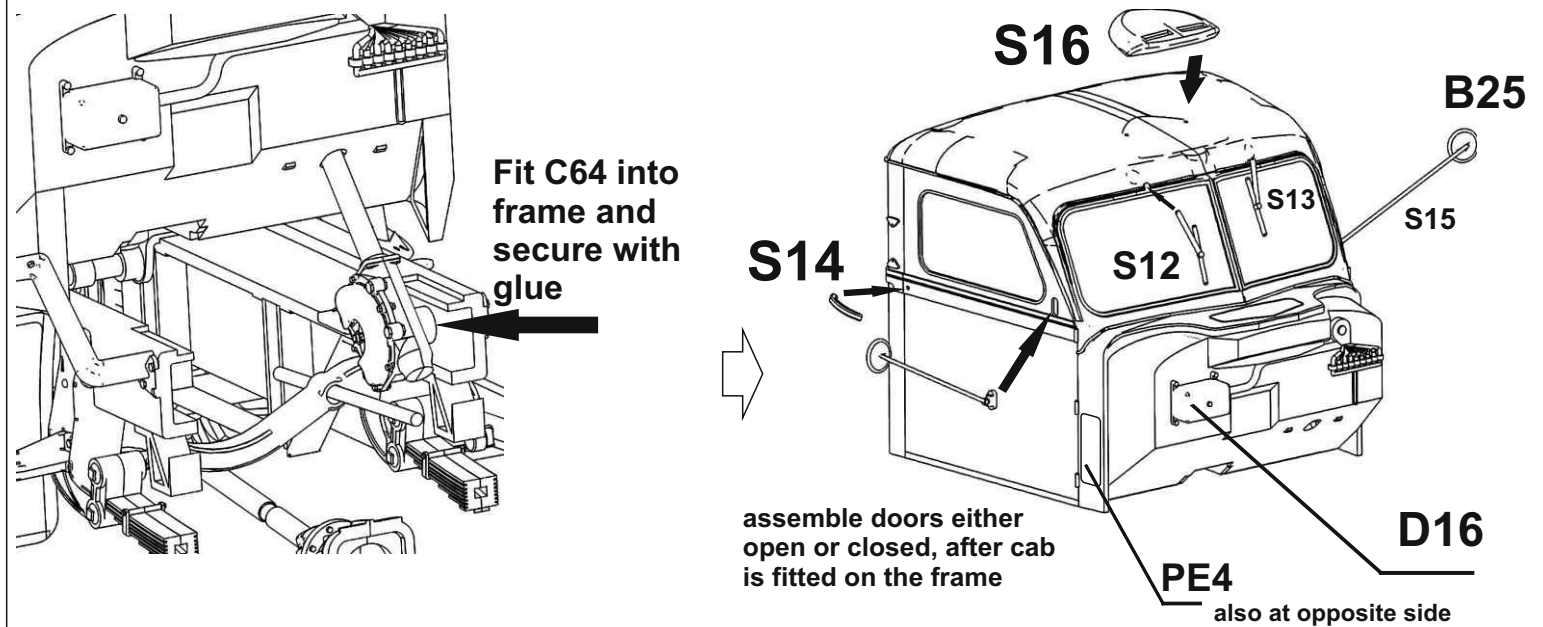

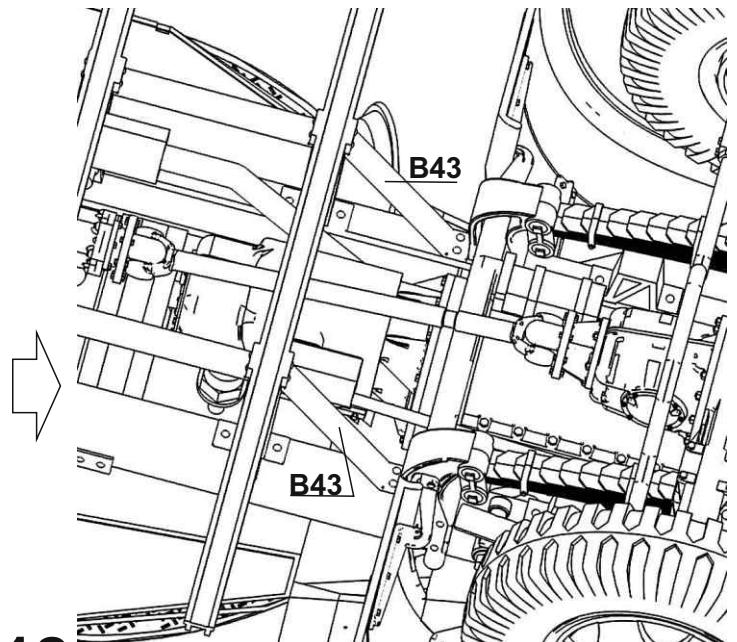
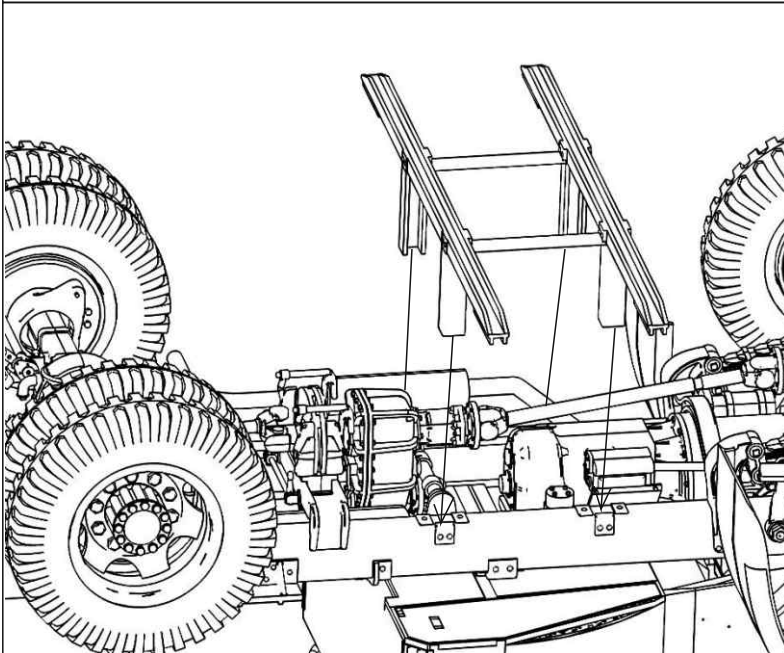
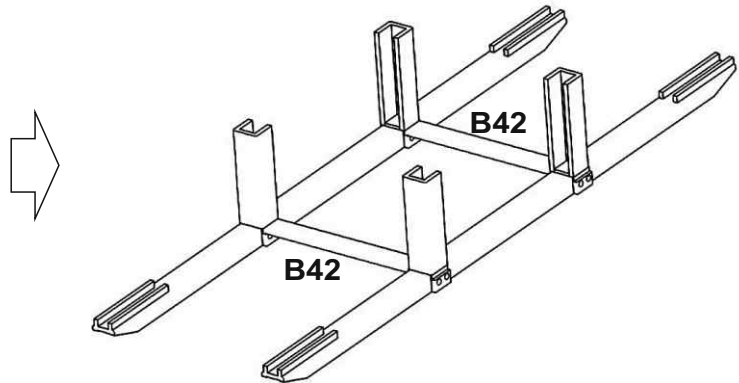
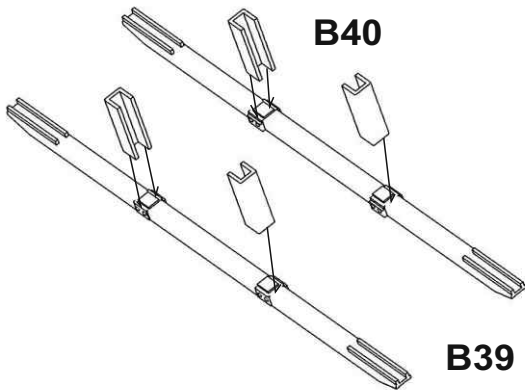
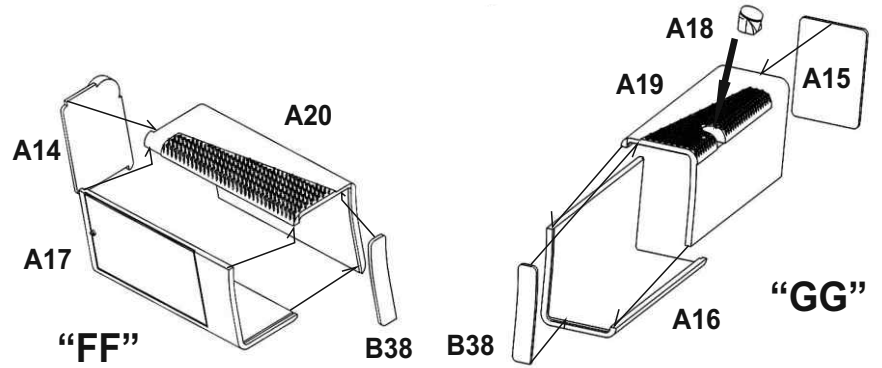
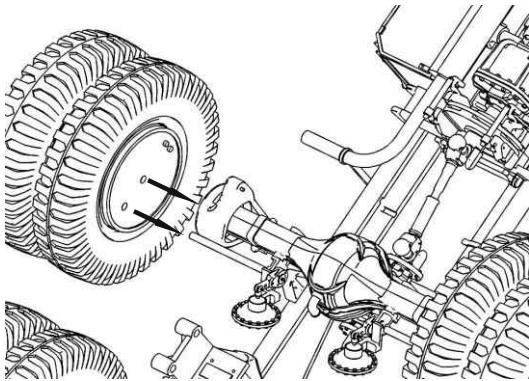
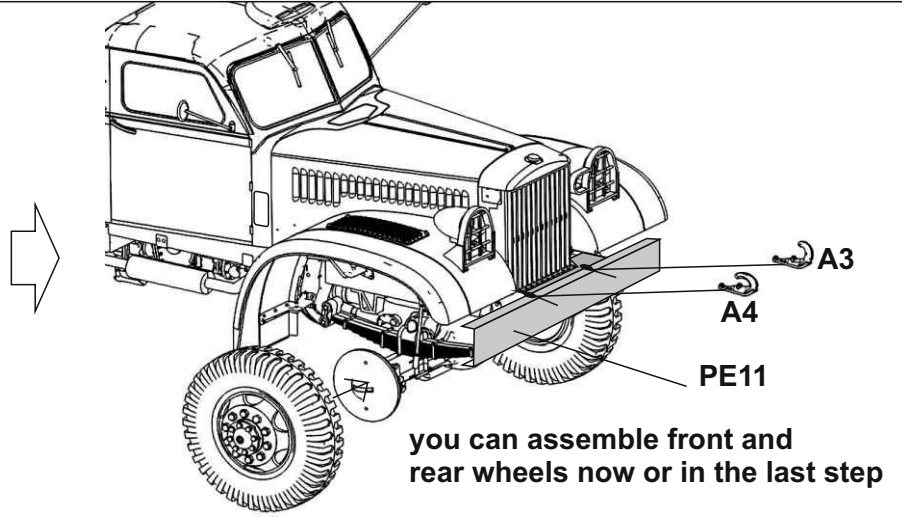
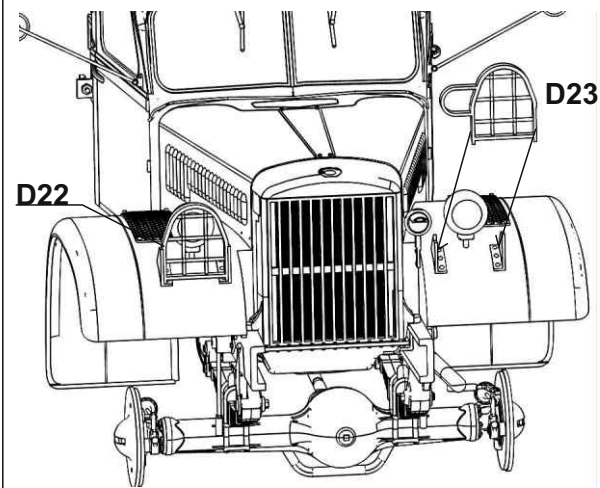



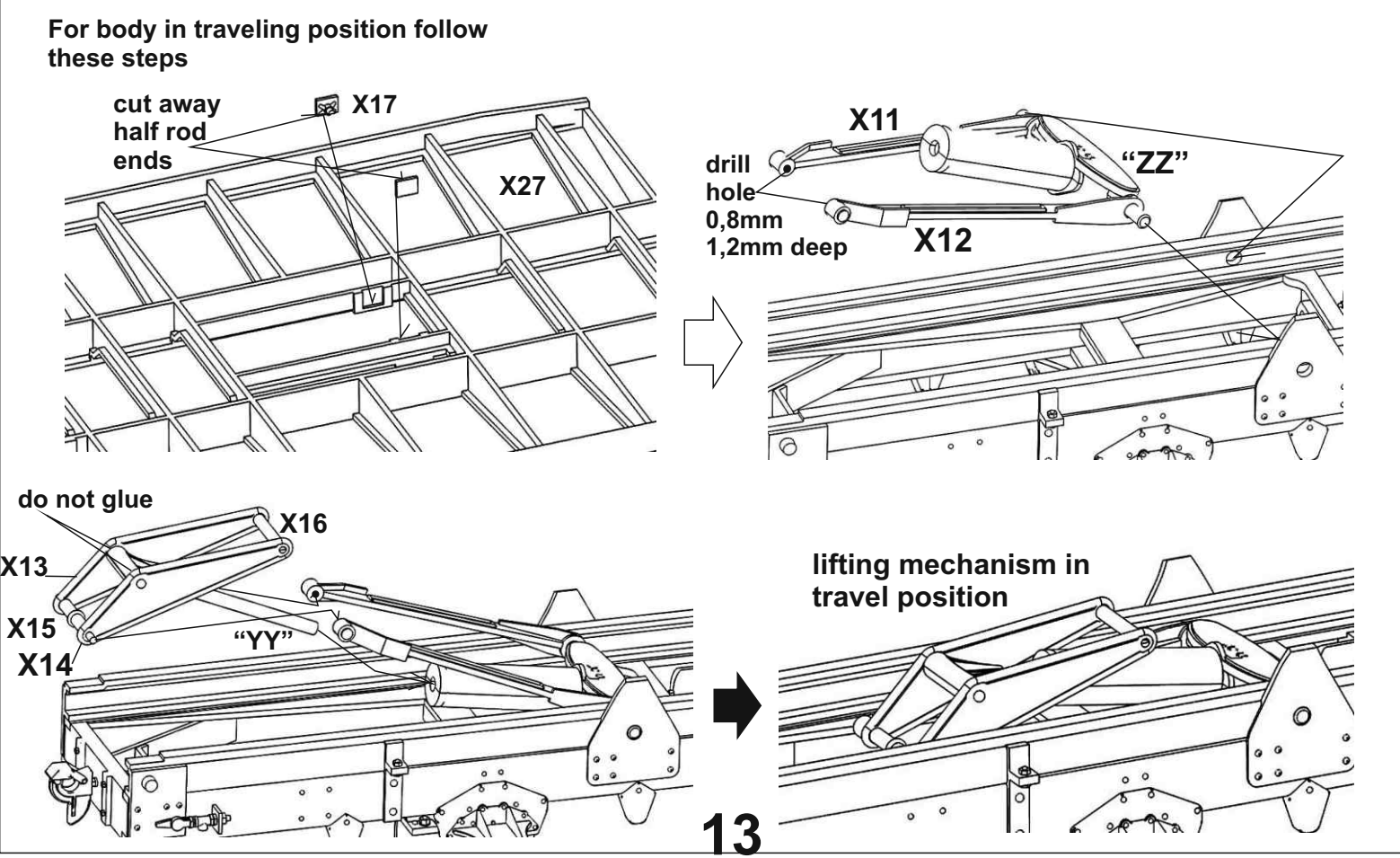
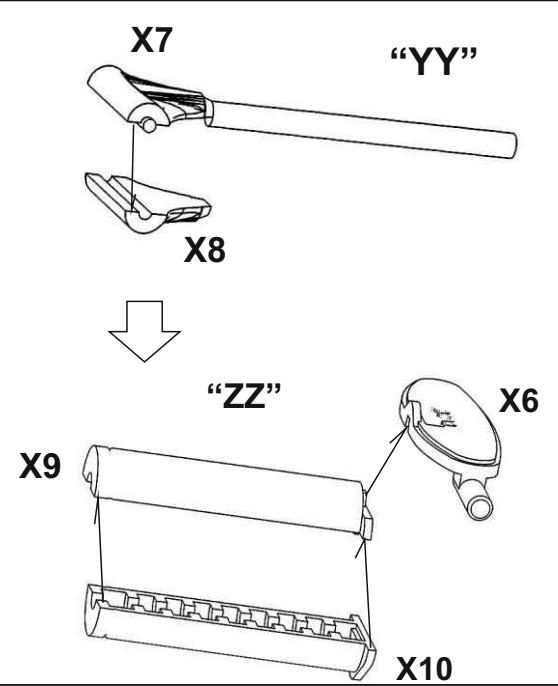
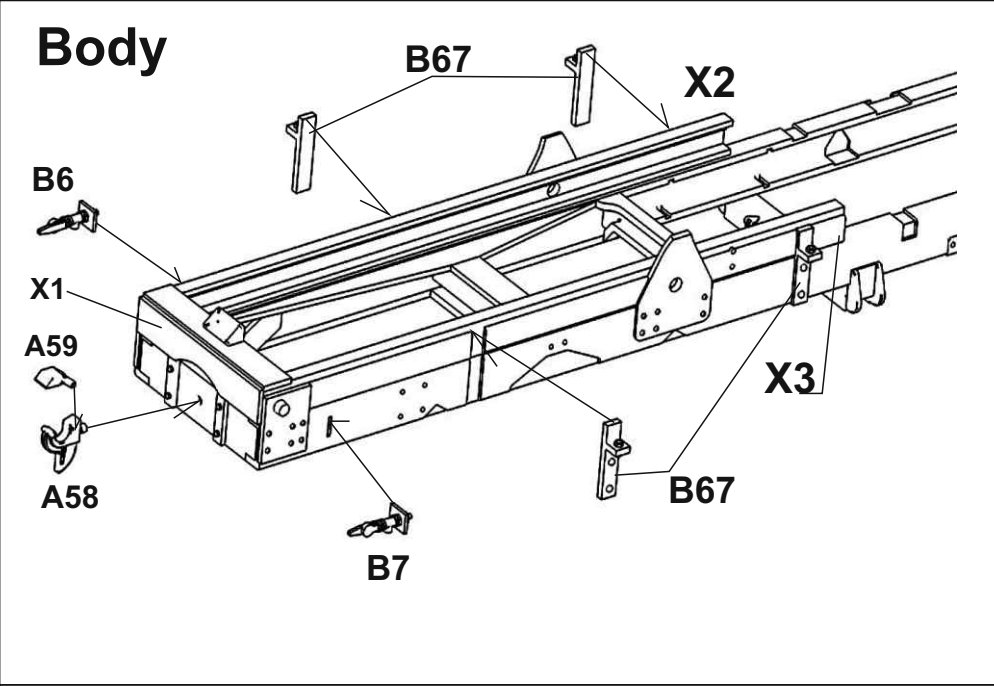
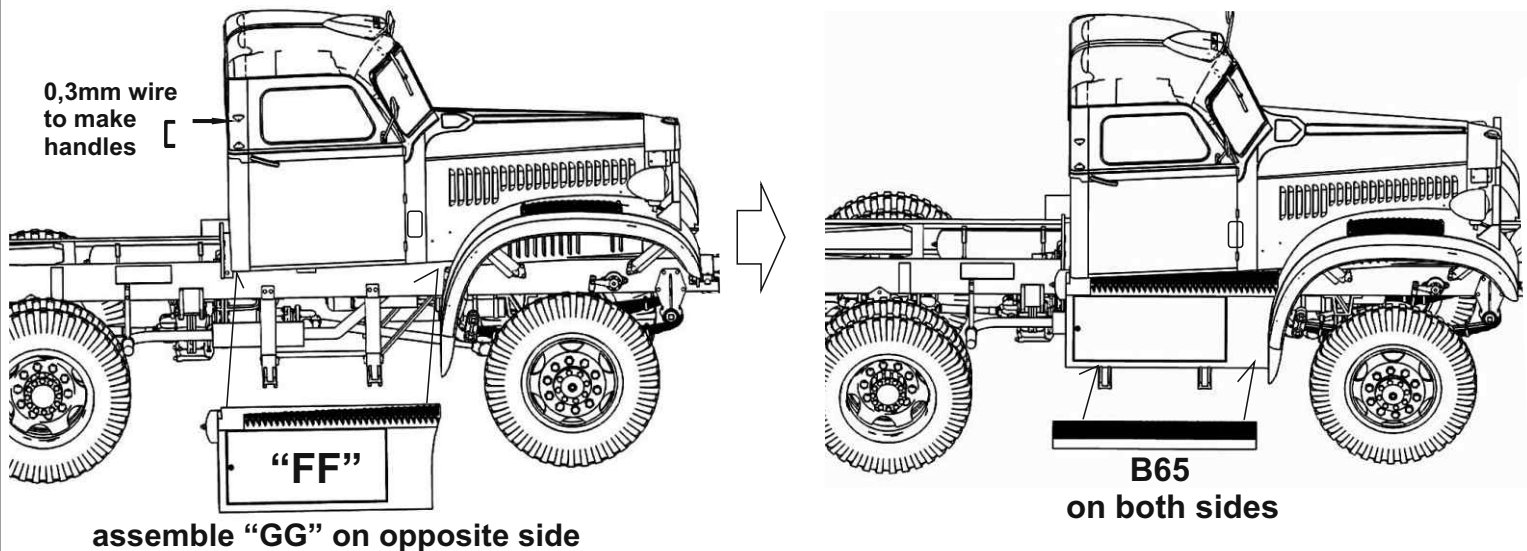

for lifted body  
follow this  
step

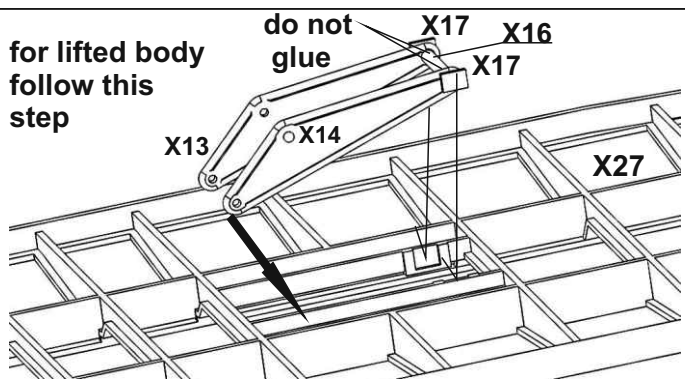

for body lifted insert both X17 into X13 and X14  
do not glue, pull arms through opening in X27,  
while you put both X17 in slots as shown, secure  
with glue, arms are movable

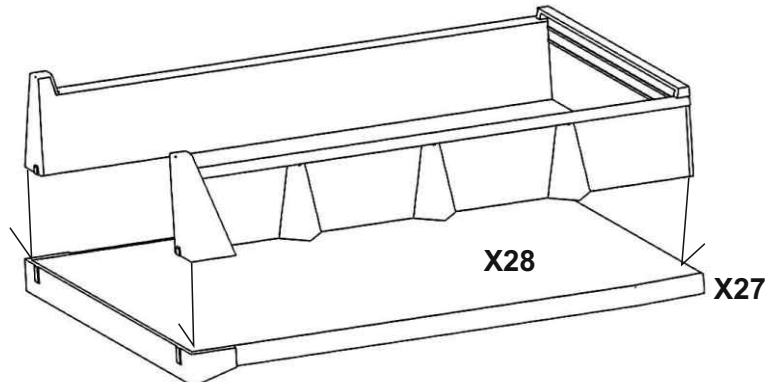

continue with body assembly

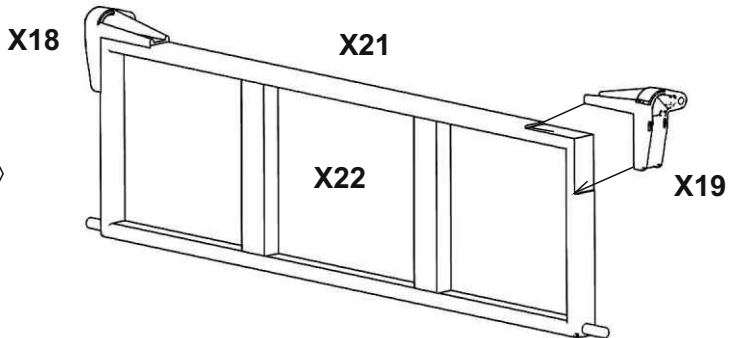
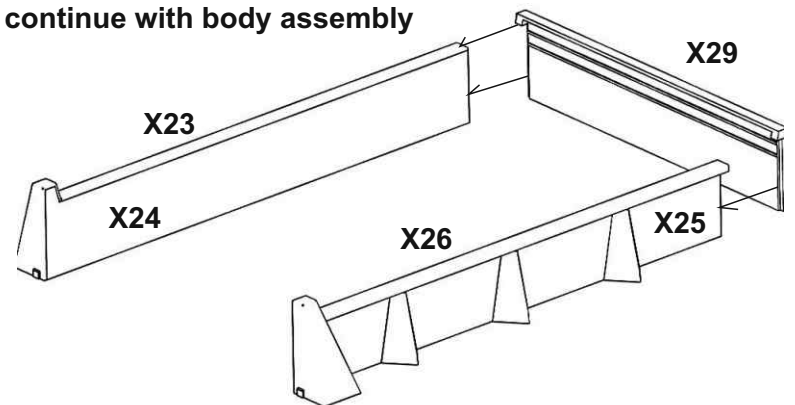

back can open (lifted) or close (traveling)

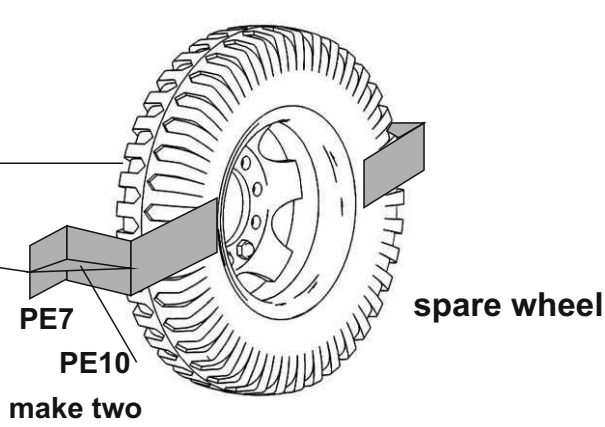
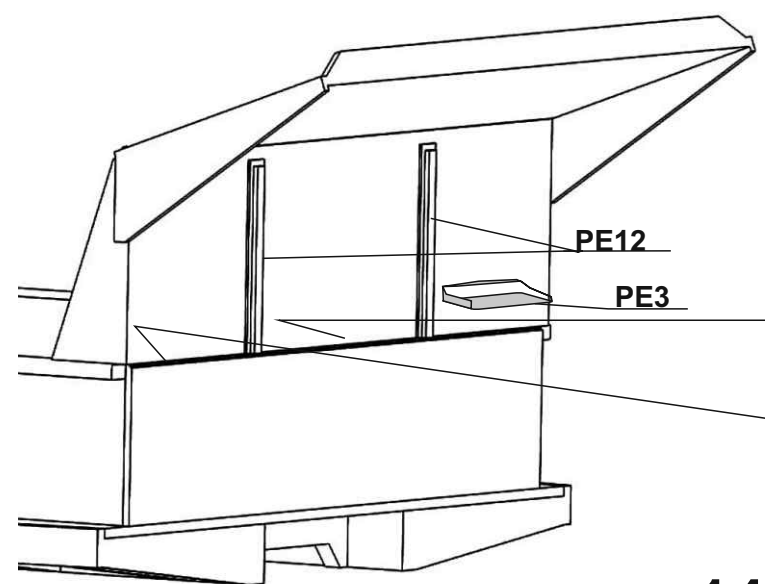
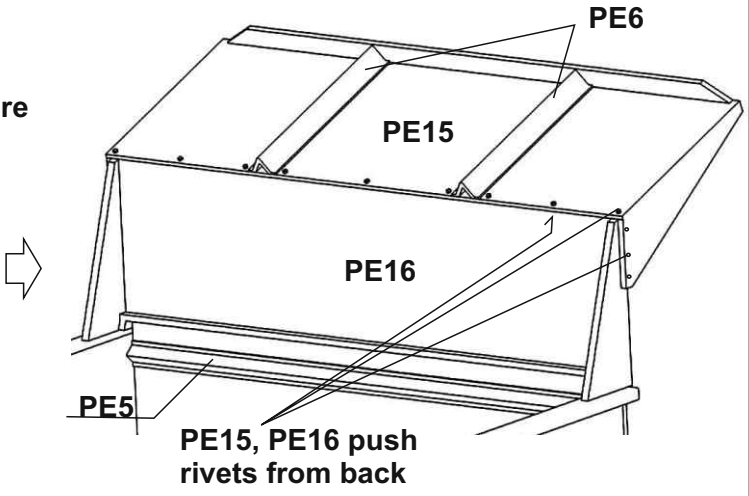
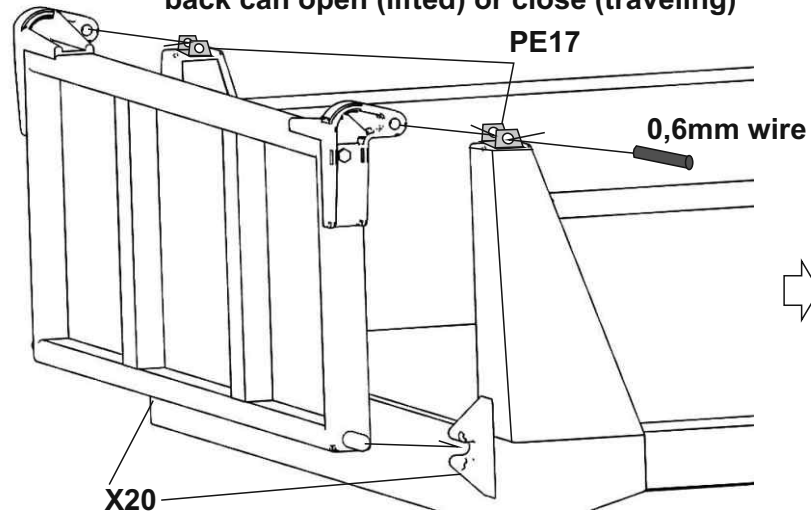

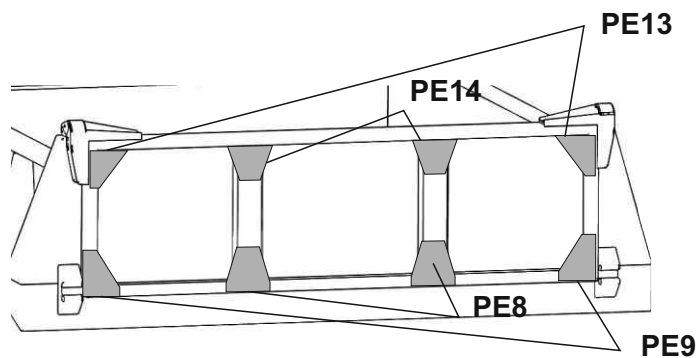

body traveling position

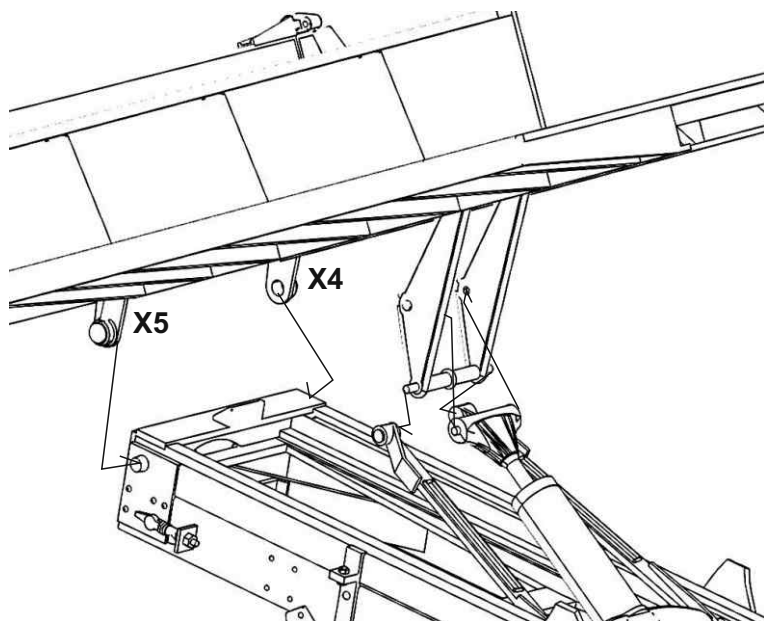
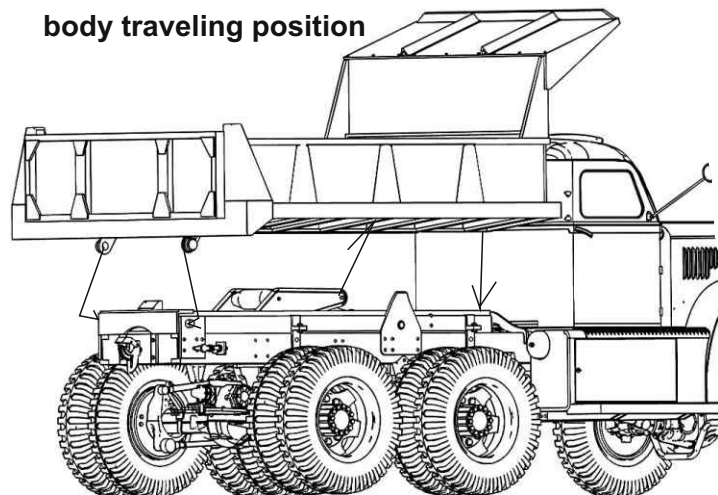

body in lifted position

angle of body has to correspond with angle of arms X13, X14

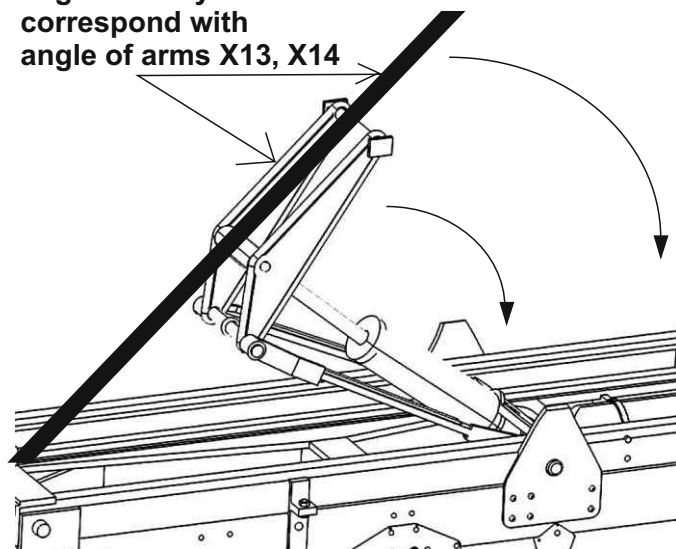

## dashboard decal placing

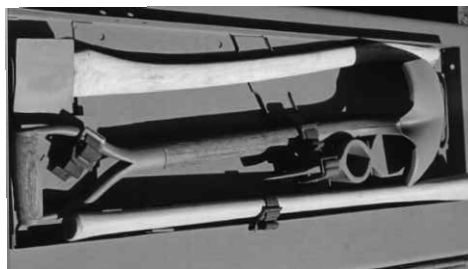
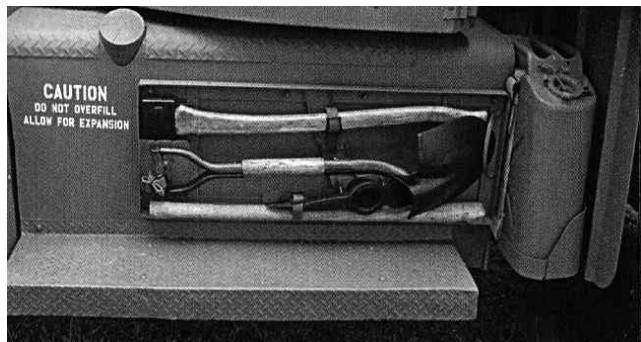

Some trucks had a tool set in the tray mounted on fuel tank, PE and plastic parts for this option are supplied with the kit

B32,B33  
B34, B59 - tool parts, PE7 - tray + PE belts

If you have experienced missing or damaged part, contact us directly for replacement at [info@mirror-models.com](mailto:info@mirror-models.com)  
Additional PE detail set (to replace various kit plastic parts with true to scale sheet metal), upgrade resin wheels and much more available from LZ Models at [www.LZmodels.com](http://www.LZmodels.com)