

CMP C60S Holmes Wrecker cab 13



35164

Assembly instructions

Assembly guide

The Canadian Military Pattern truck was a class of military truck made in large numbers in Canada during World War II to British Army specifications for use in the armies of the British Commonwealth allies. Standard designs were drawn up just before the beginning of the war. CMP trucks were also sent to the Soviet Union following the Nazi invasion of Russia, as part of Canada's lend-lease program to the Allies. During the War CMP trucks saw service around the world in the North African Campaign, the Allied invasion of Sicily, the Italian Campaign, the Russian Front, the Burma Campaign, the Battle of the Philippines (1941-42), the liberation of Northwest Europe, and the Western Allied invasion of Germany. CMP trucks also saw service in post-war conflicts in Indonesia, French Indochina, and the Portuguese colonies in Africa. Most CMP trucks were manufactured by the Chevrolet division of General Motors of Canada Ltd and by the Ford Motor Company of Canada. Just over 400,000 CMP trucks were manufactured in Canada, accounting for roughly half of the 815,729 military vehicles made in Canada during World War II. Chevrolet-built CMP trucks had a 215 cu in (3.5 L), 85 bhp (63.4 kW) straight-6 overhead-valve engine. Cab design changed twice, first designed at Ford, second and third cab designs - called No. 11, 12 and 13. First two type were similar, the main difference being a two-part radiator grille in No.12 cab, its upper part was opened with a bonnet, which was known as the "Alligator cab". The production of CMP truck bodies in Canada was subcontracted out to smaller companies in Ontario and Manitoba, organized into the wartime Steel Body Manufacturers Association by the Department of Munitions and Supply. The wide variety of truck body designs included general service, water tanker, fuel tanker, vehicle recovery, dental clinic, mobile laundry, wireless house, machinery, folding boat transport, and anti-tank gun portee

Go through assembly guide before you start your work. We recommend to use a sharp scalpel and razor blade to remove parts carefully.

Heat up PE parts with lighter before use, brass will soften and become easy to bend and work with
Tamiya Super Thin Glue recommended for plastic parts, let the glue work for a few seconds, then push parts together, melted plastic will fill the gaps between parts. You can also melt sprue frame and use it as an amazing filler for small works, or use this glue to wash out tiny seam lines on little parts or make texture on some parts etc. You might need to adjust some holes with drilling bits

Part list: Sprue A, frame, partly used
Sprue C, clear parts
Sprue K wrecker parts, chassis parts
Sprue X wrecker parts
Sprue Yx2 wrecker parts
Sprue E, various parts, partly used
Sprue F x2, frame and chassis parts
Sprue W, chassis parts
Sprue X, axle parts
Sprue Y, cab 1 parts
Sprue Z, various parts, partly used, separate gearbox parts Z1, Z2
1x PE detail sheet, 5 resin wheels, wire, decal sheet

Make subassemblies

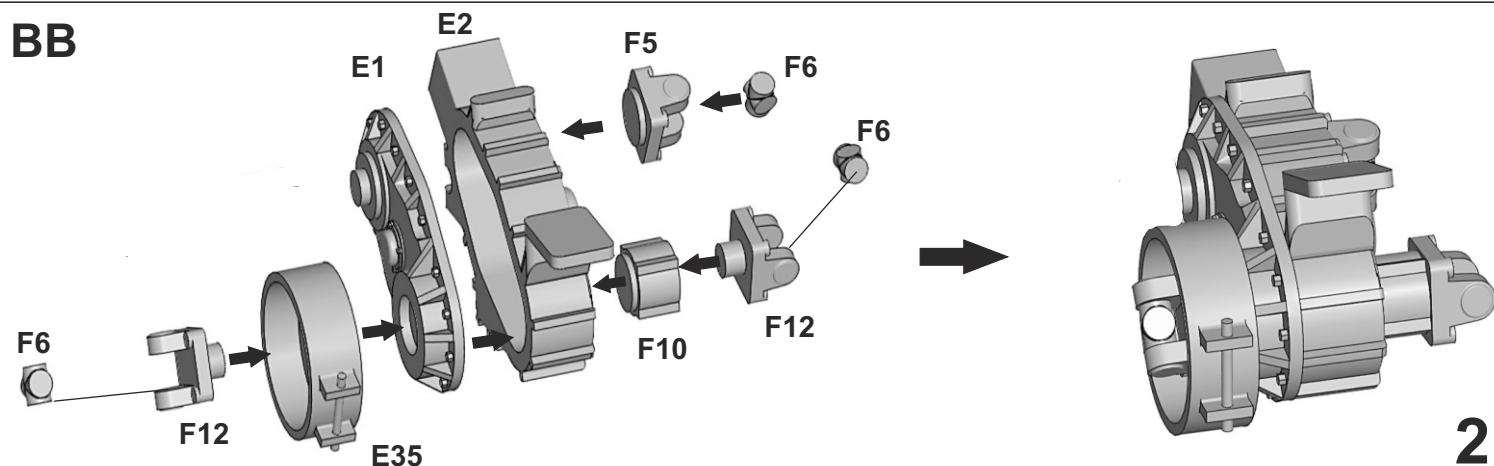
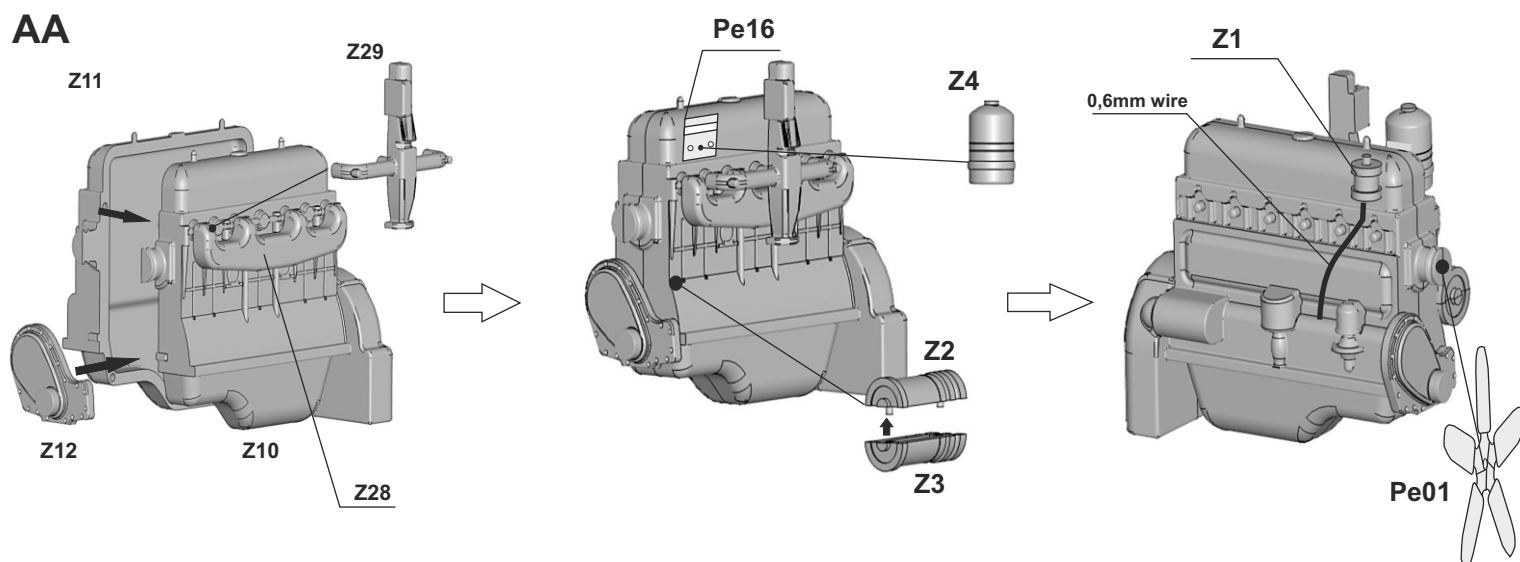

CC right

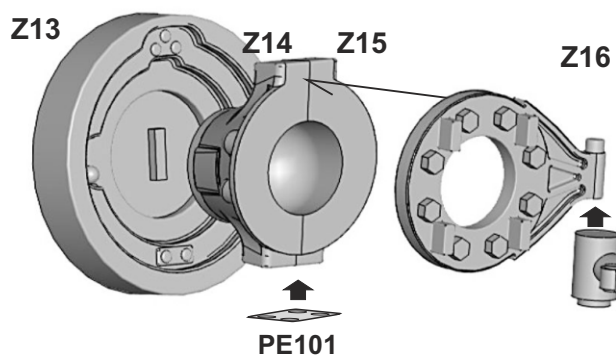

left

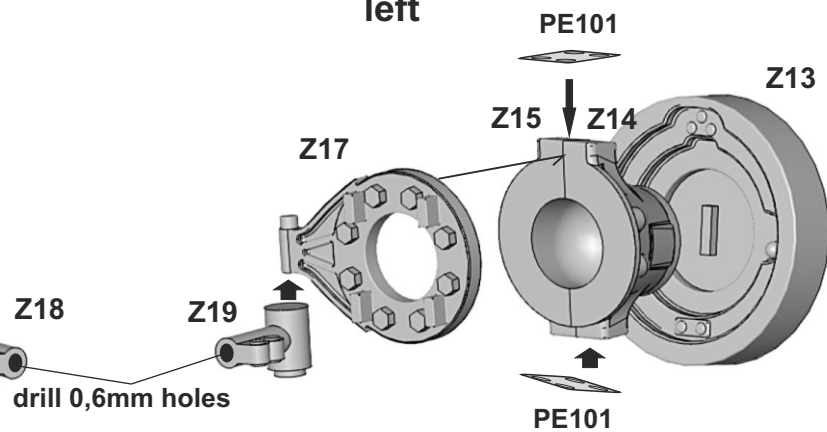

DD
left + right

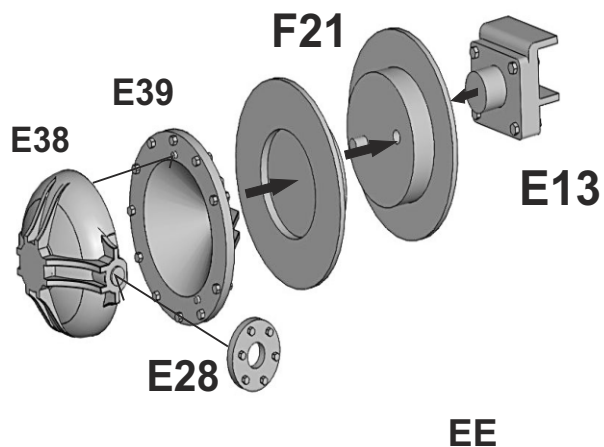
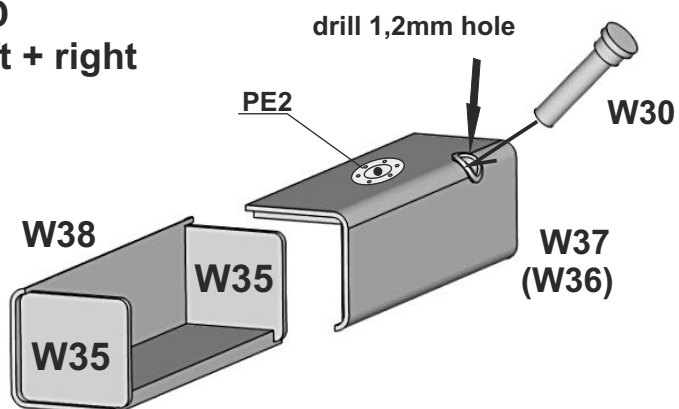

FF
make 2

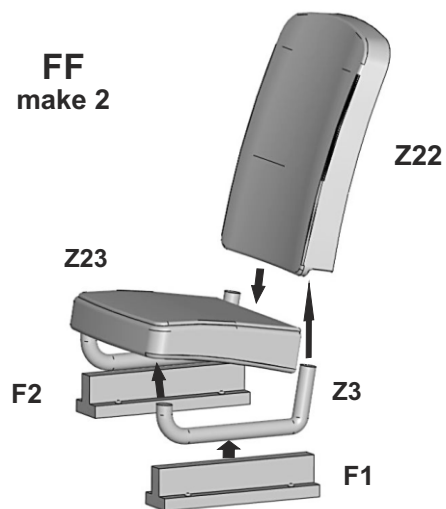

GG

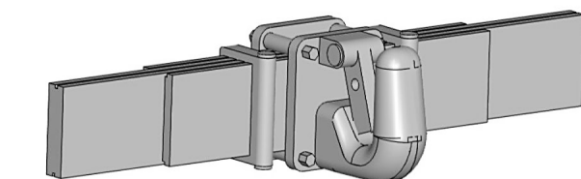
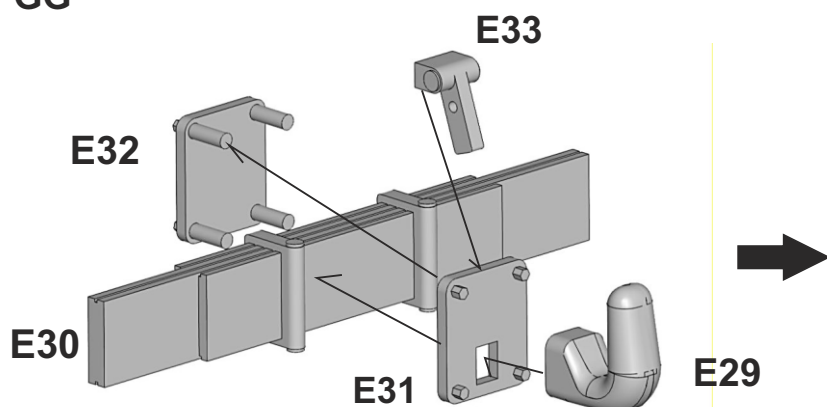

rear axle

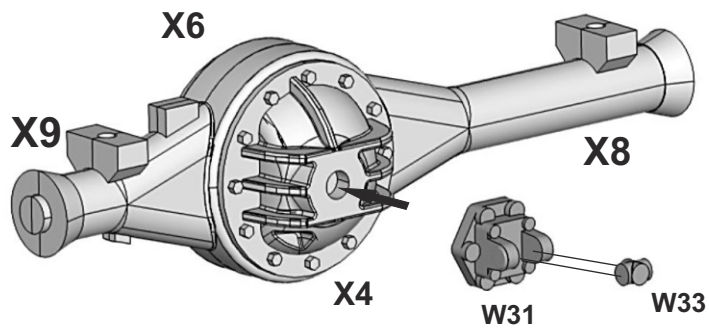

front axle

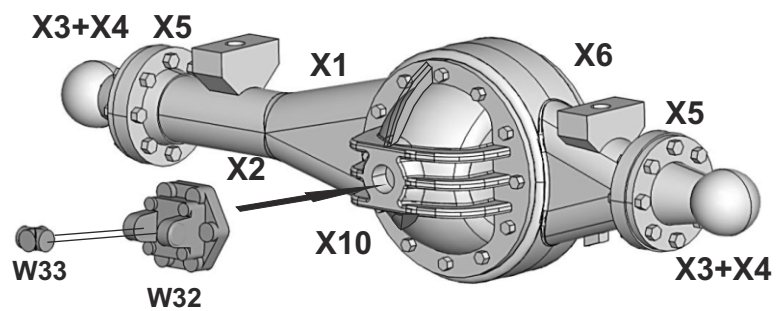

II

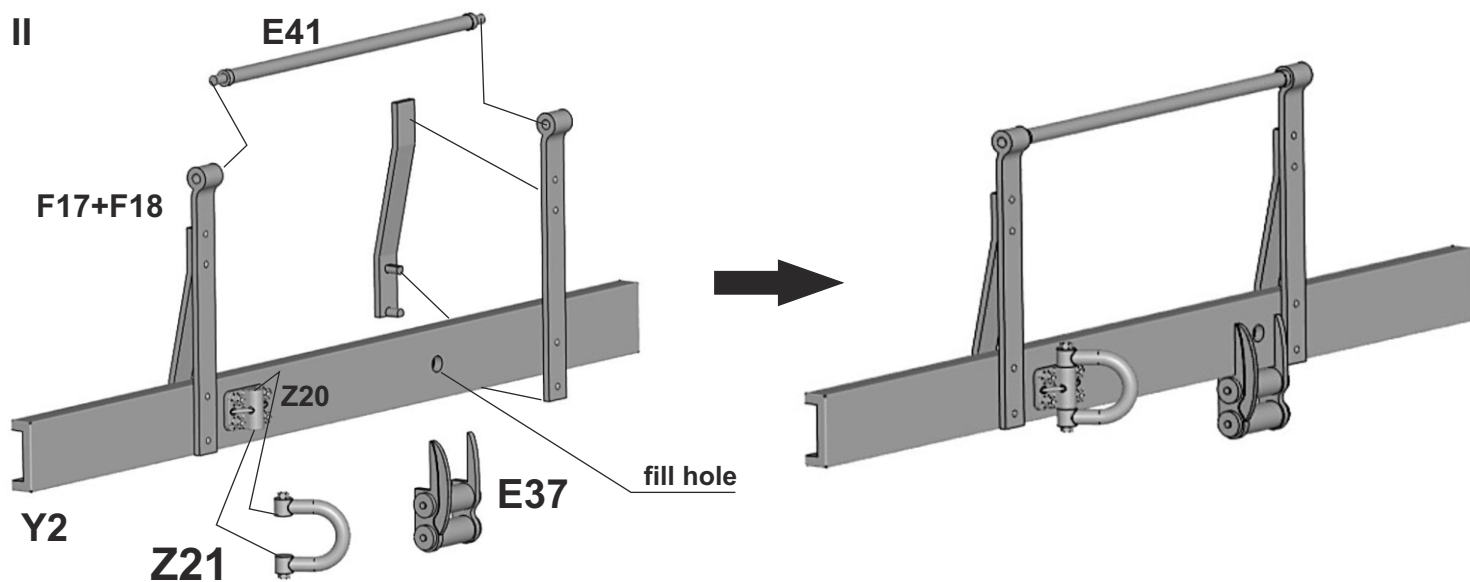

Frame assembly

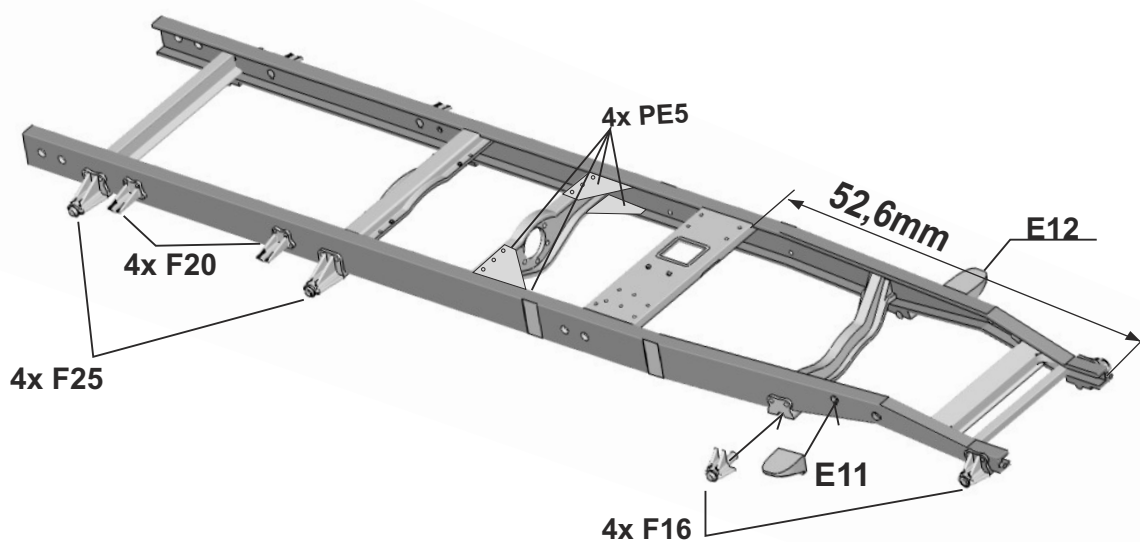
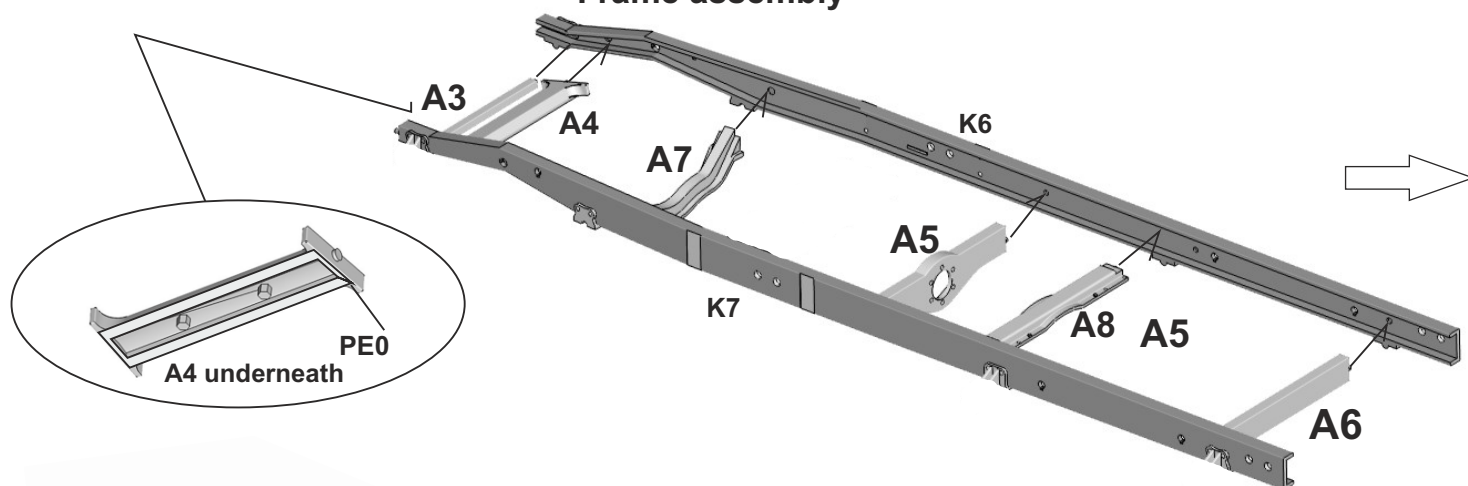

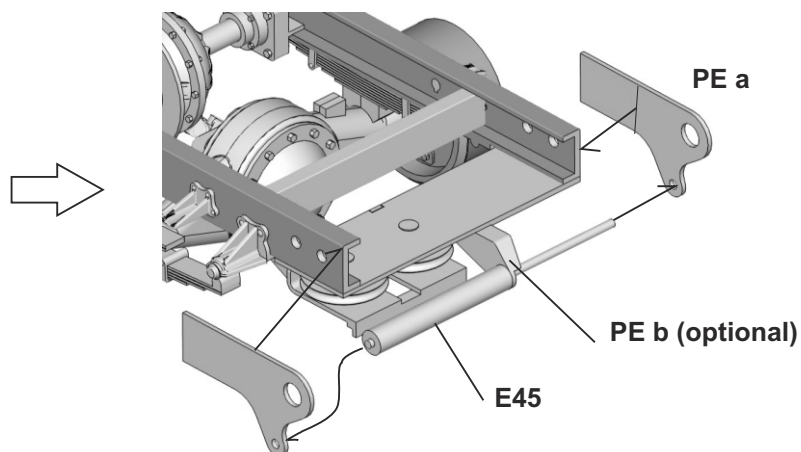
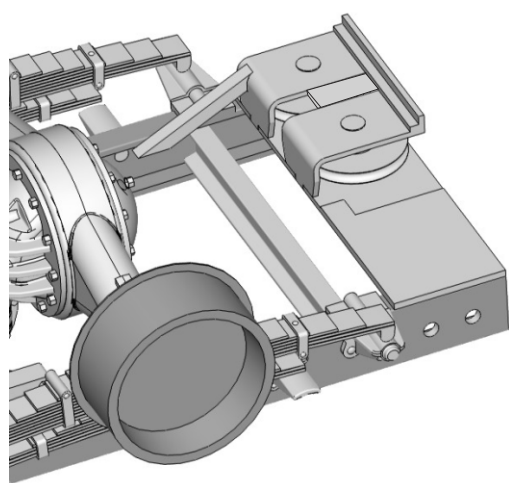
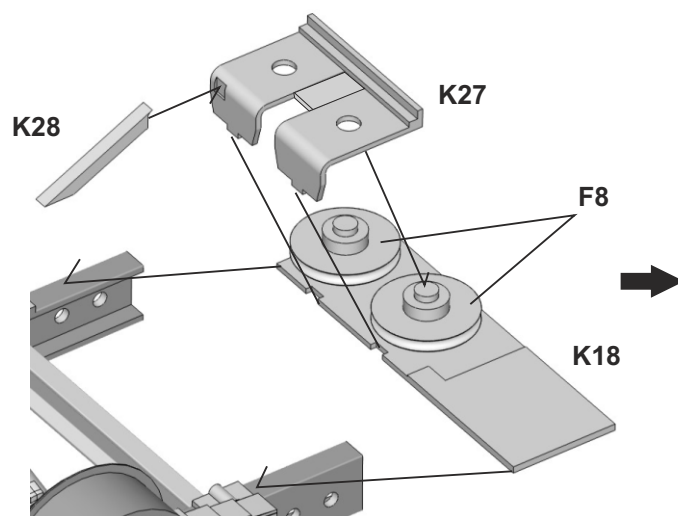
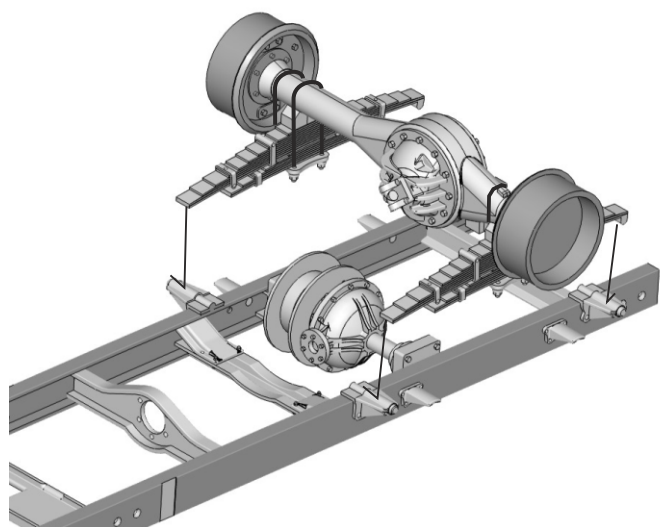
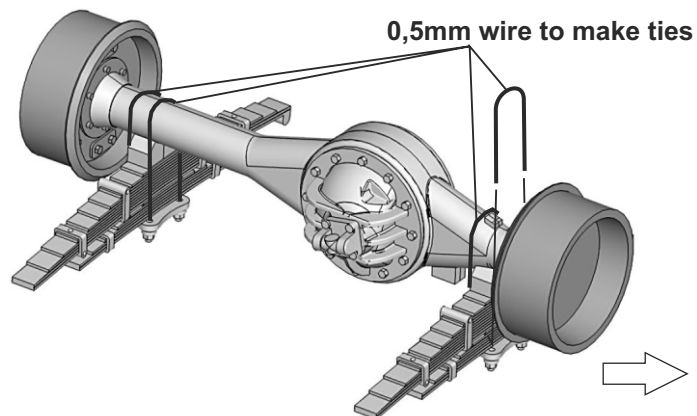
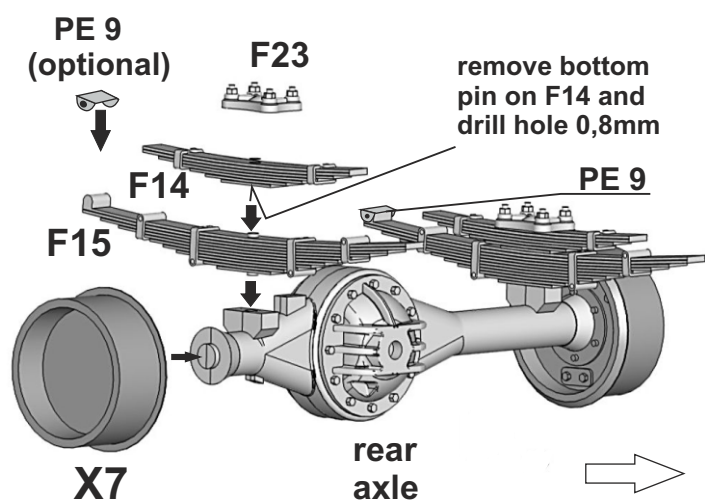
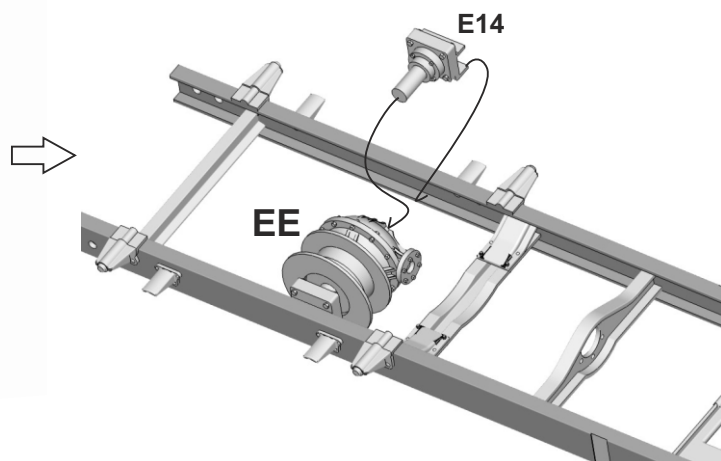
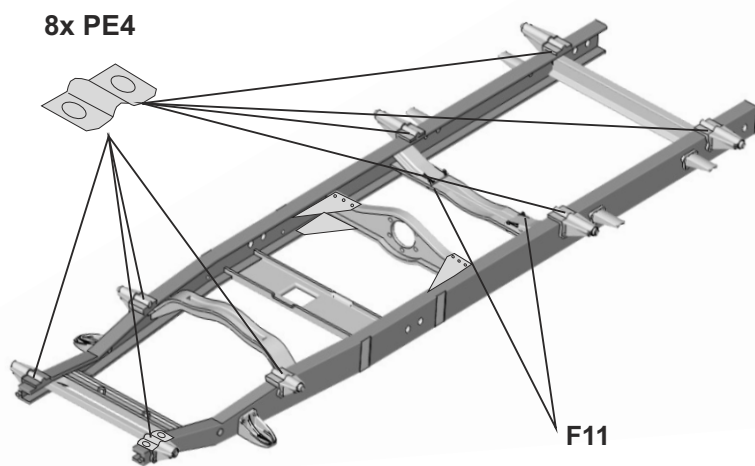

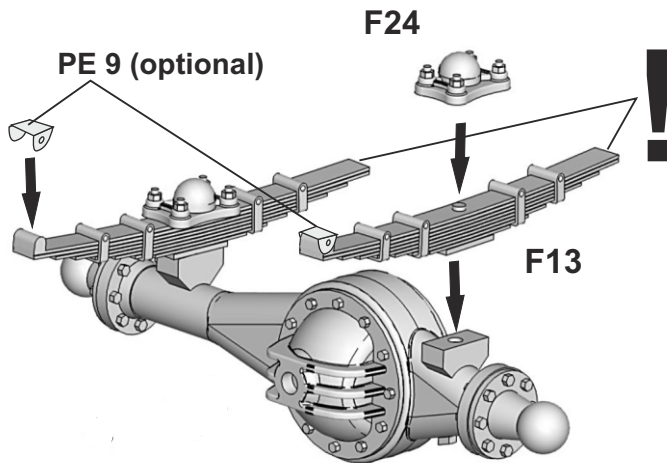
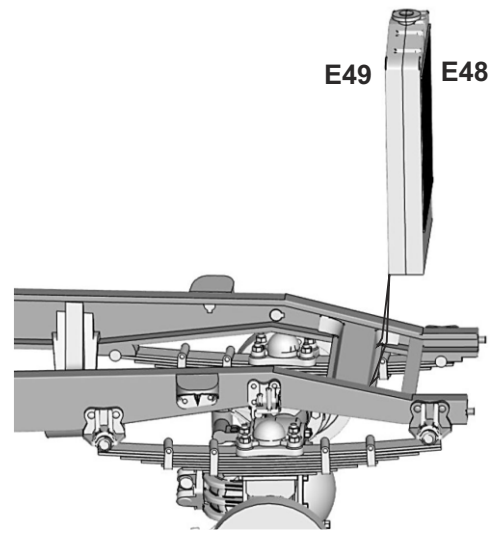
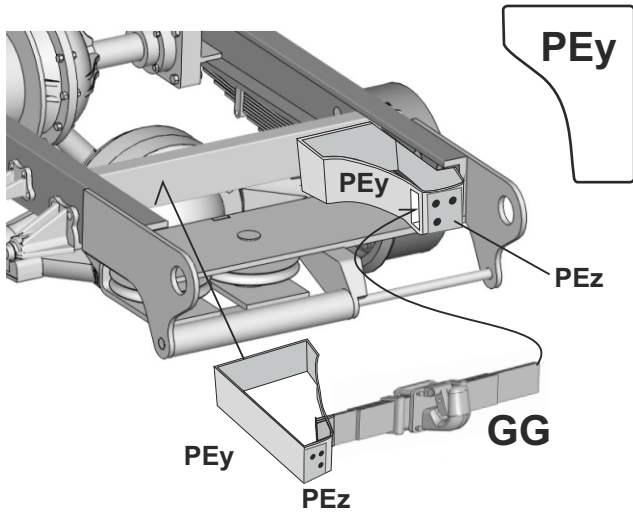

Set angle between front springs according to angle between front holders E16 before you glue springs on axle, check before glue dries!!!

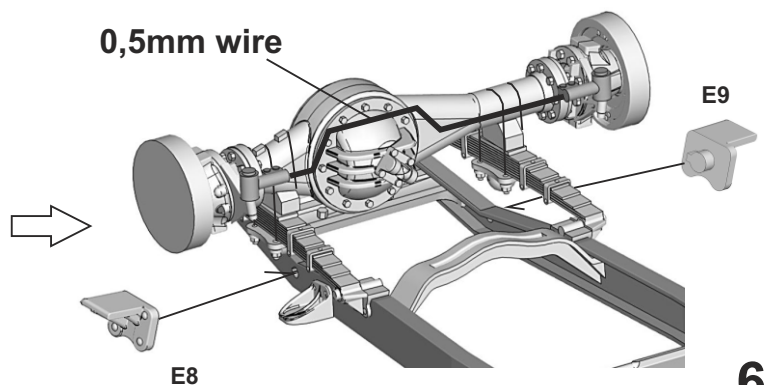
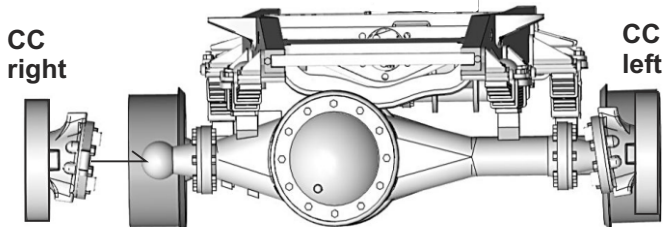
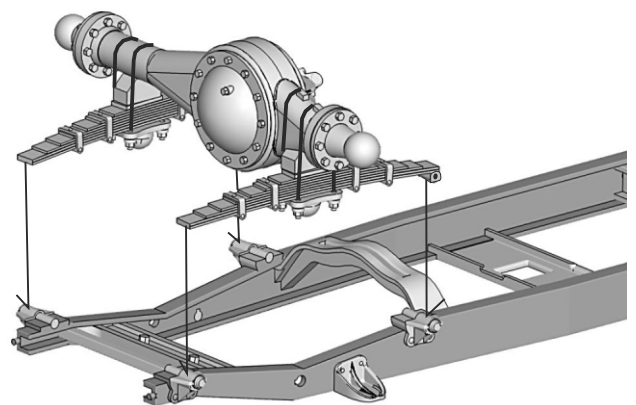
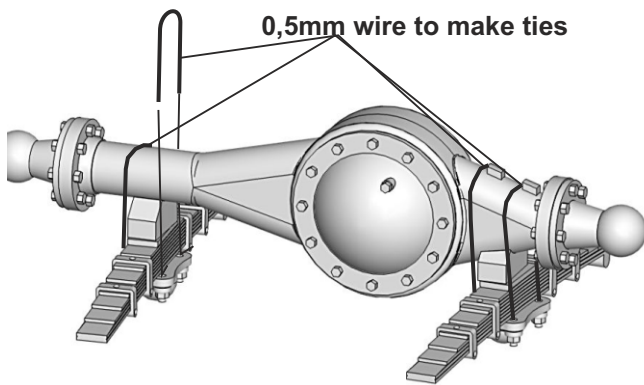
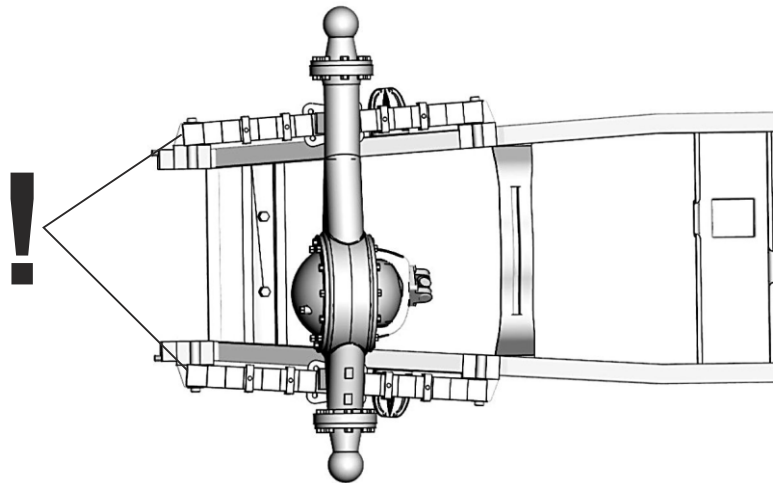

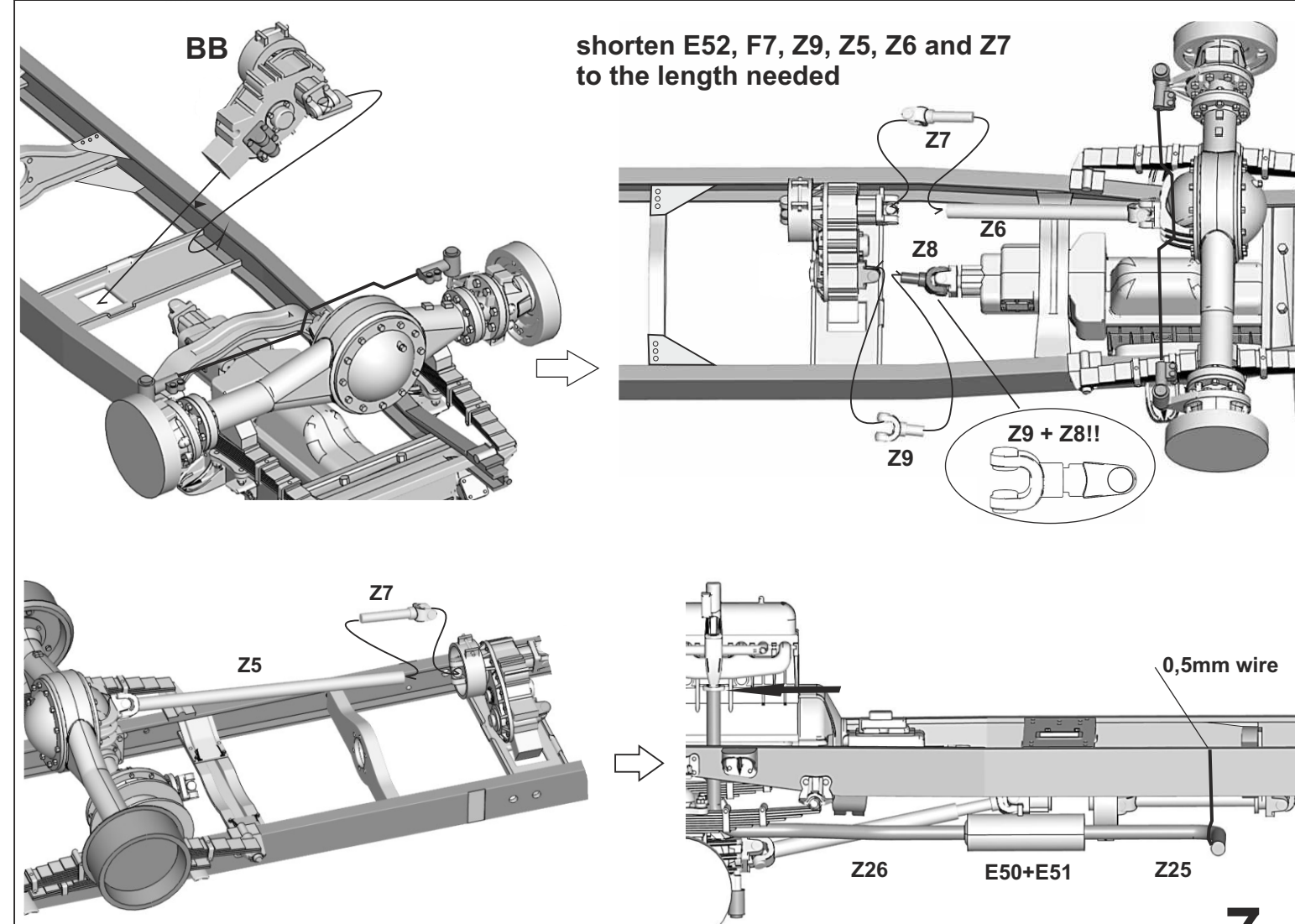
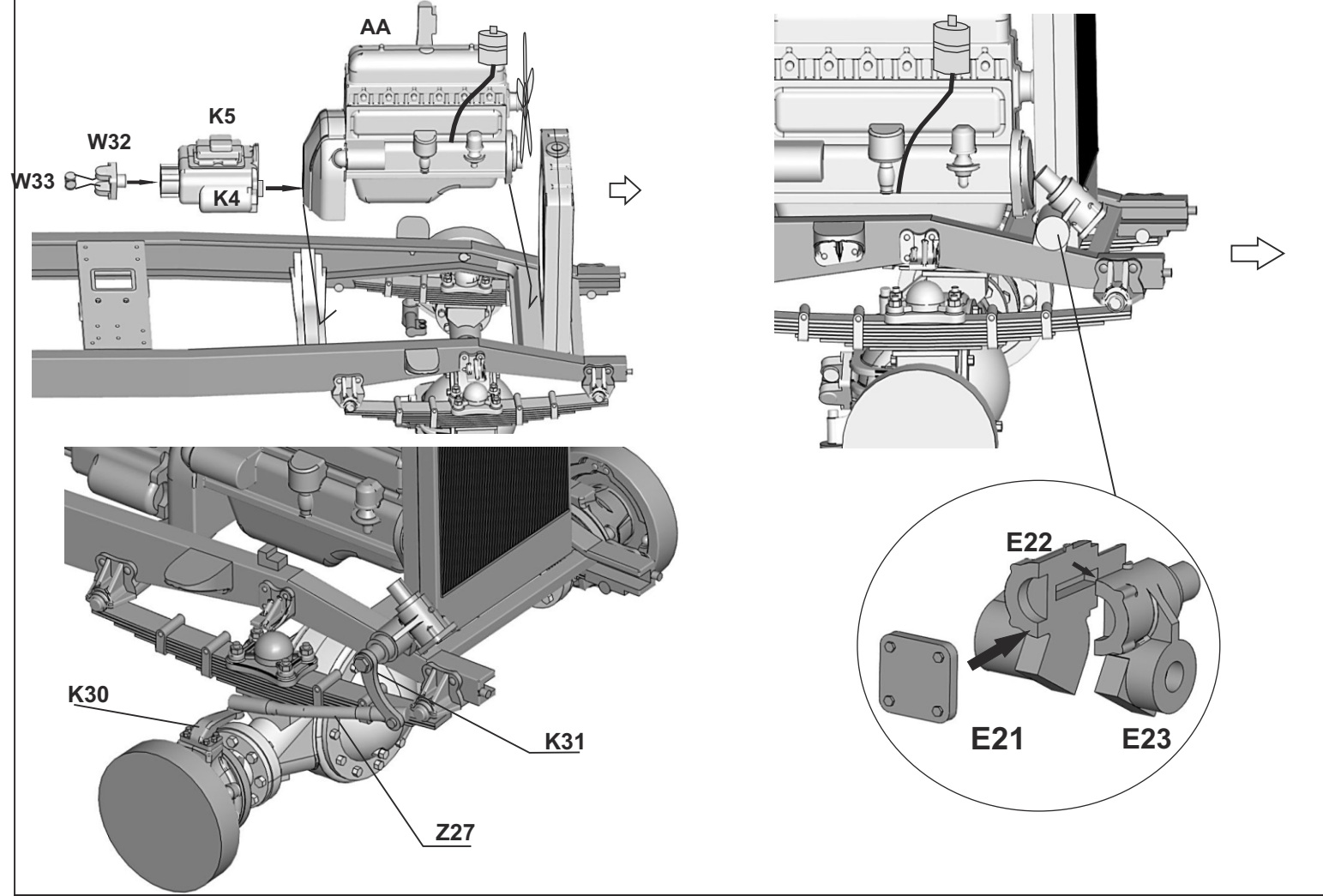

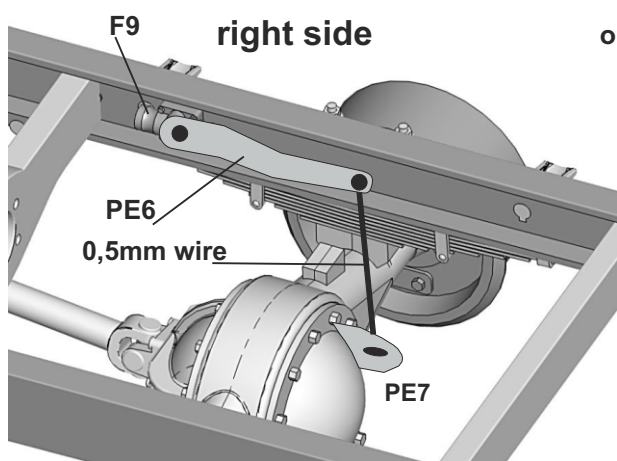

optional detailing

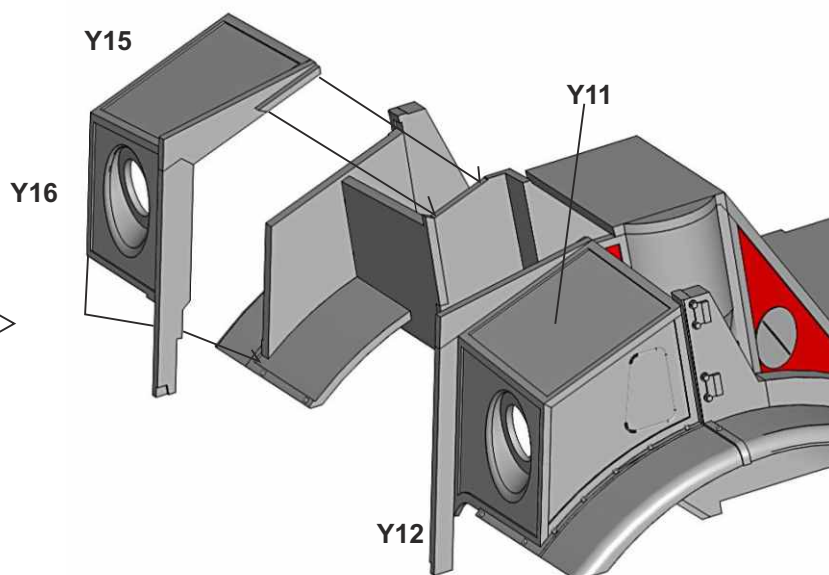
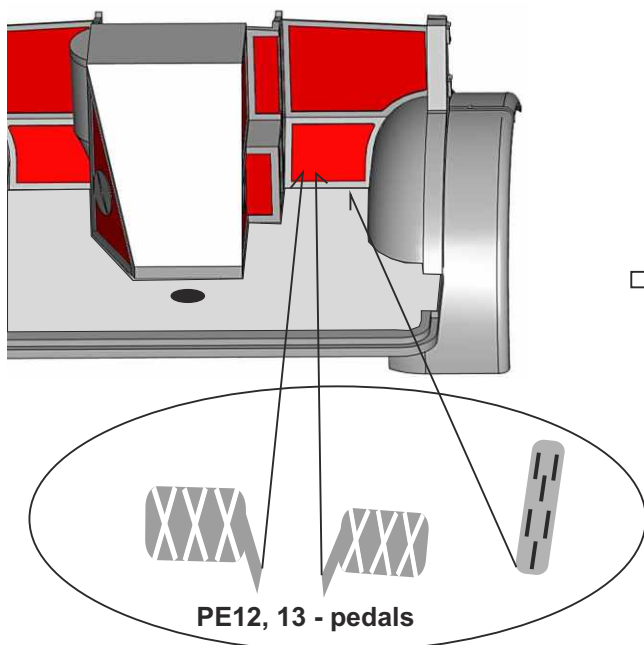
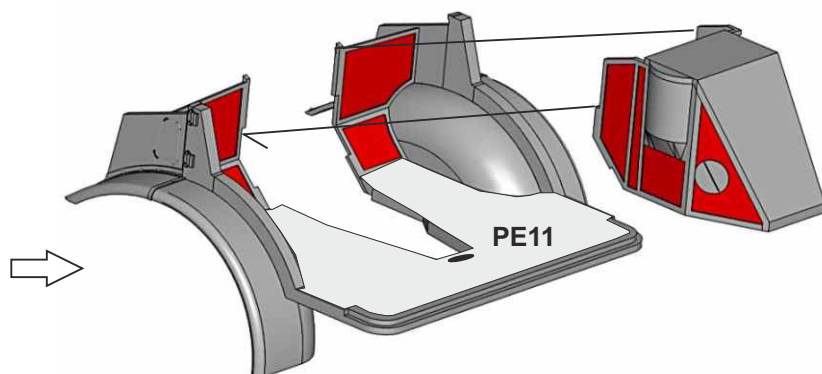
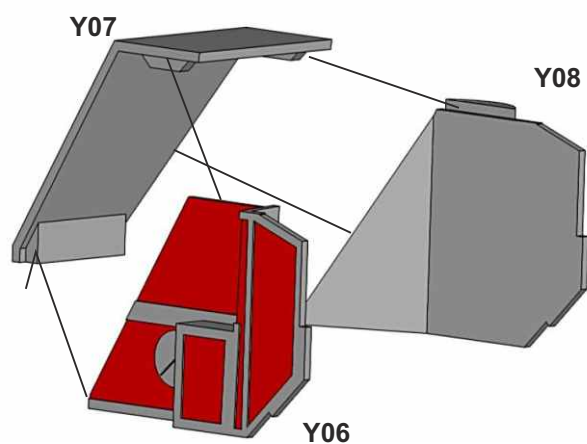
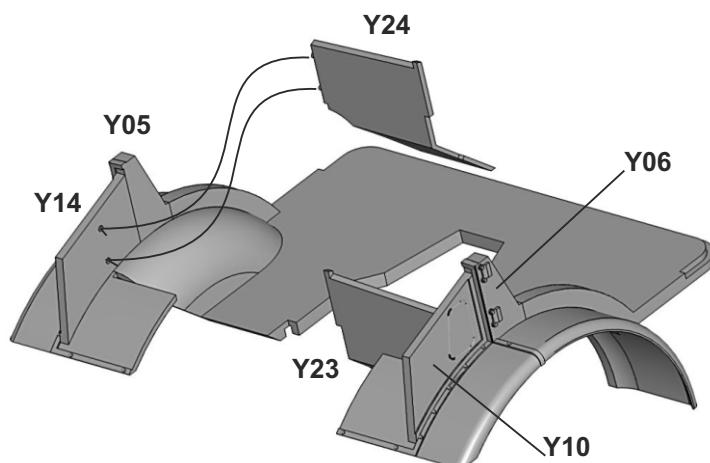
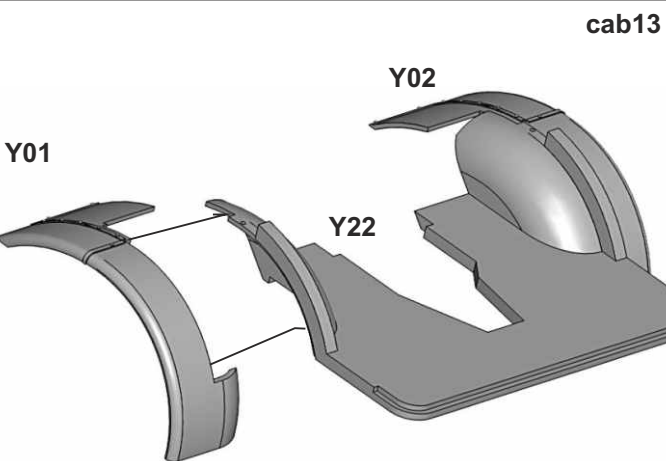
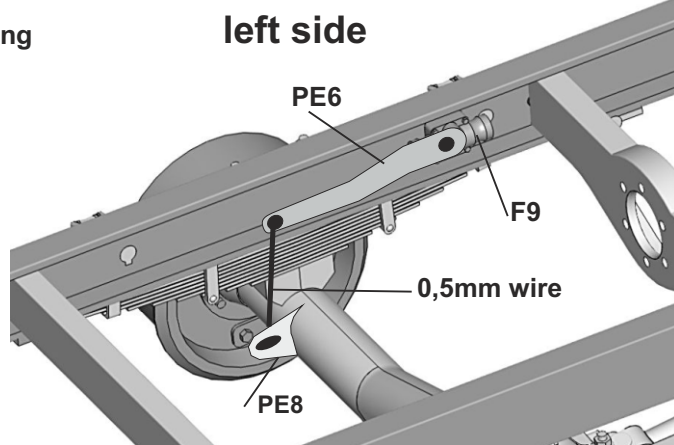

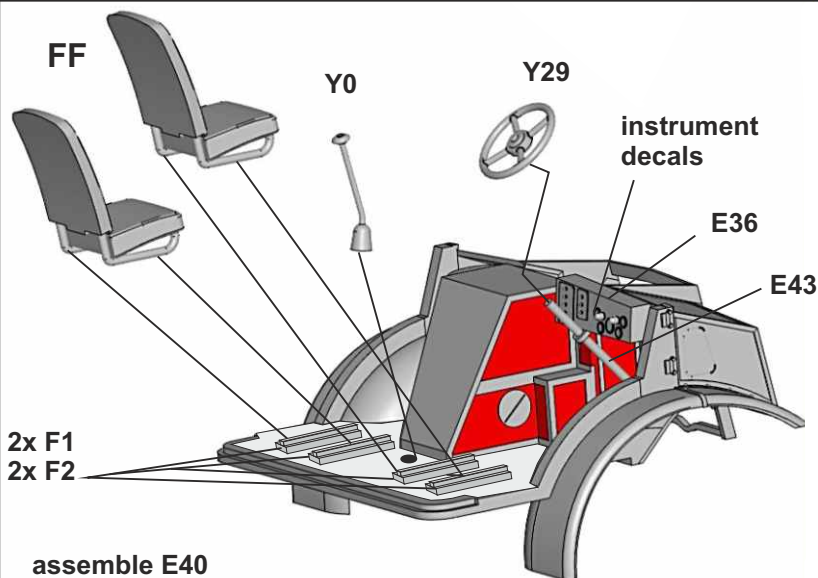
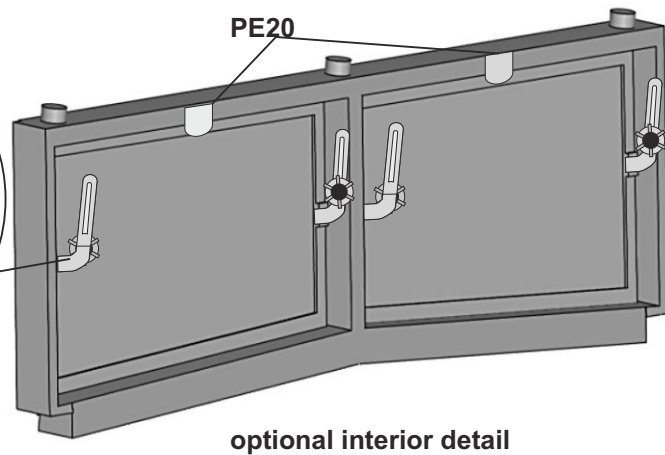
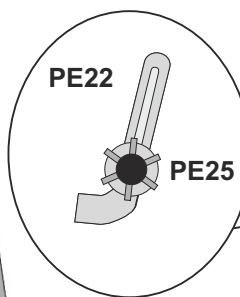
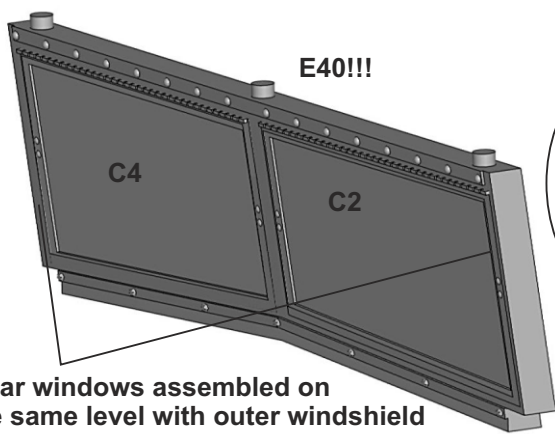

assemble E40 and roof at the same time to set correct angle

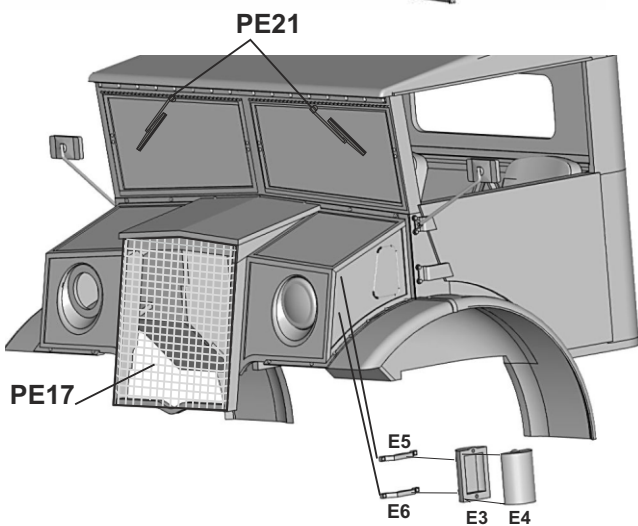
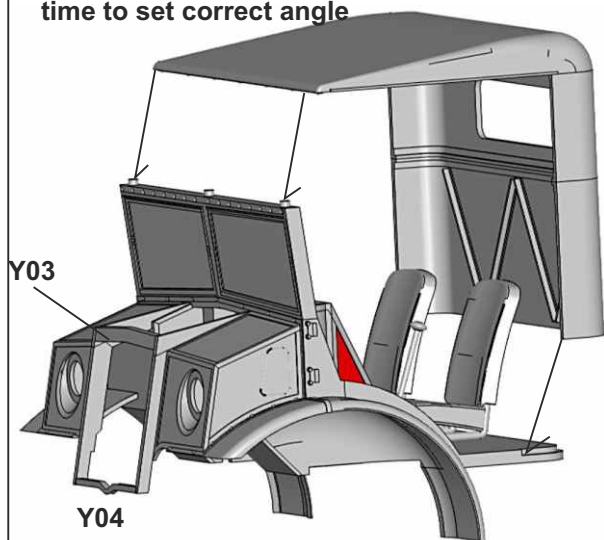
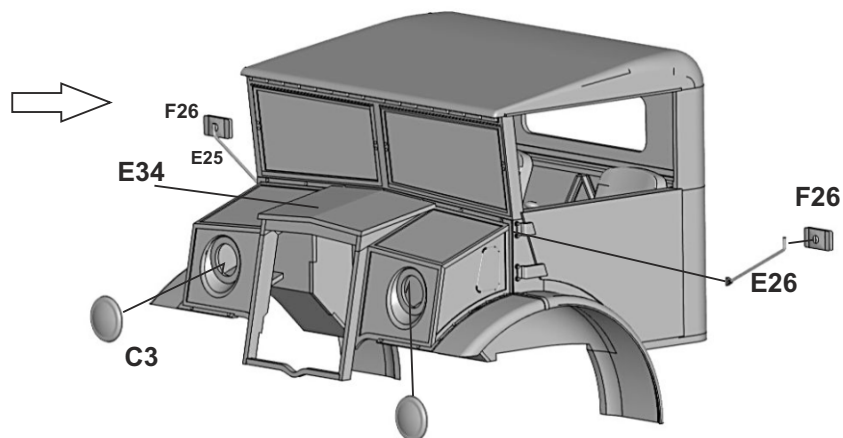
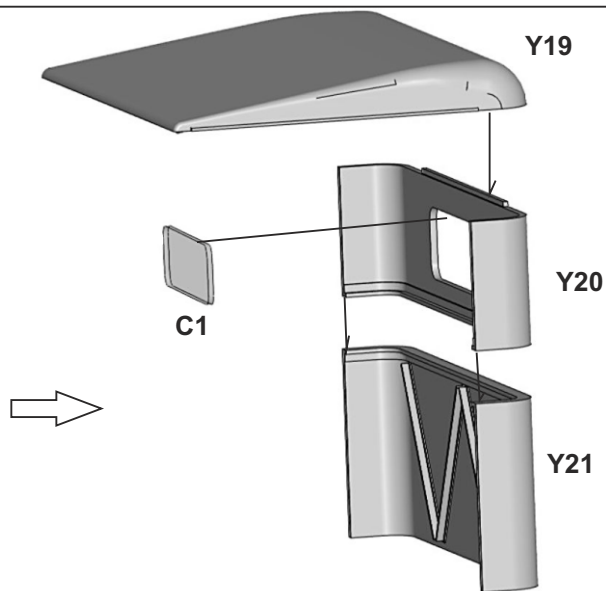

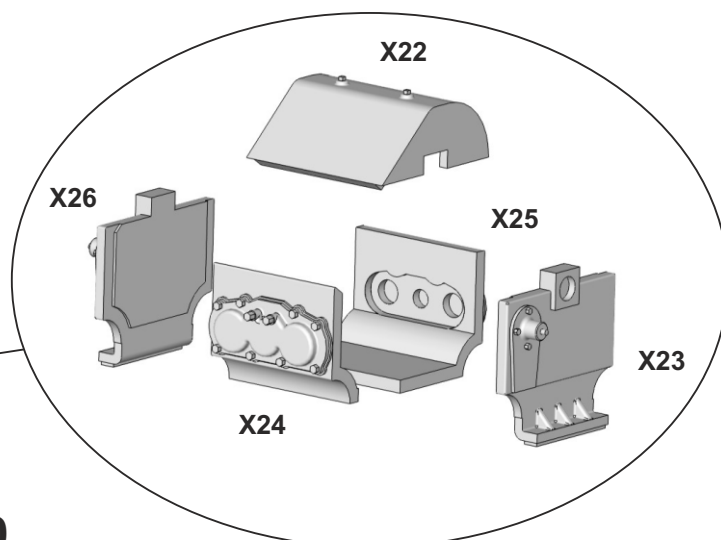
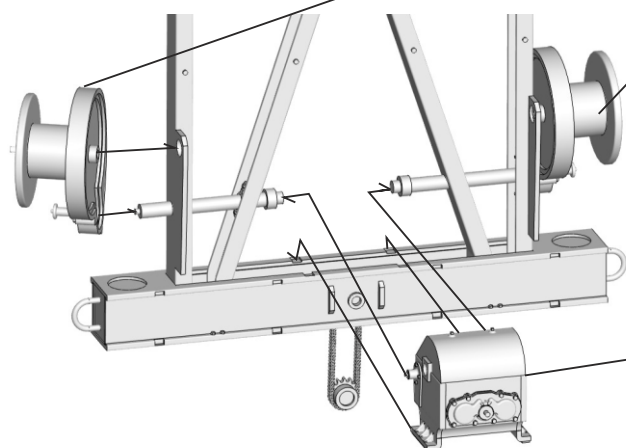
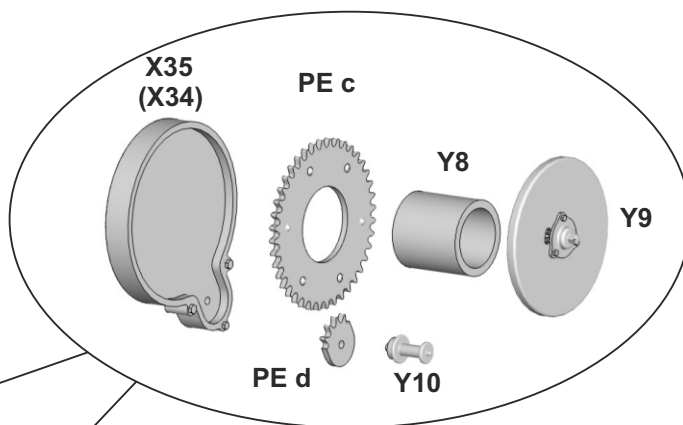
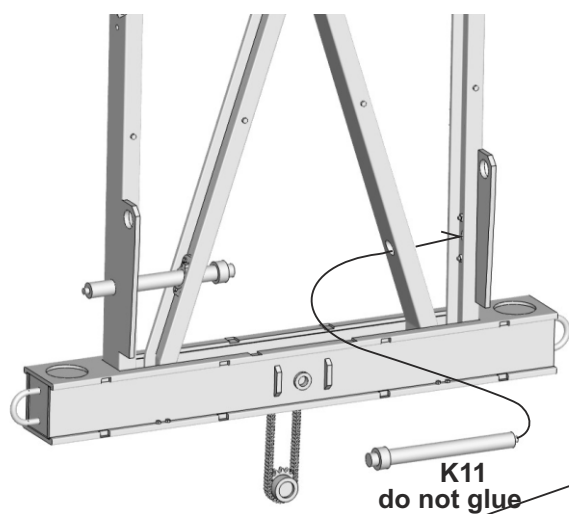
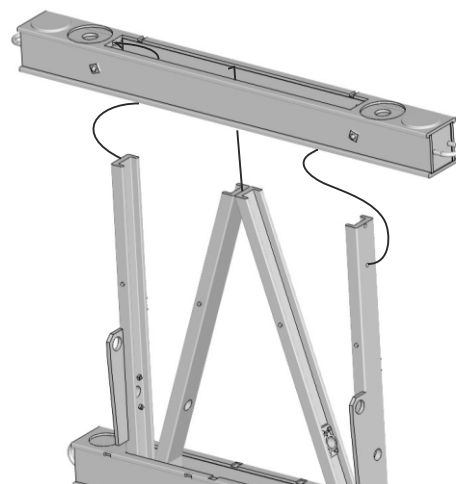
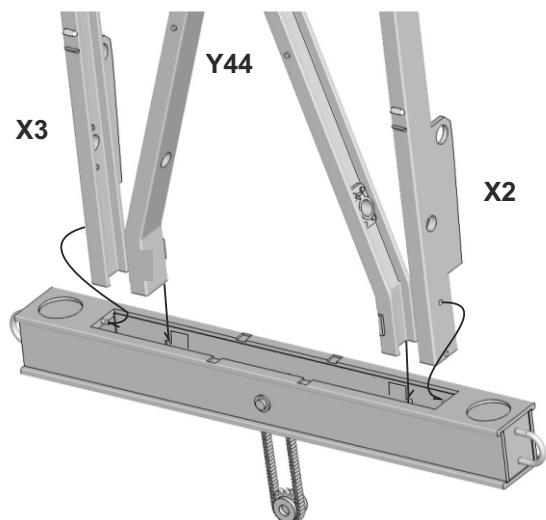
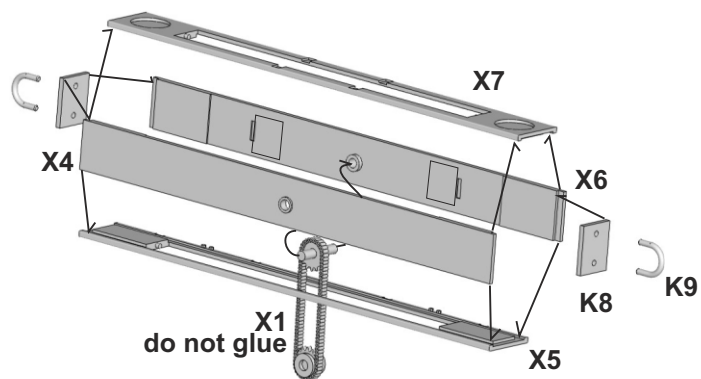
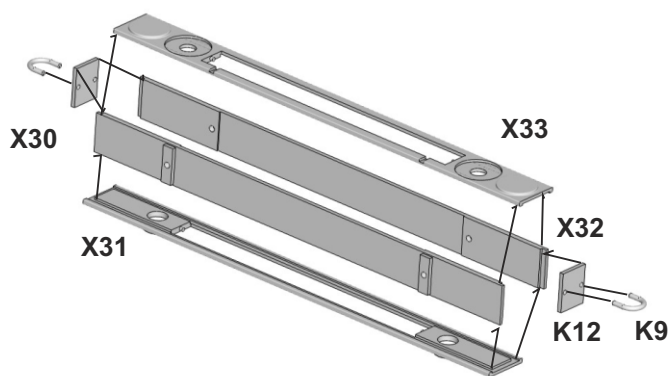

assemble engine first, then reels, mind directions!

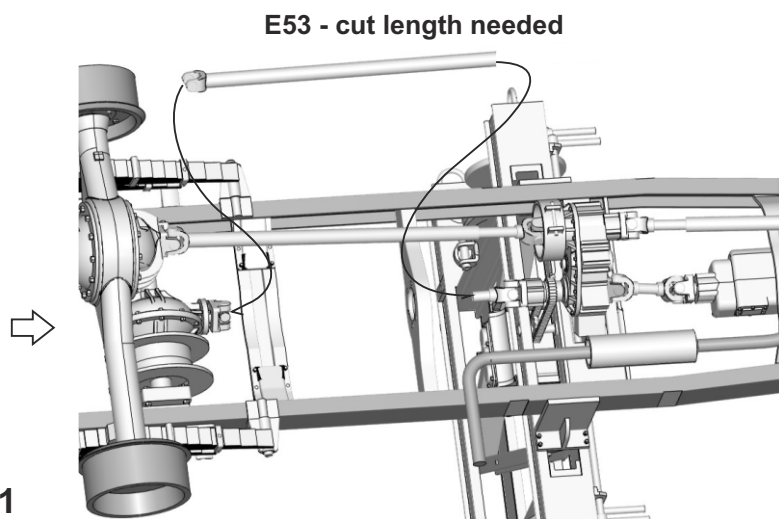
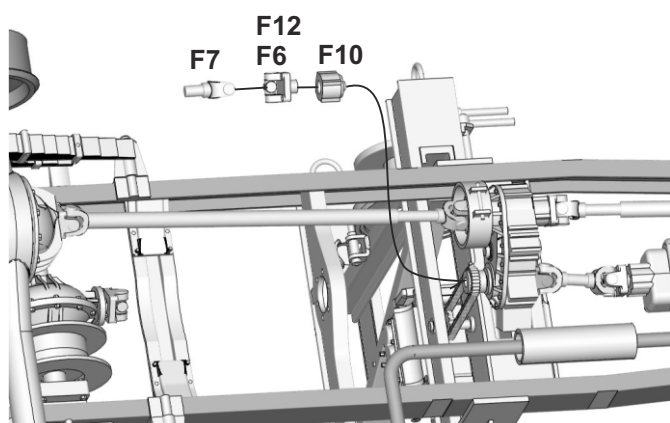
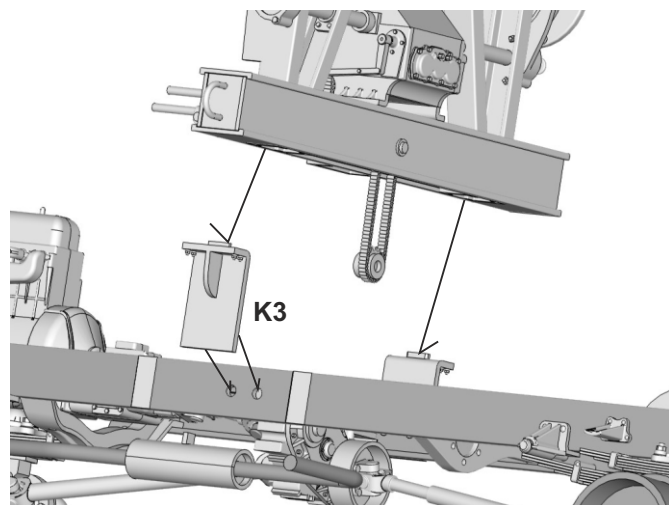
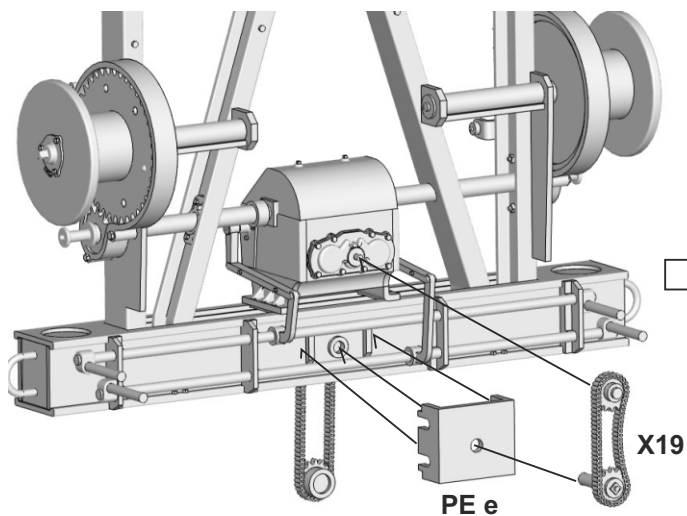
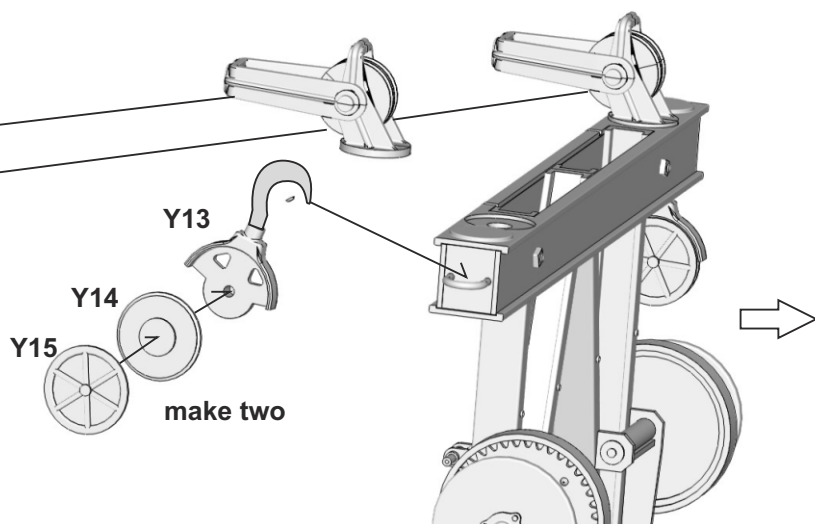
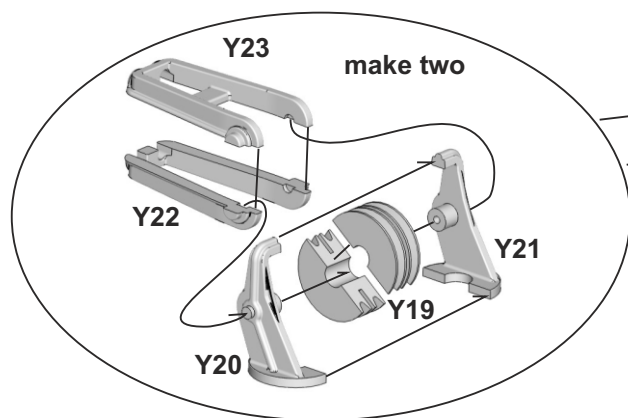
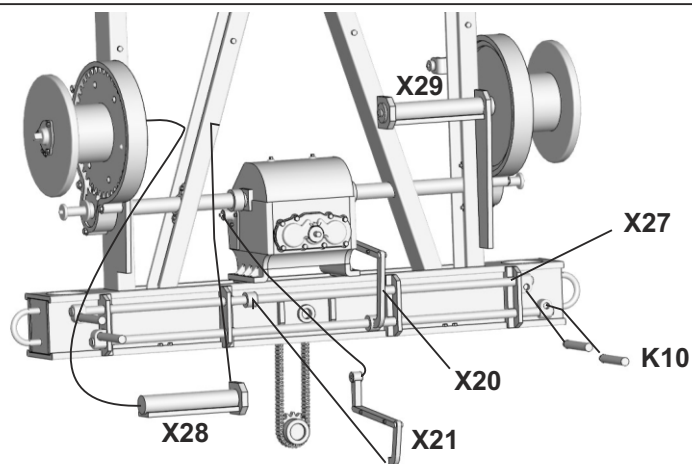
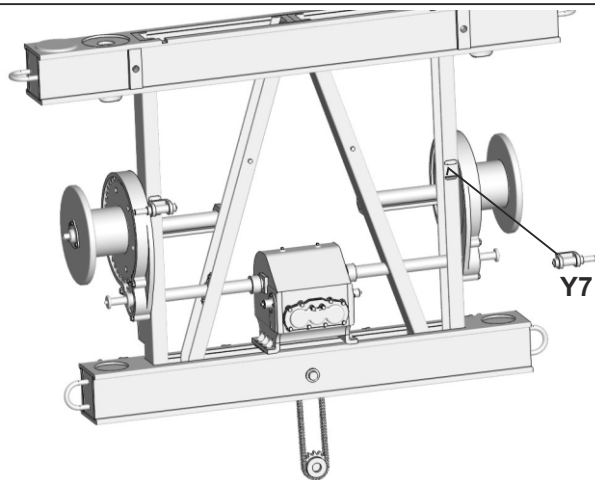

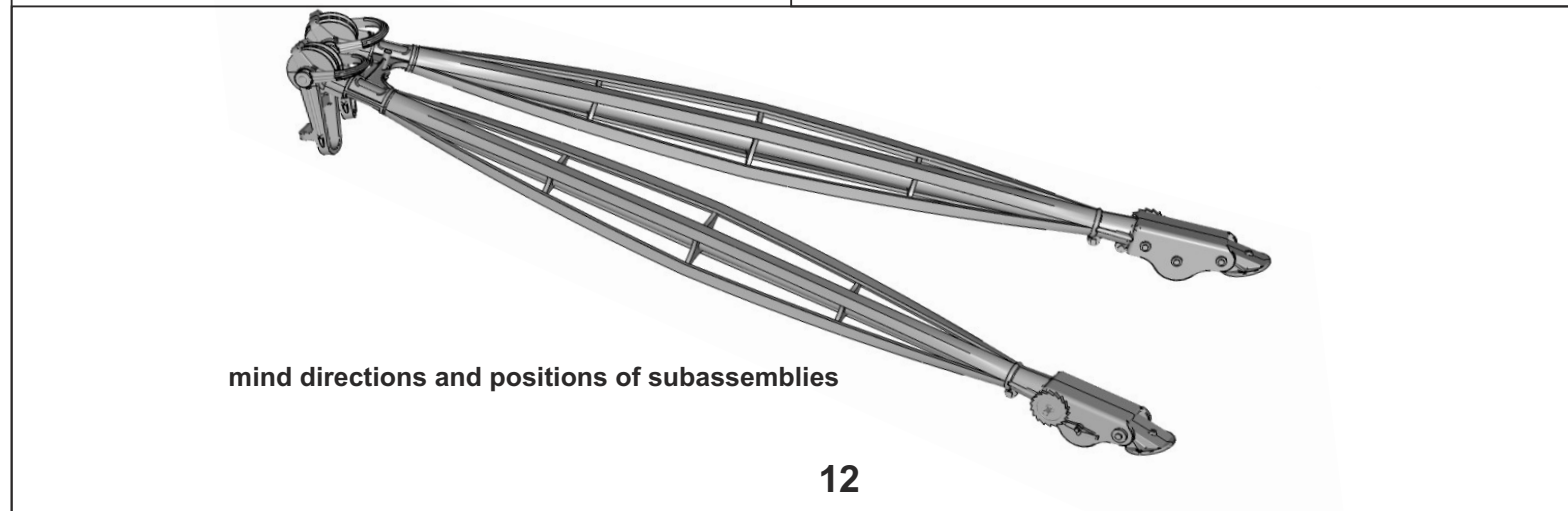
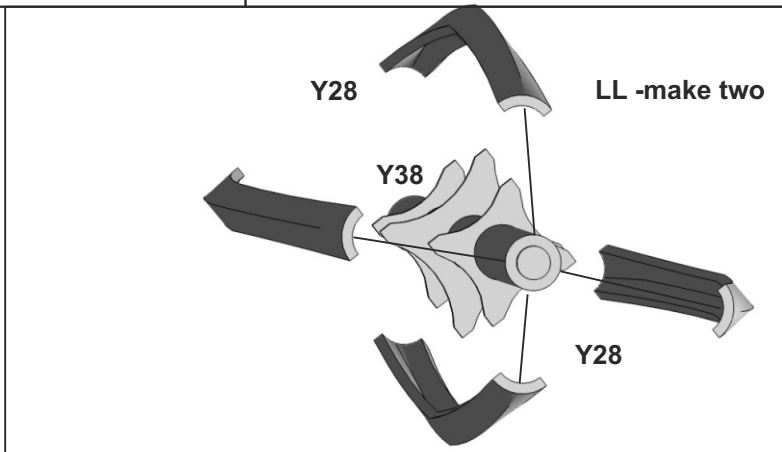
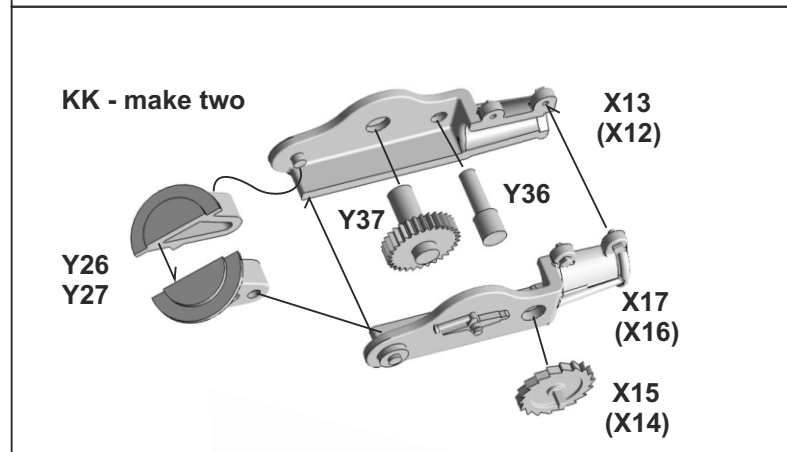
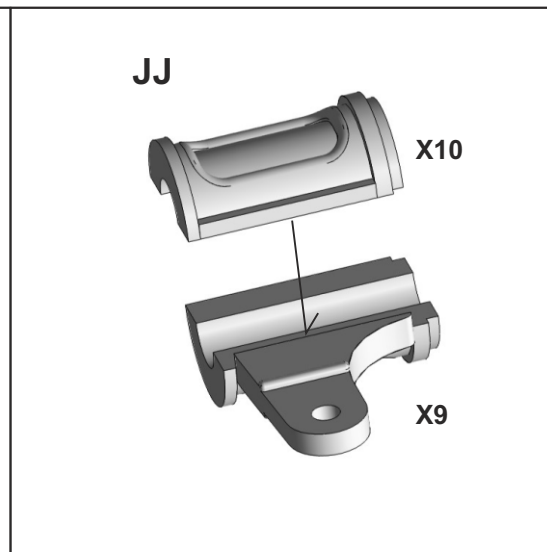
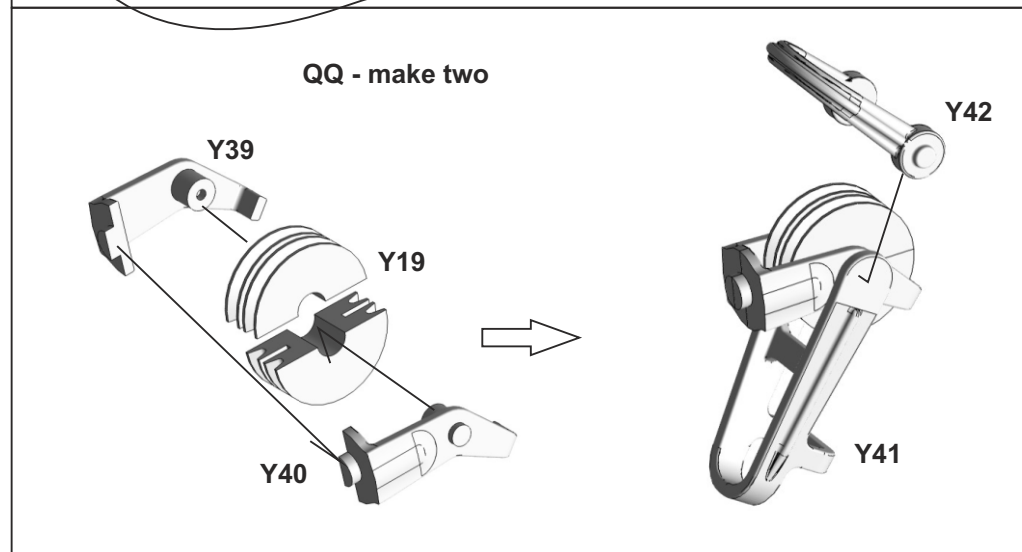
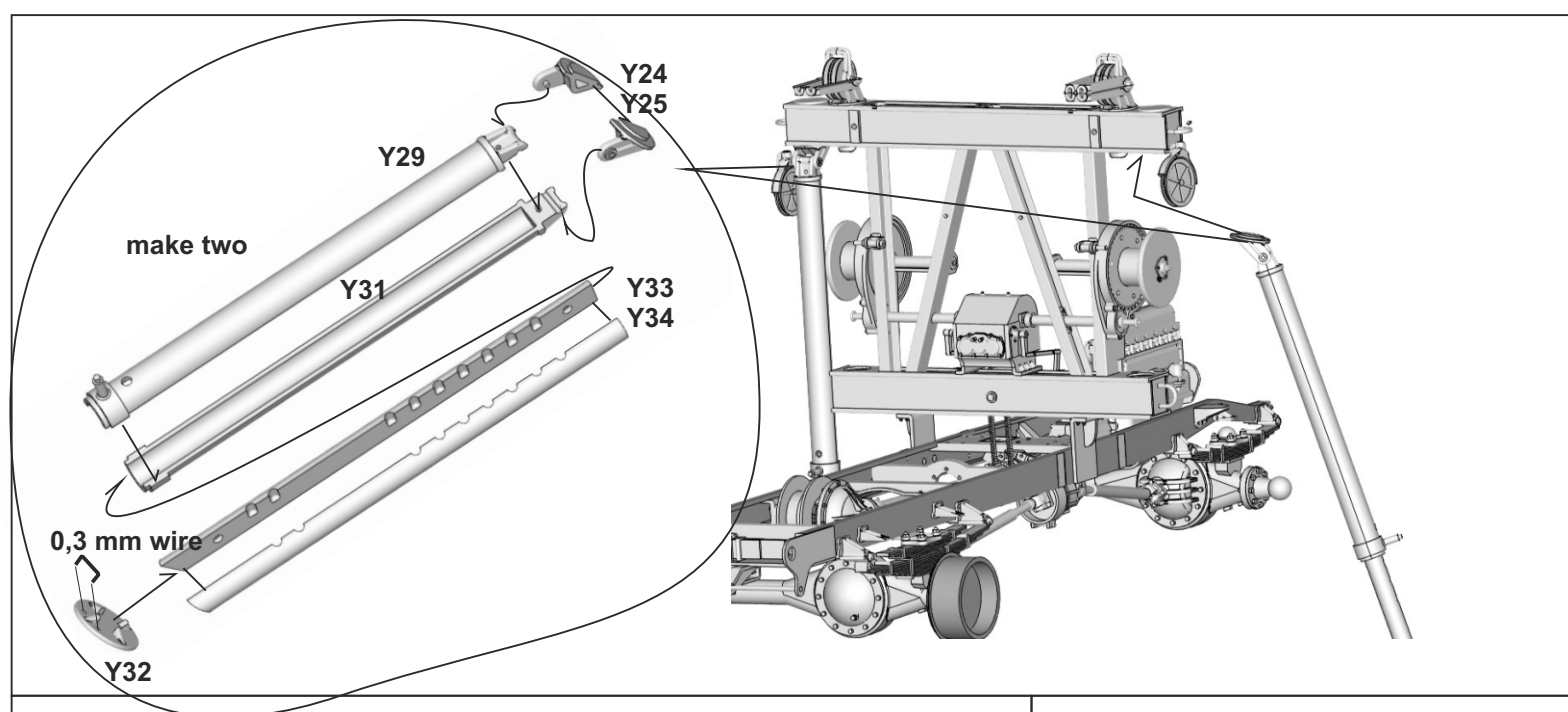

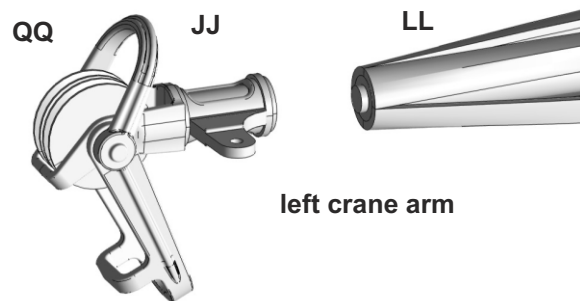
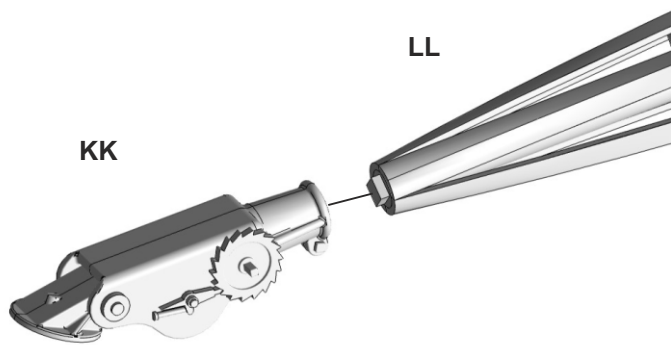

left crane arm

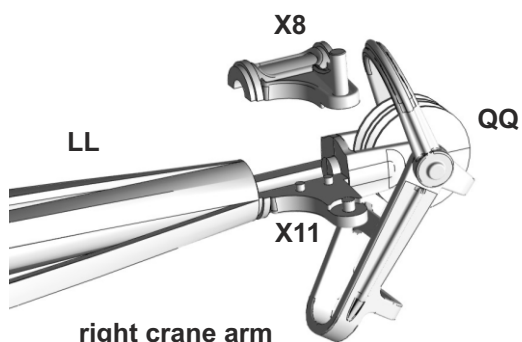

right crane arm

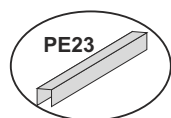
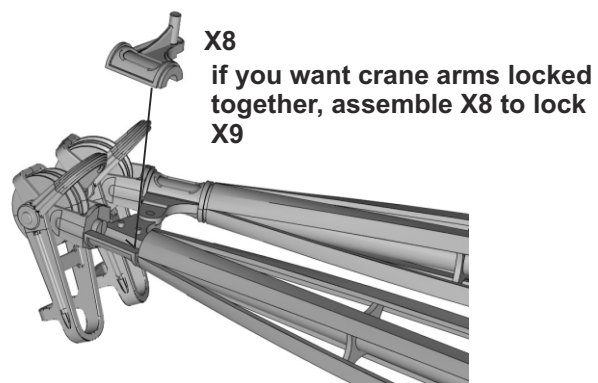

II

remove

place cab

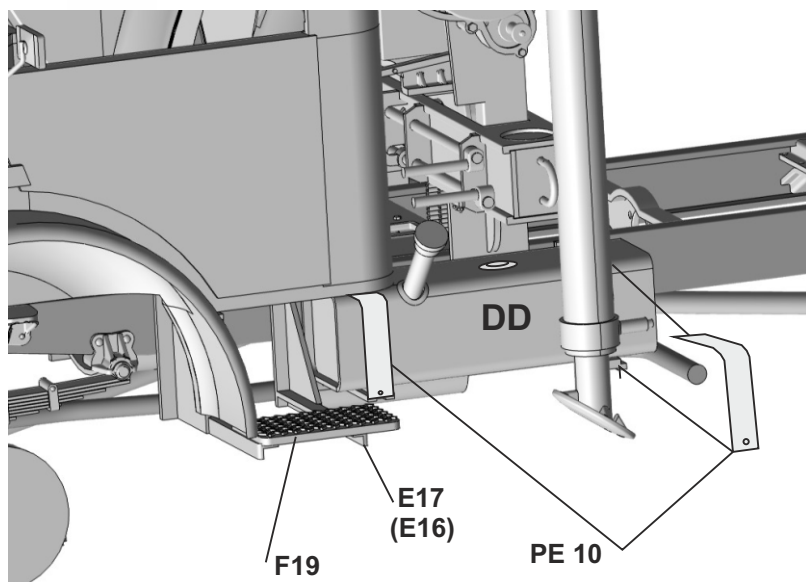
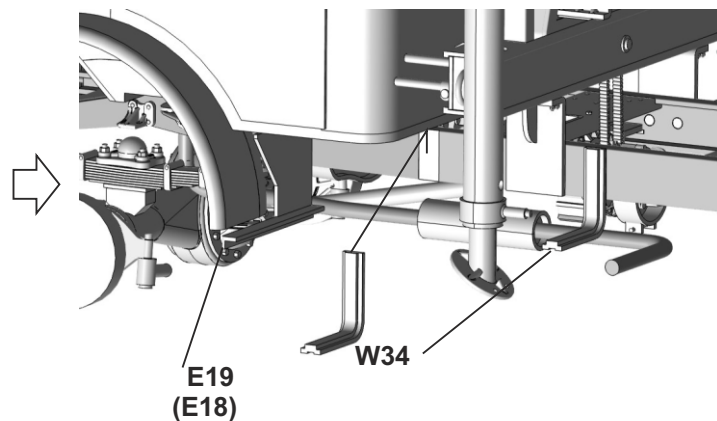

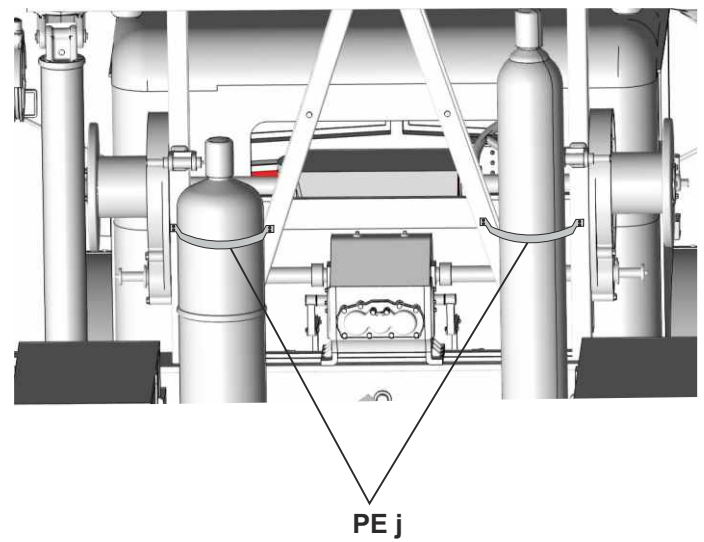
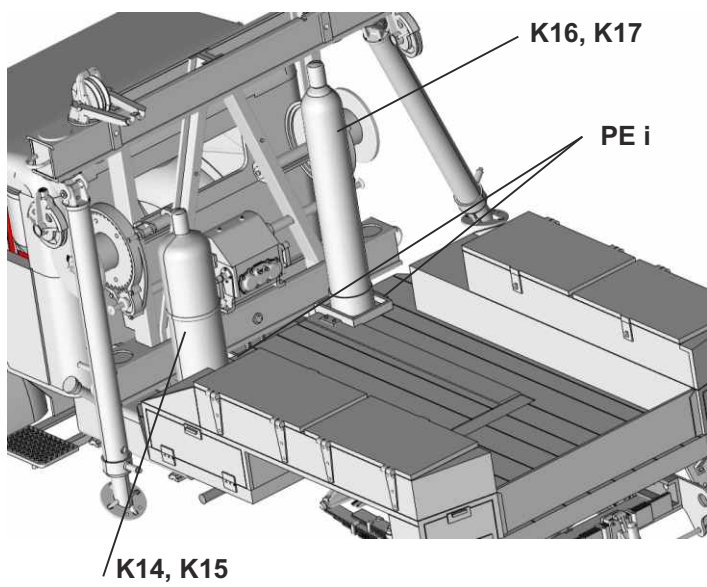
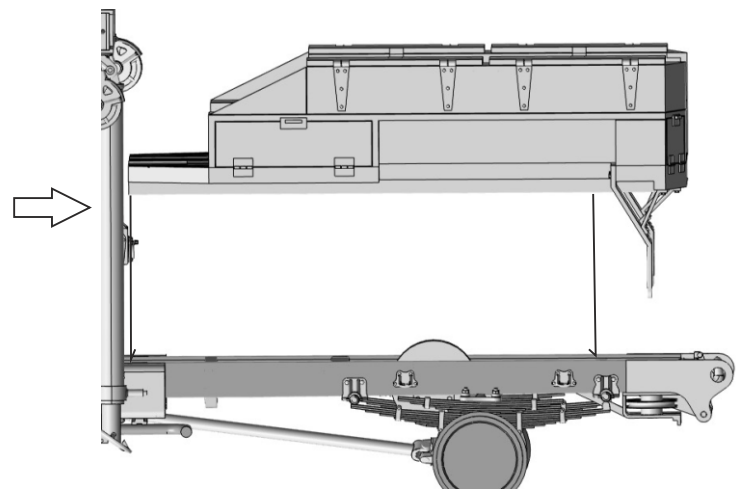
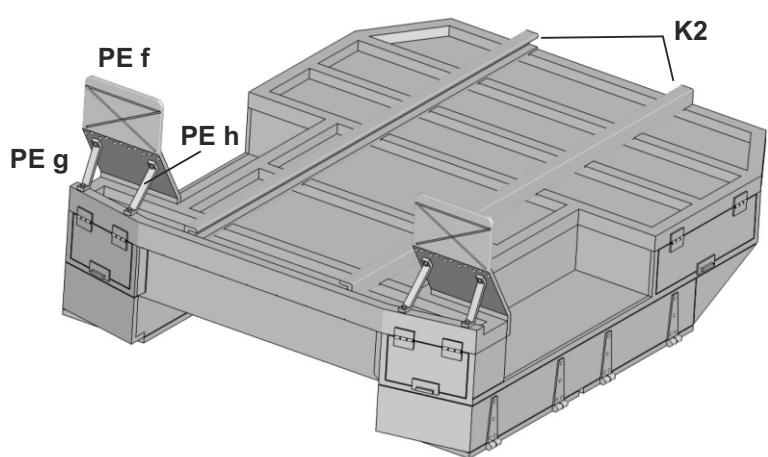
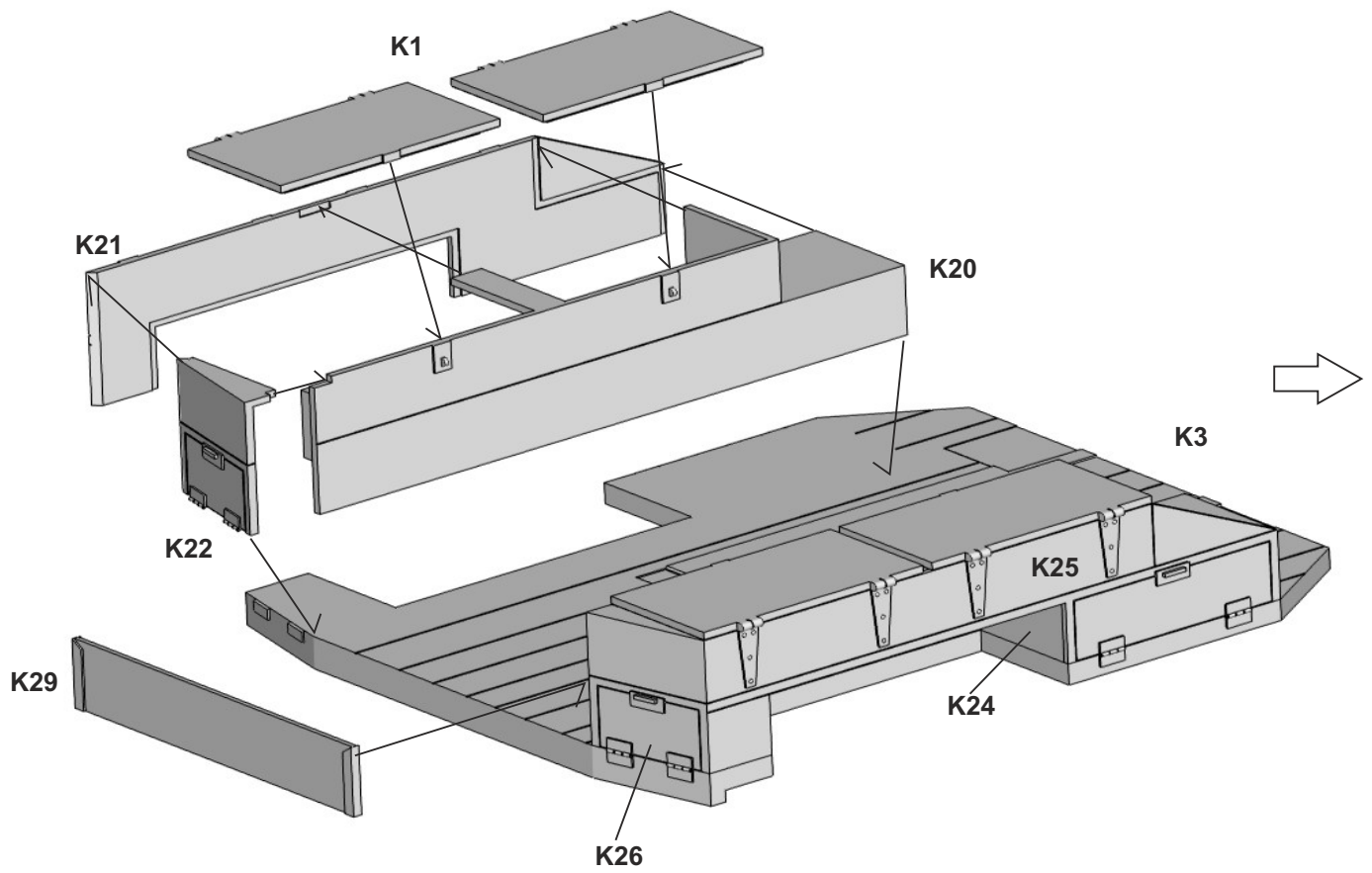

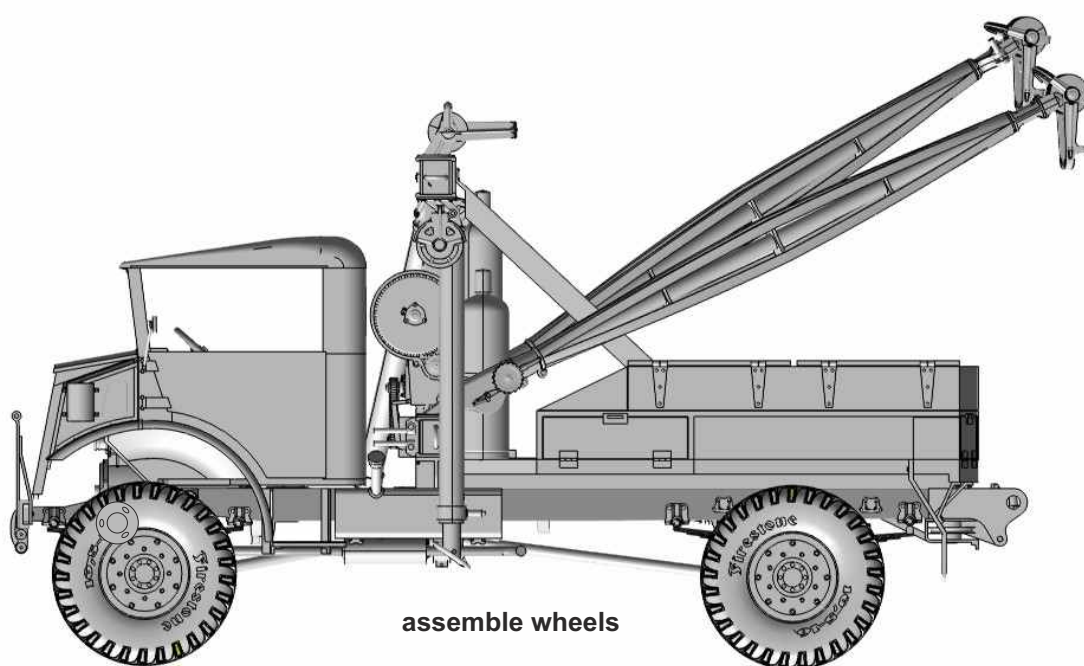
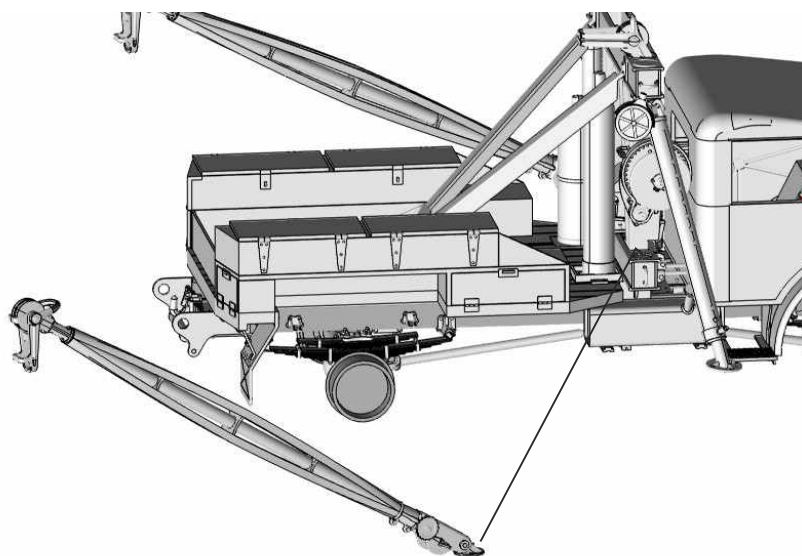
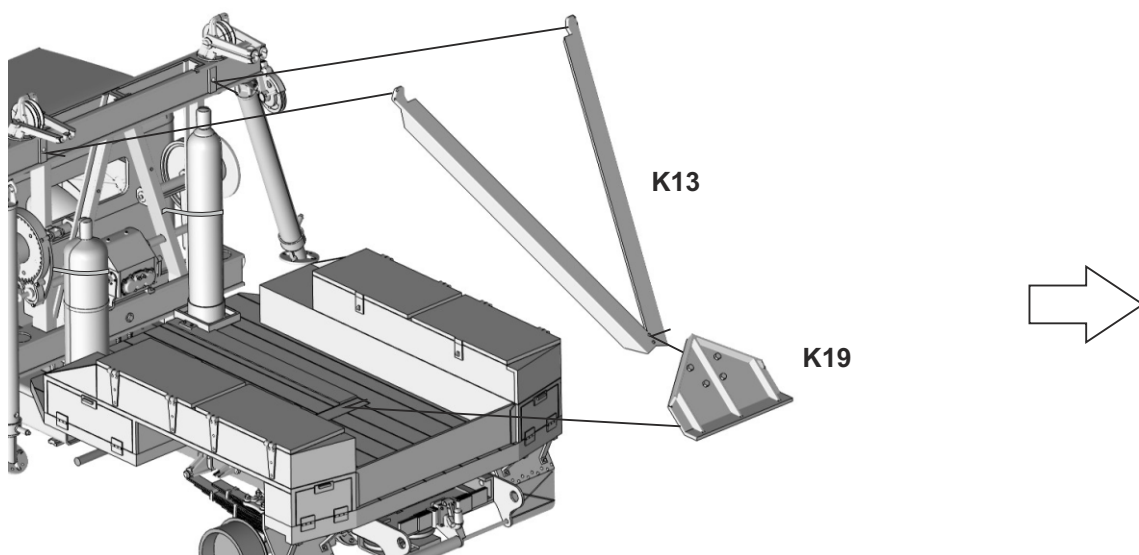

Hook cable assembly

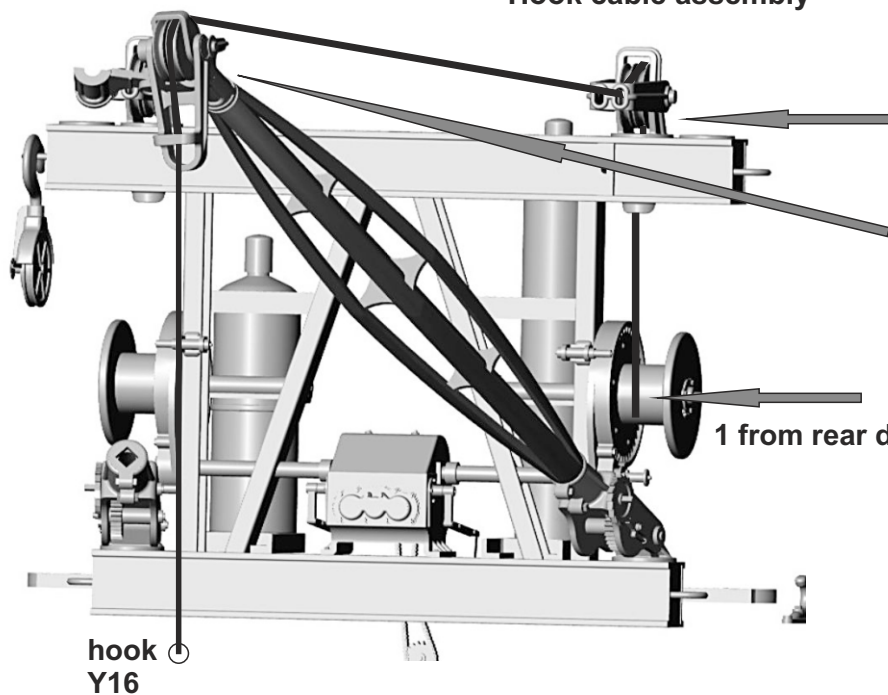

2 through opening in horizontal beam over outer sheave wheel and through the outer yoke

3 over outer sheave wheel and through end cable guide

1 from rear drum

2 lead the cable below cable guide, and from bottom over inner sheave wheel and through inner yoke

3 lead the cable over inner sheave wheel from top down and below the crane arm to the front

Boom cable assembly

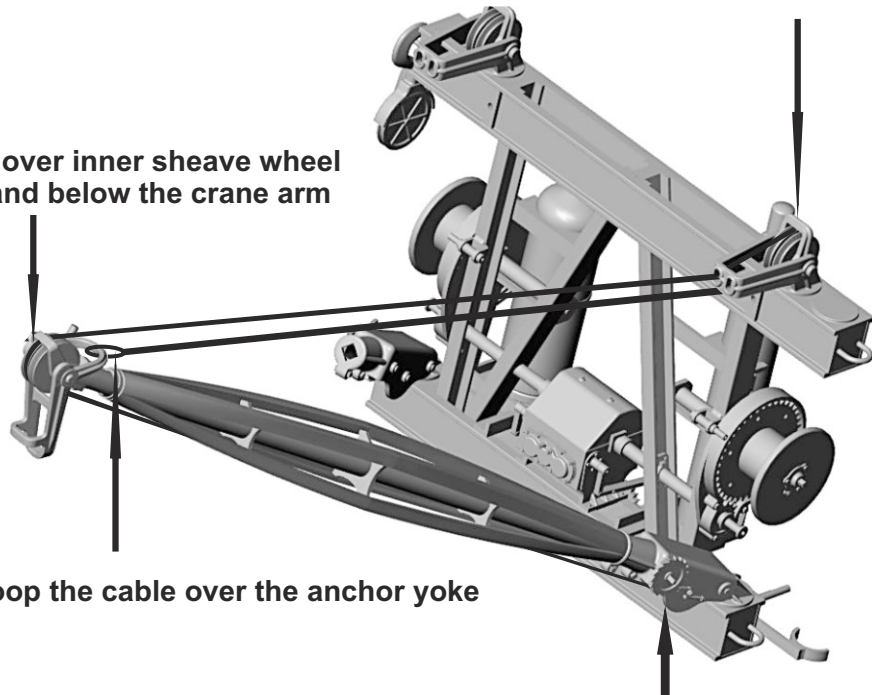

1 loop the cable over the anchor yoke

4 instal the end of cable around rod of Y37 inside "MM" (boom drum)

If you have experienced missing or damaged part,
contact us directly for replacement at
info@mirror-models.com

Check website LZmodels.com online shop for various
CMP trucks equipment, figures and more