

**Mirror Models 35122 CGT Field Artillery Tractor Cab 13, body 7B2**



# Assembly instructions

Canadian Field Artillery Tractor design, made on request to British standards, began in 1939, and first production models appeared in June 1940. All models were designed to tow limbers and field guns over any type of terrain, with crew of six men including a driver. As usually, chassis were produced by GM and Ford, with their standard engines, and fitted with power winch and 10,5x20 tyres, while bodies were delivered by other independent manufacturers. They all had to fit on both chassis, though. Several variants of bodies were used, first the sedan type body 7A1, which was shortly modified into the 7A2 body with improved ventilation (hinged windows, roof opening with canvas cover, rear hatches for observation). The 7B1 body was developed in 1942, when Cab 13 was introduced, followed by the 7B2 body with a spare tyre mounted on the rear deck, for service in extreme frost some of these were winterized (FAT-5). In 1943 the 7B3 body appeared - all steel body with open roof, and superstructure holding canvas, which design brought more stowage space inside the vehicle.

**Go through assembly guide before you start your work. We recommend to use a sharp scalpel to remove parts carefully.**

**Heat up PE parts with lighter before use, brass will soften and become easy to bend and work with**  
**Tamiya Super Thin Glue recommended for plastic parts, let the glue work for a few seconds, then push parts together, melted plastic will fill the gaps between parts. You can also melt sprue frame and use it as an amazing filler for small works, or use this glue to wash out tiny seam lines on little parts or make texture on some parts etc. You might need to adjust some holes with drilling bits**

**Part list:** Sprue A, frame, partly used  
 Sprue C, clear parts  
 Sprue E, various parts, partly used  
 Sprue F x2, frame and chassis parts  
 Sprue H x2, various parts  
 Sprue M, various parts  
 Sprue N, body parts  
 Sprue W, various parts, partly used  
 Sprue X, axle parts  
 Sprue Y, cab 13 parts, partly used  
 Sprue Z, various parts, partly used  
 1x PE detail sheet, 5 resin wheels, wire, rope and canvas material for assembly, decal sheet

## Make subassemblies

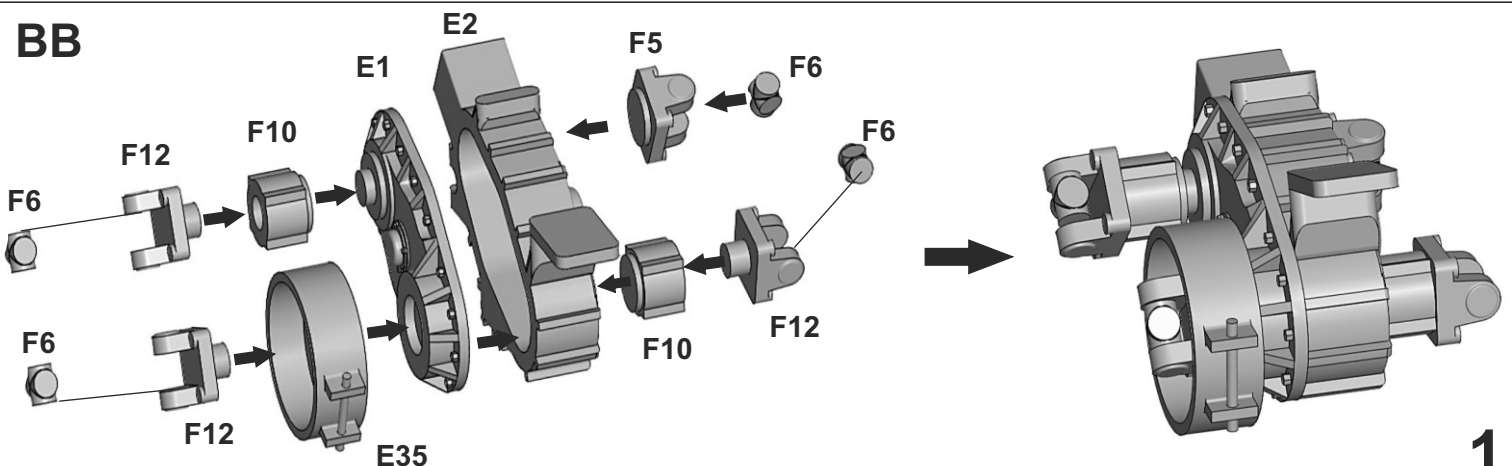
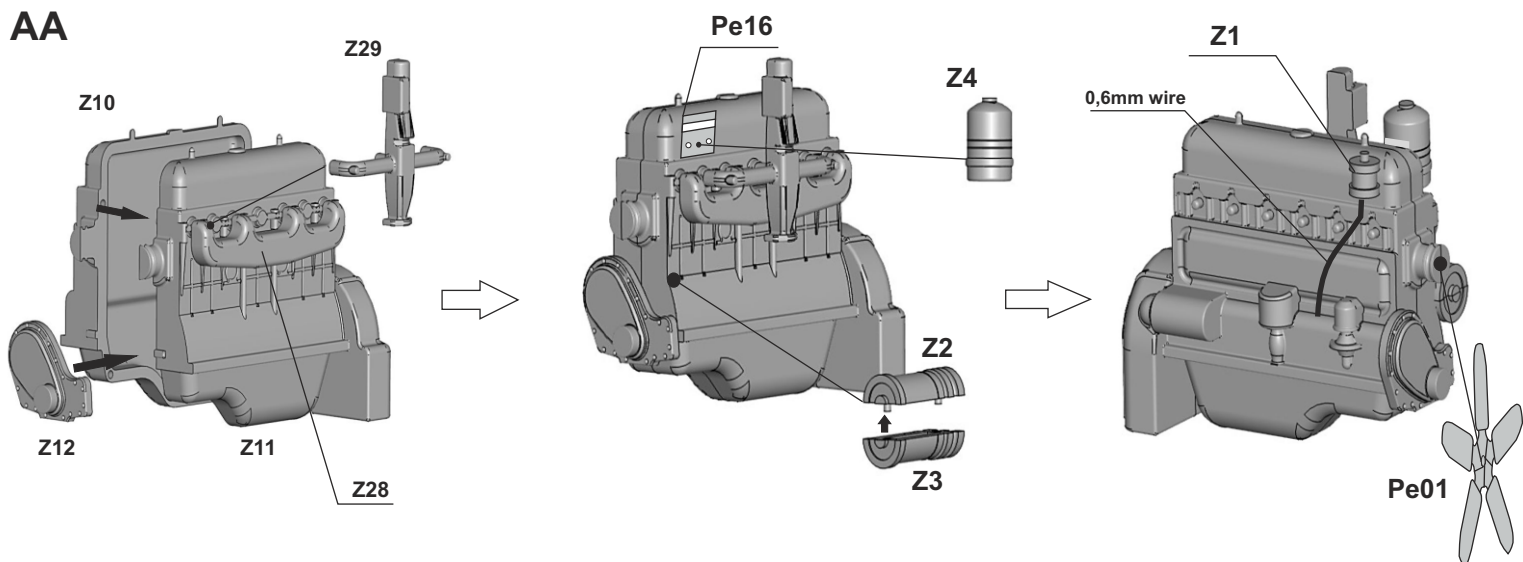

CC

right

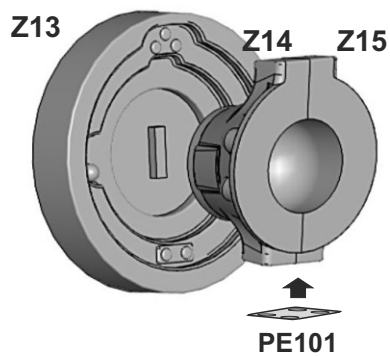

Z16

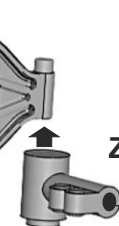

Z18  
Z19  
drill 0,6mm holes

left

Z17

PE101

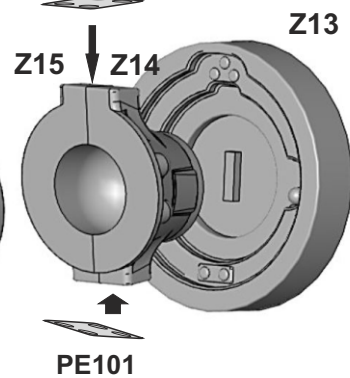

DD

W38



W35

W35

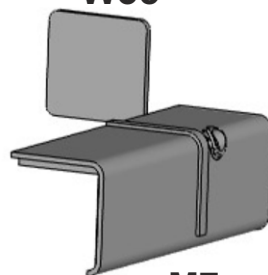

M7

H6



leave 0,5mm gap  
between tank and holder

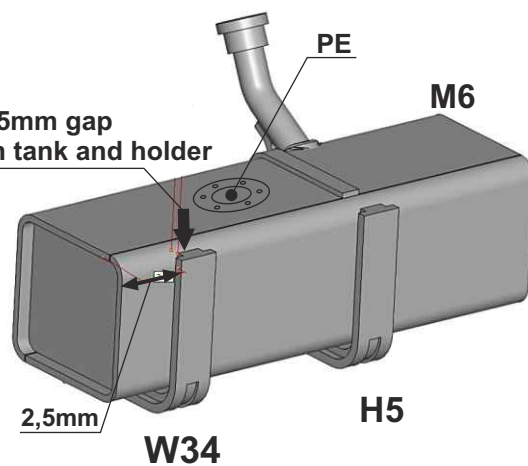
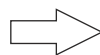

EE

E38

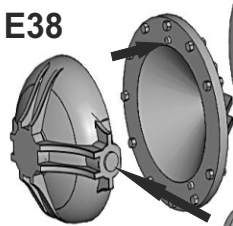

E39

F21

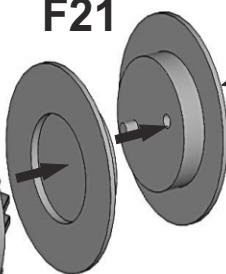

E28



E13

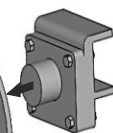

FF  
make 6

Z23  
(H2)

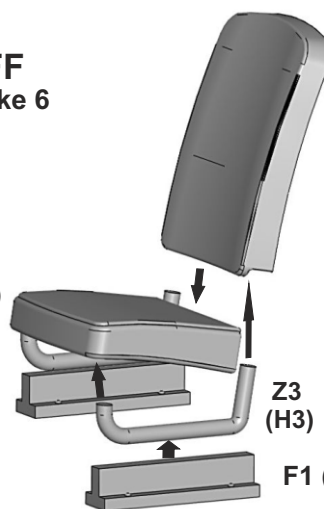

Z22  
(H1)

Z3  
(H3)

F1 (F2, H15)

GG

E32

E33

E30

E31

E29

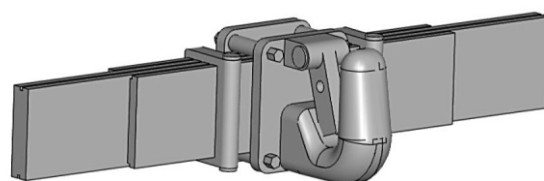
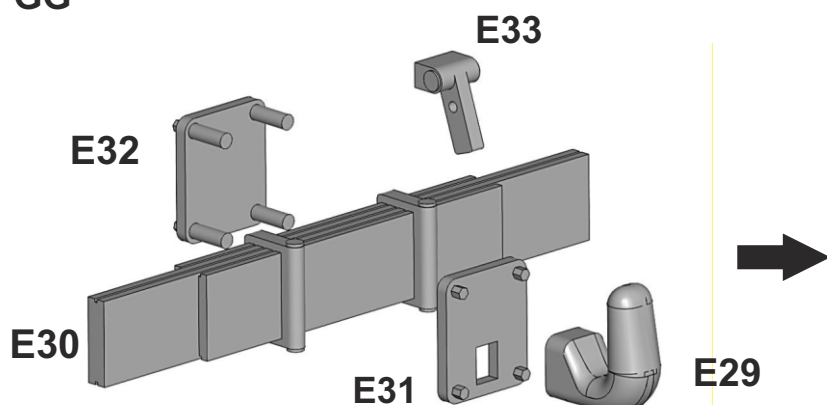

rear axle

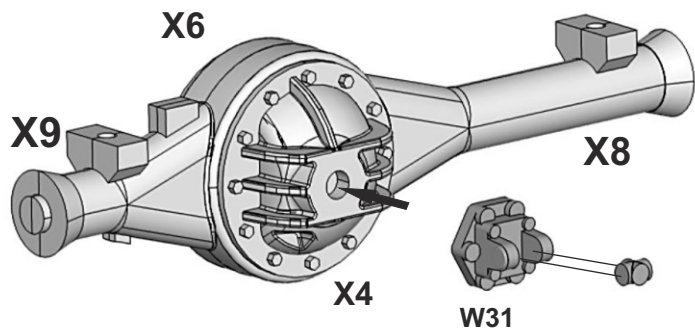

front axle

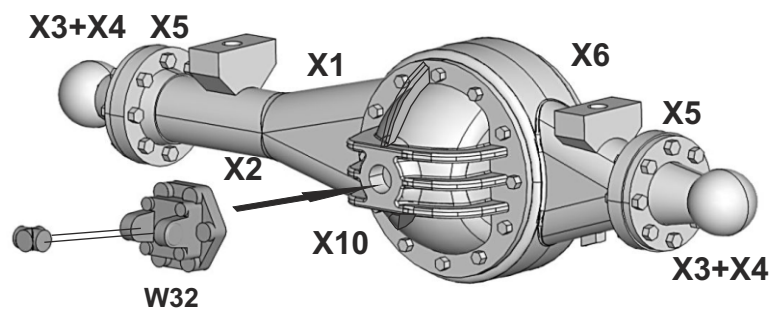

II

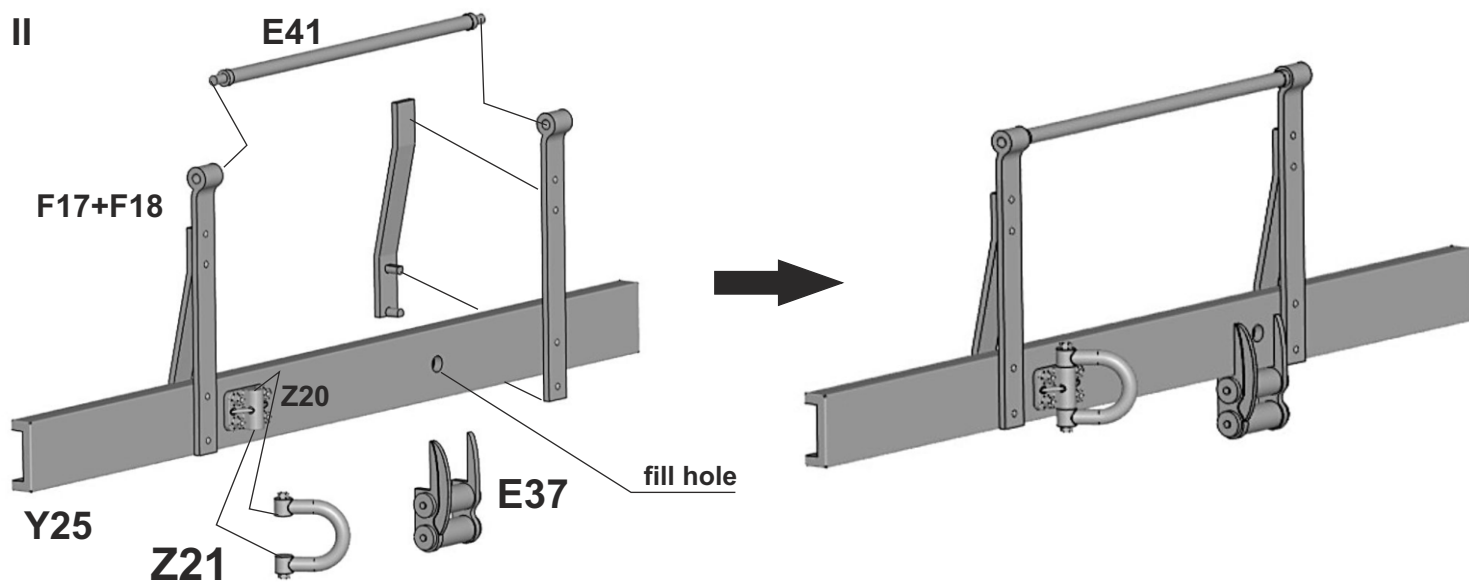

Frame assembly

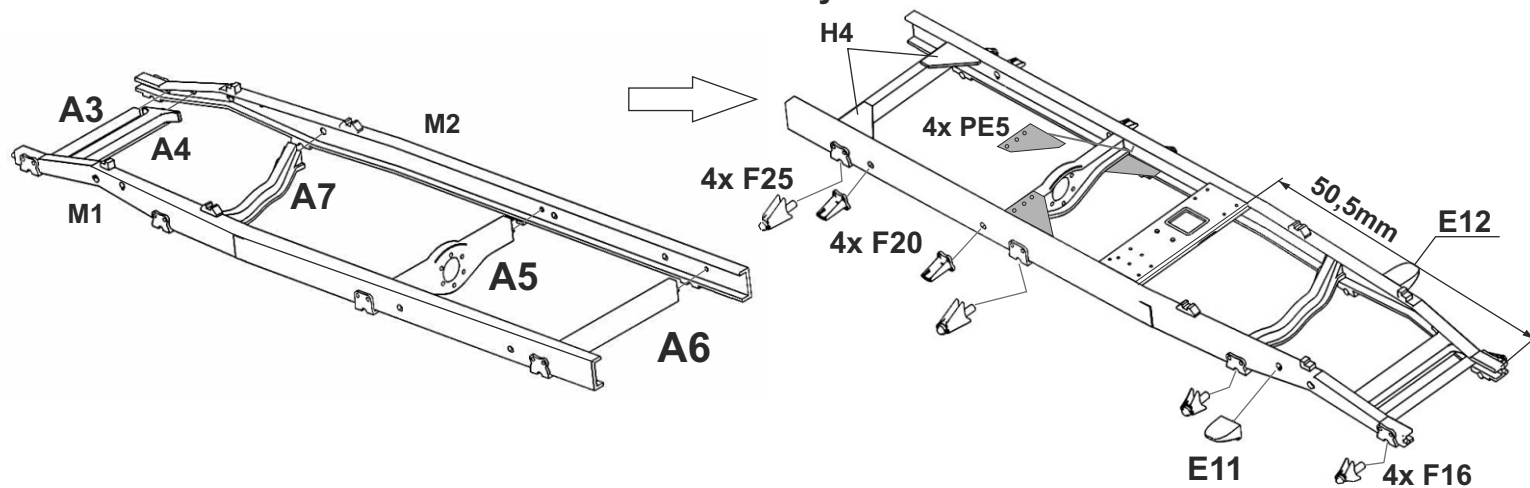

E28 touches crossbeam A5

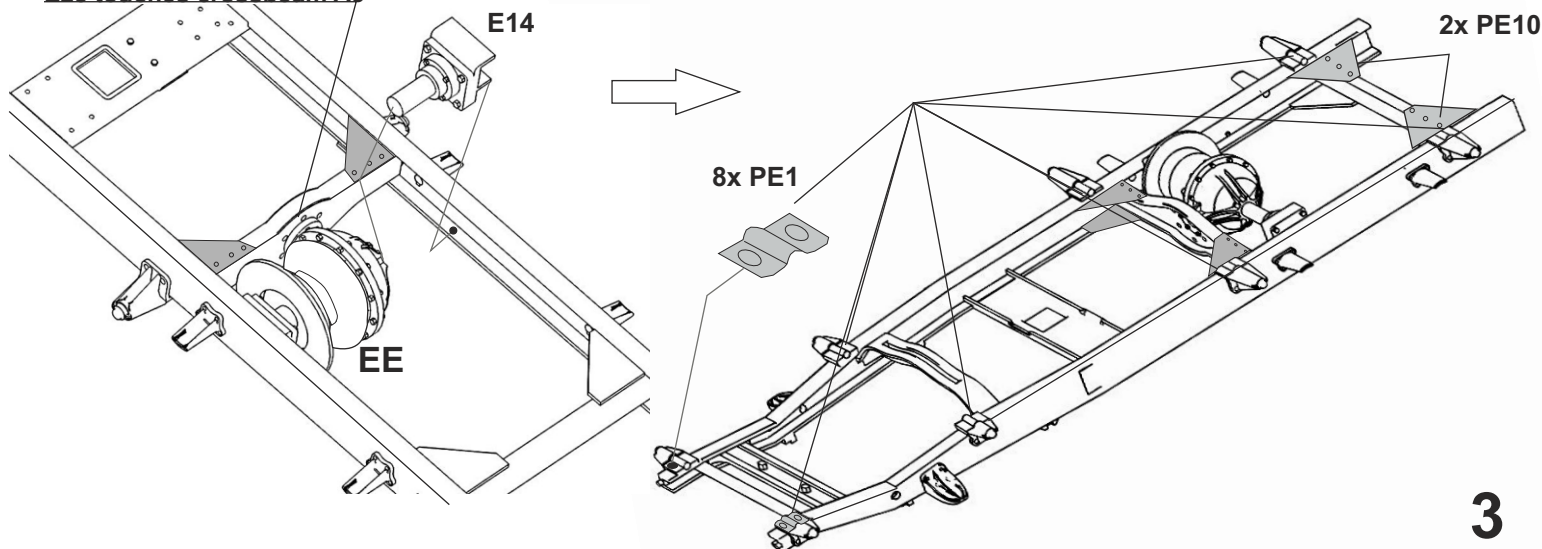



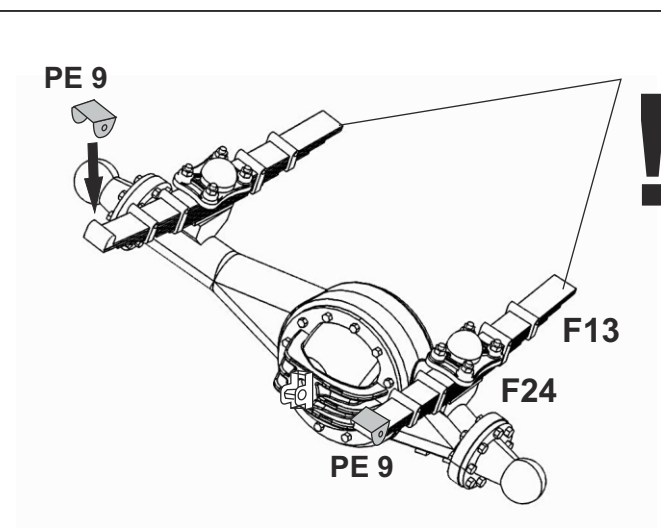
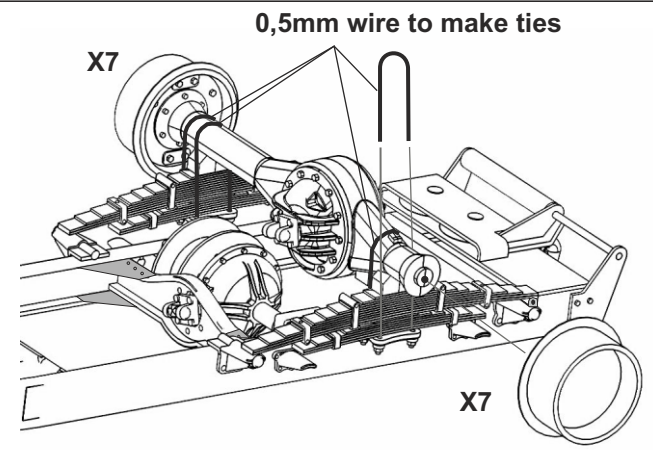
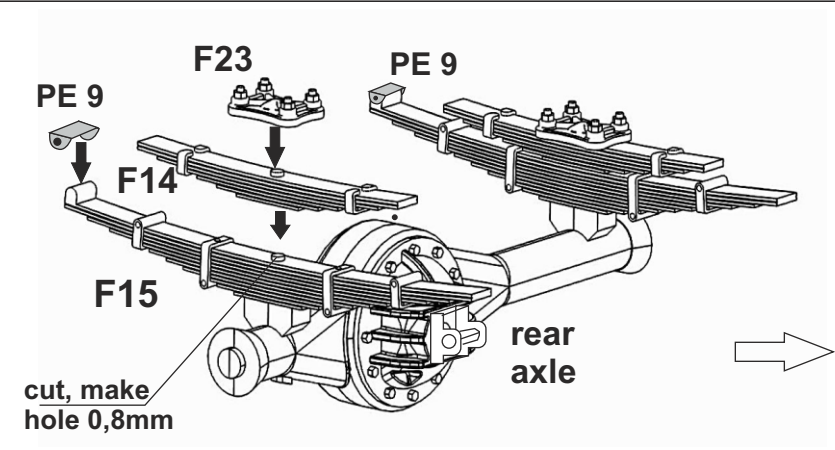
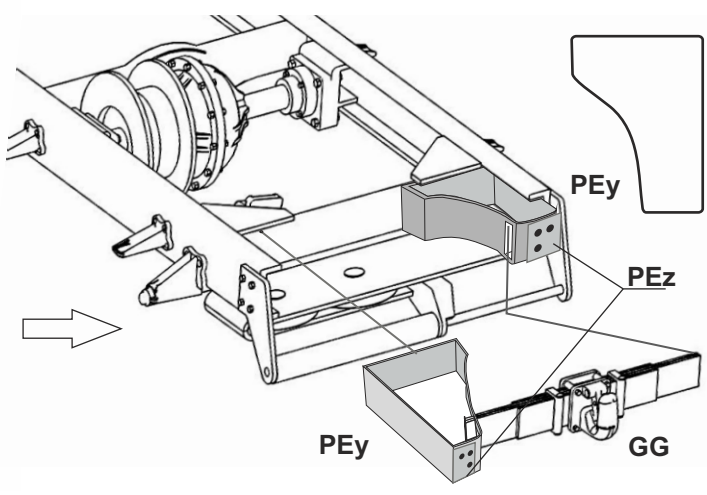
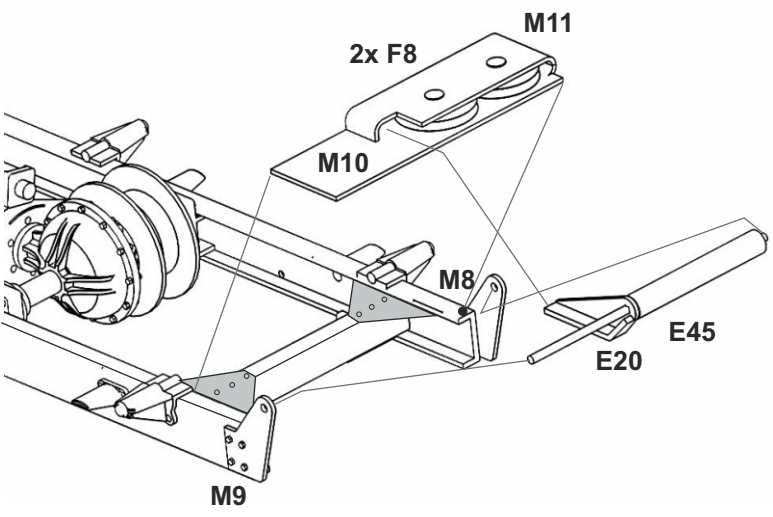

Set angle between front springs according to angle between front holders E16 before you glue springs on axle, check before glue dries!!!

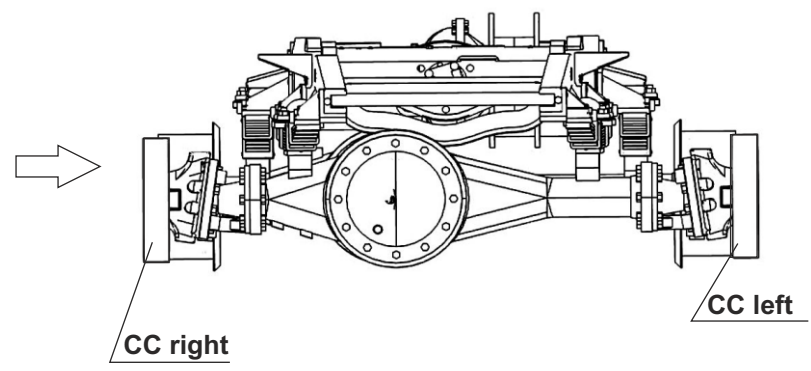
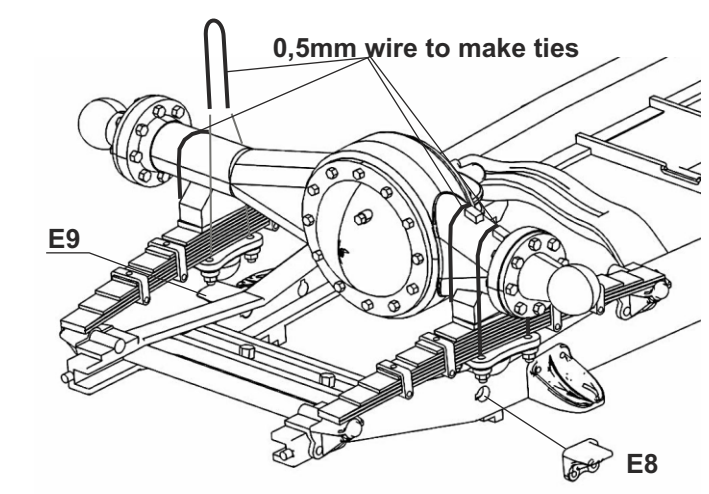
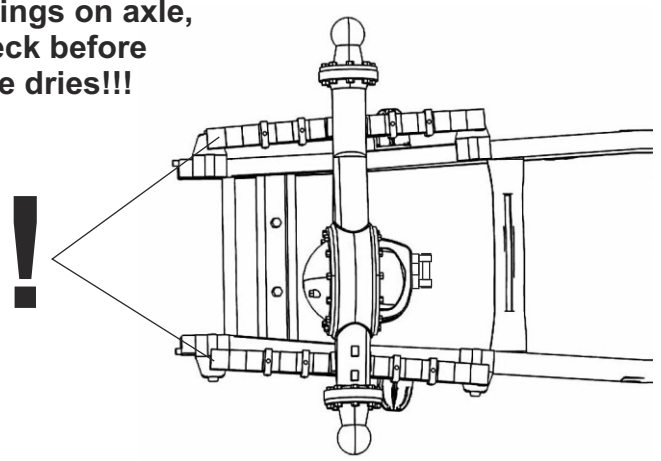

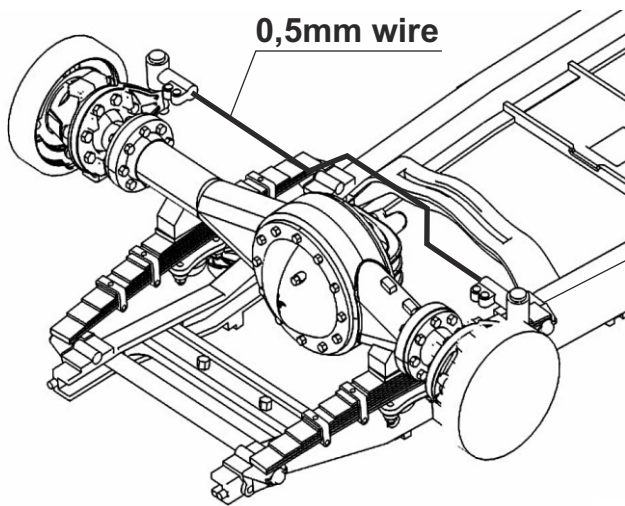

0,5mm wire

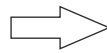

F6

F12

N21+N22

AA

glue engine AA in center between M1, M2

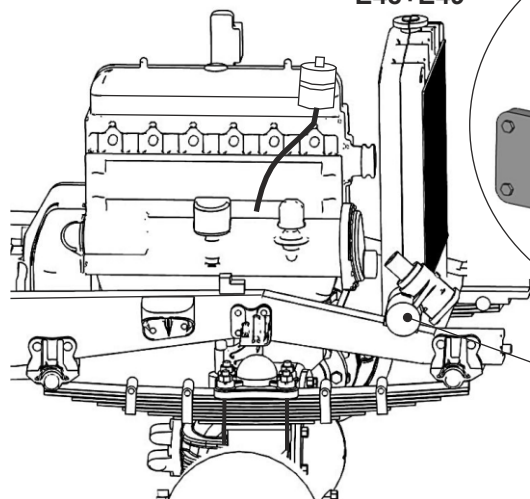
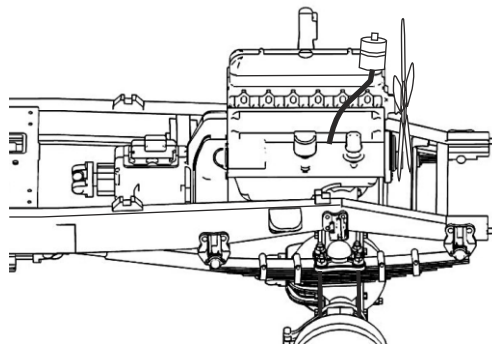

E48+E49

E22

E21

E23

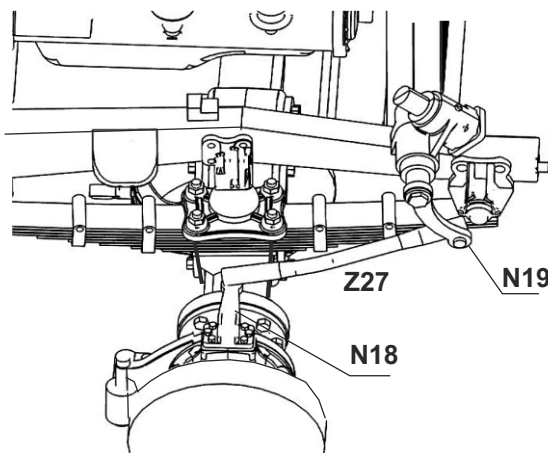

Z27

N19

N18

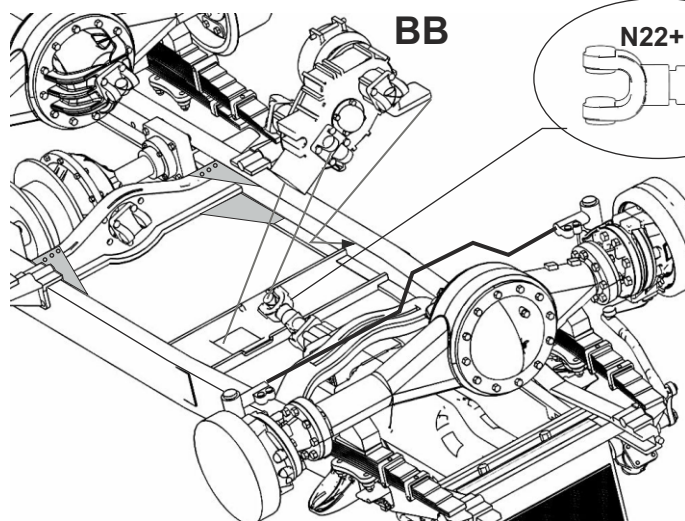

BB

N22+N23

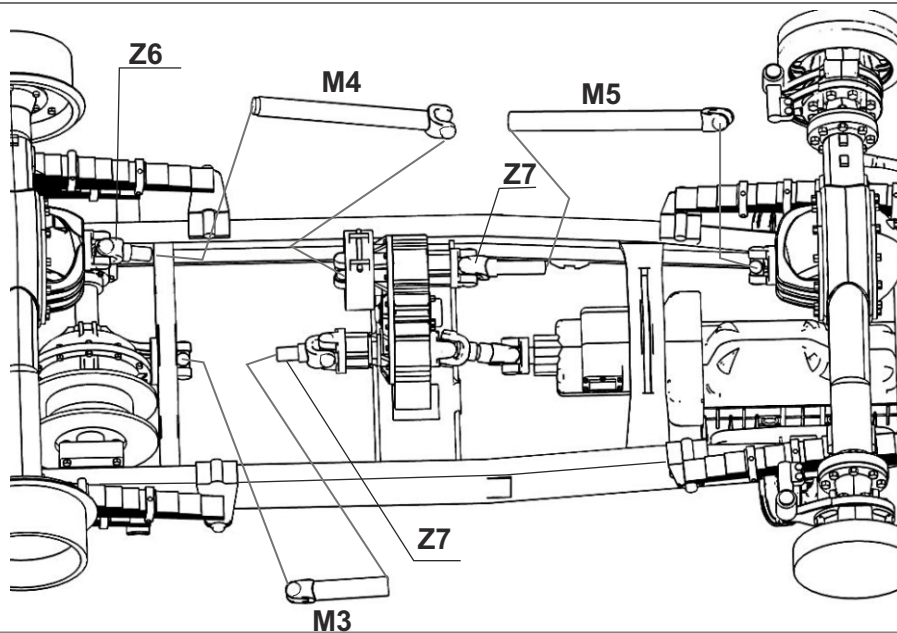

Z6

M4

M5

Z7

Z7

M3

cut Z6 and Z7  
to the length needed



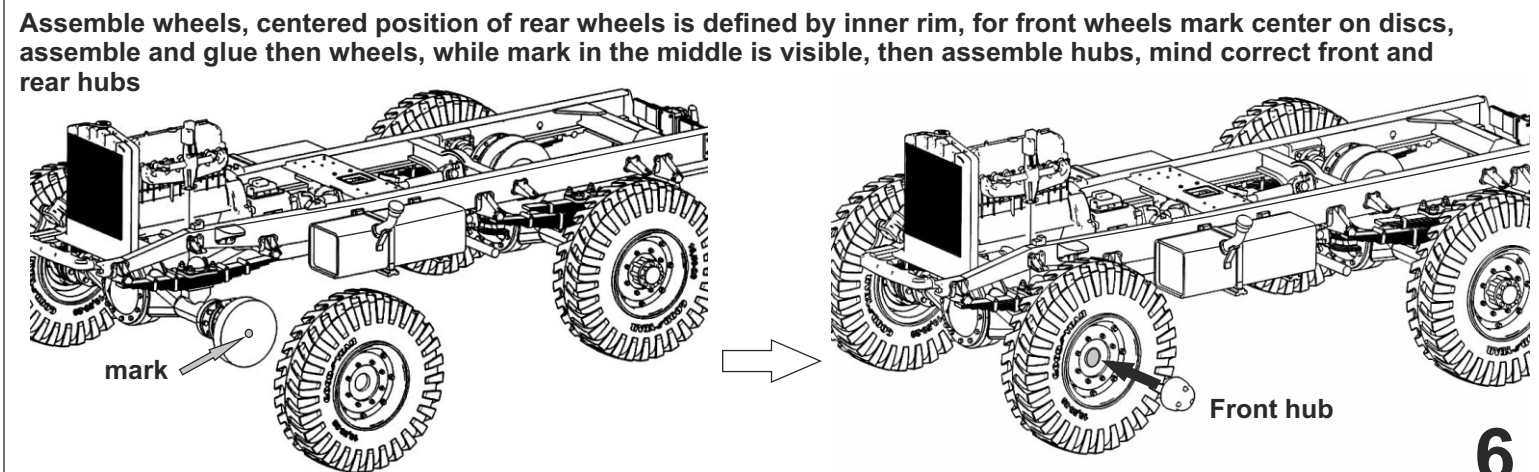
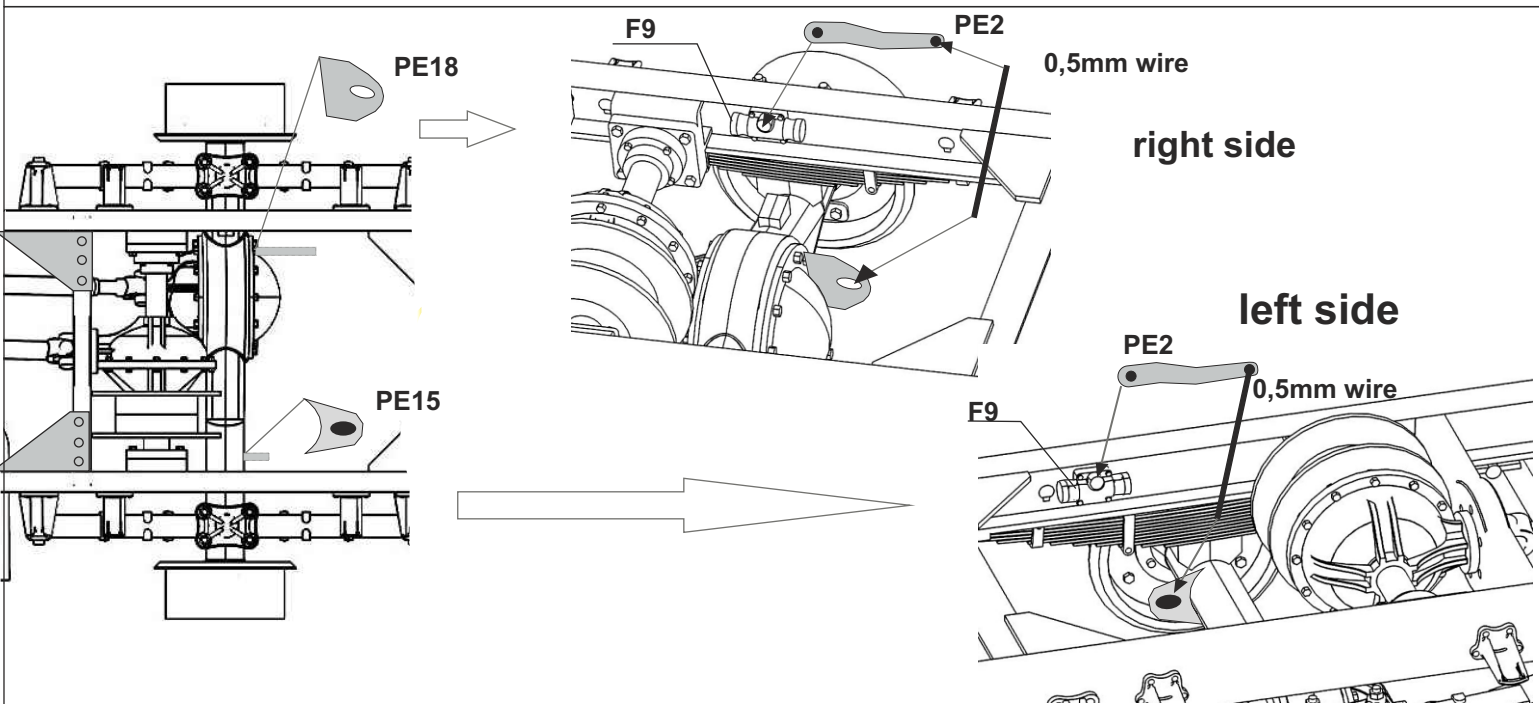
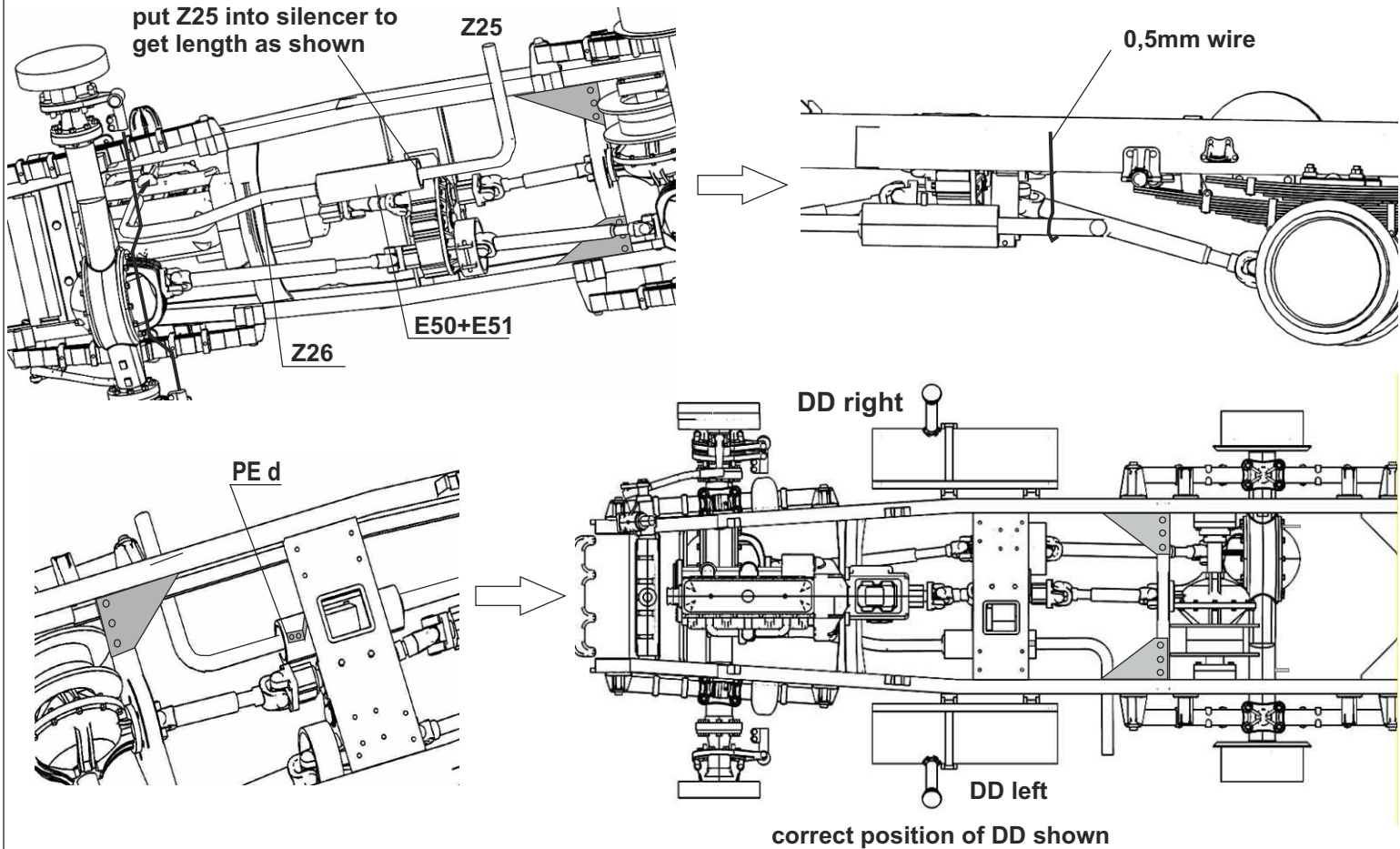

# Body assembly

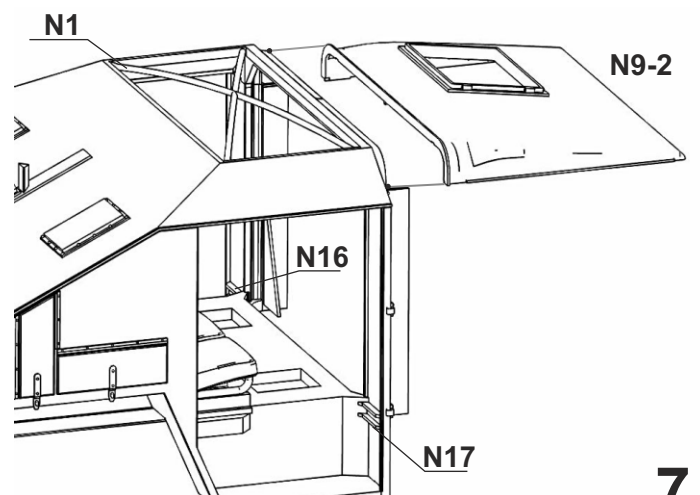
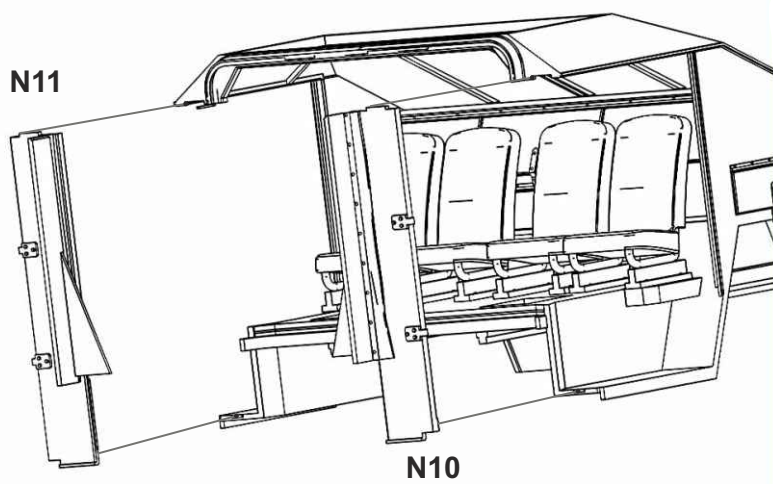
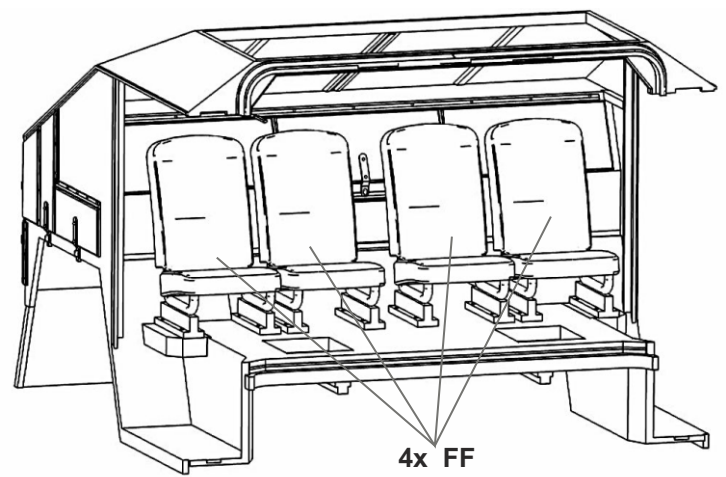
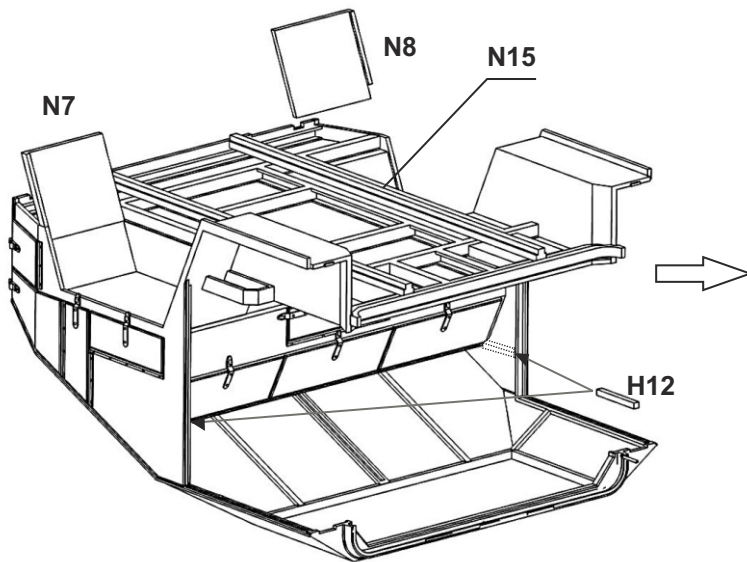
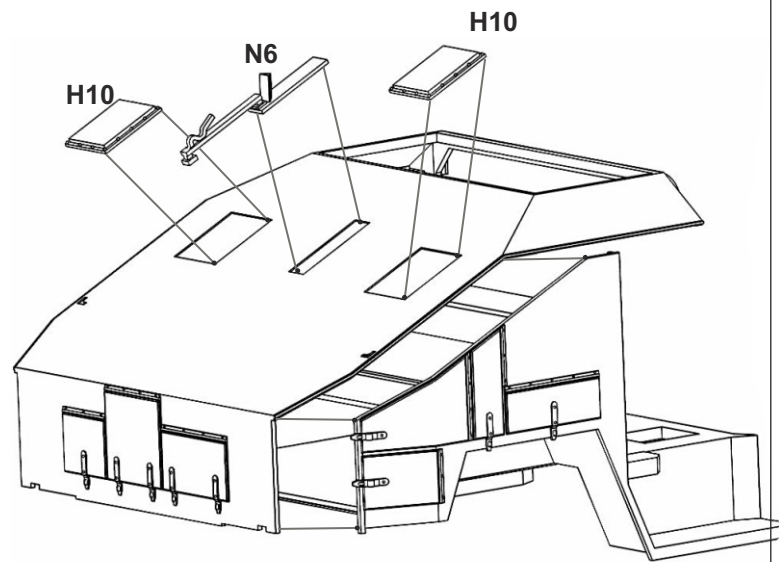
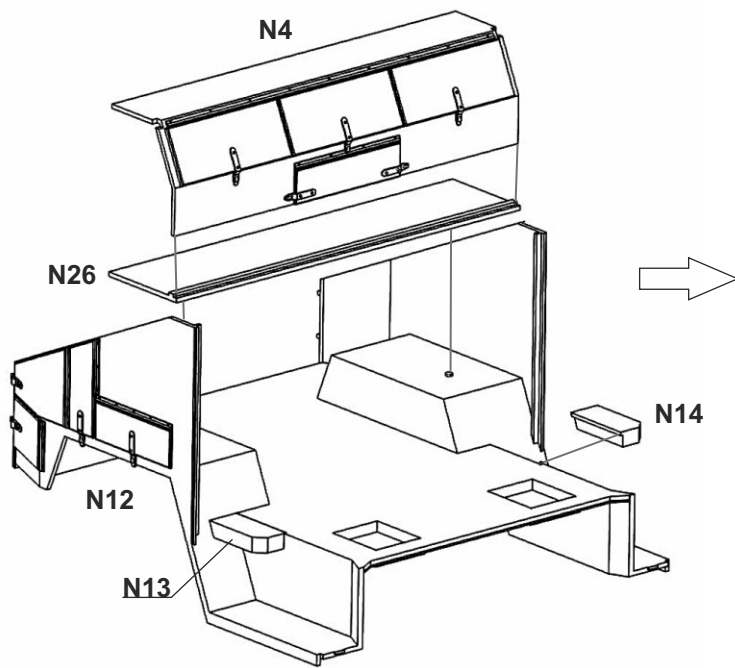



hatch can be assembled closed or open

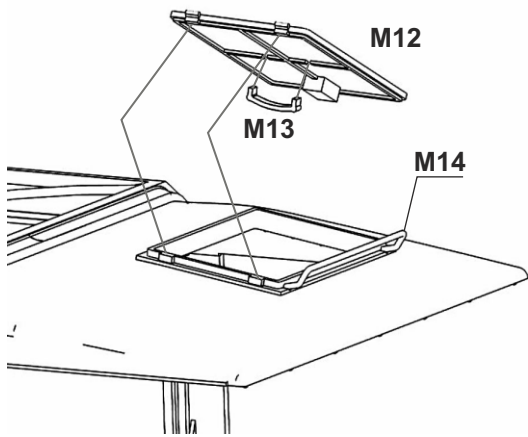

H9

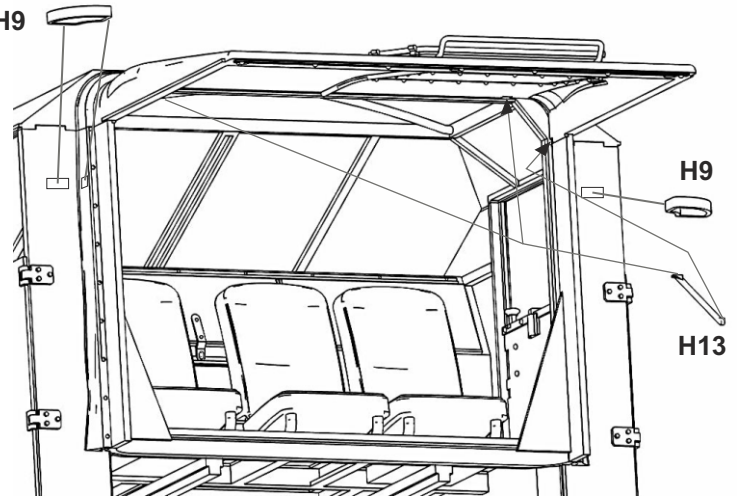

doors can be assembled closed or open

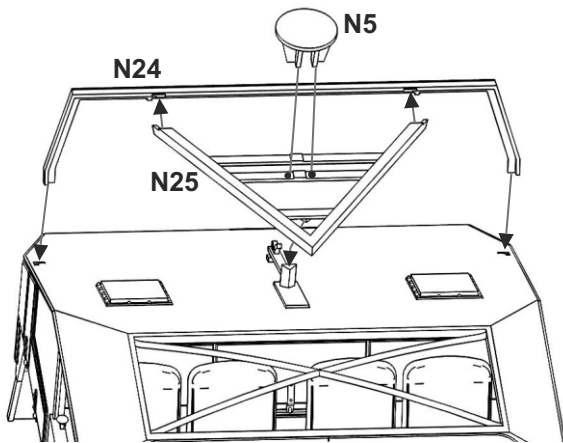

H14

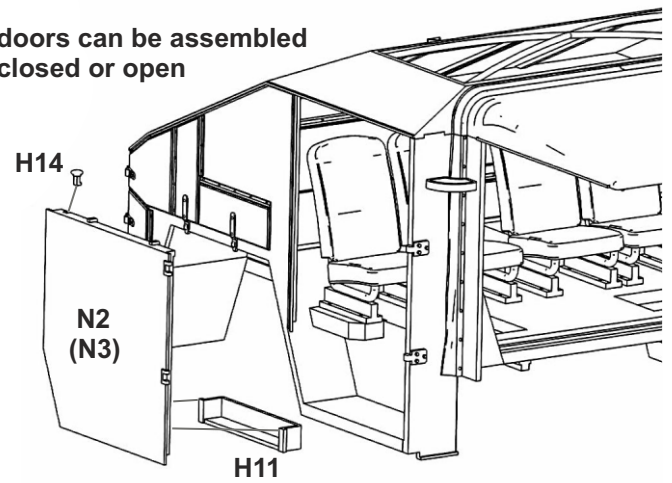

### Cab13 assembly

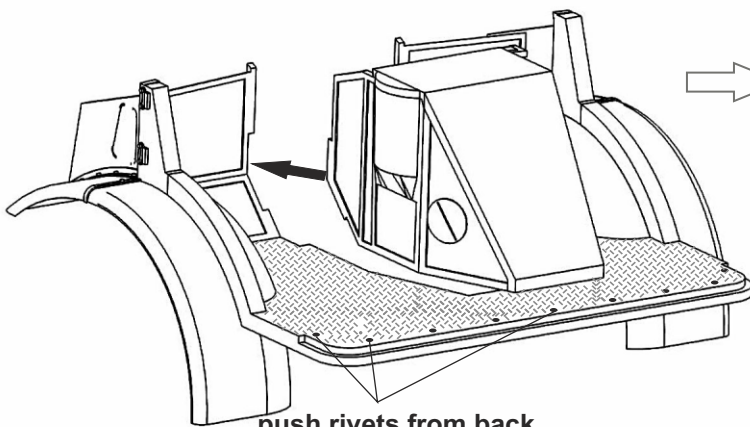
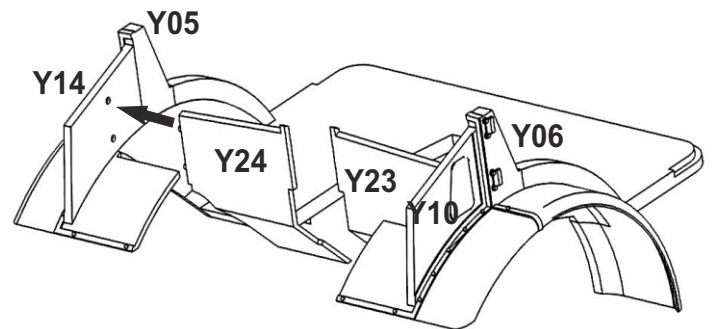
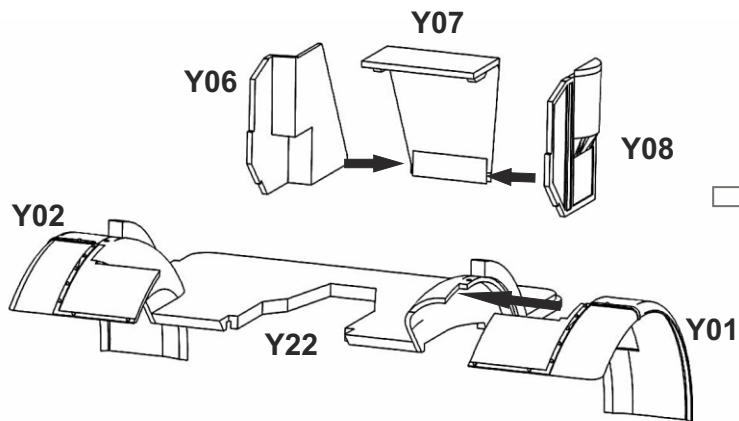

push rivets from back,  
assemble PE floor pattern, then dog house

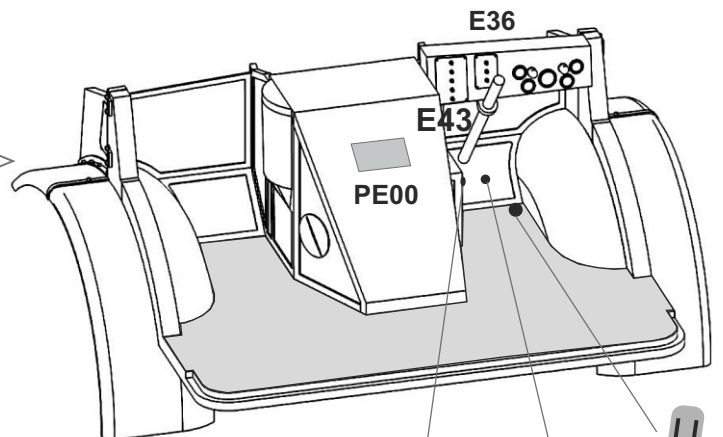

PE pedals



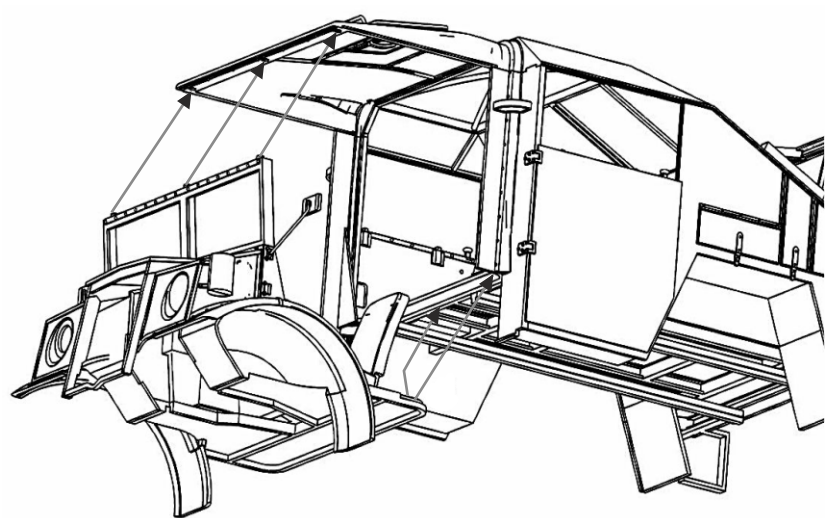
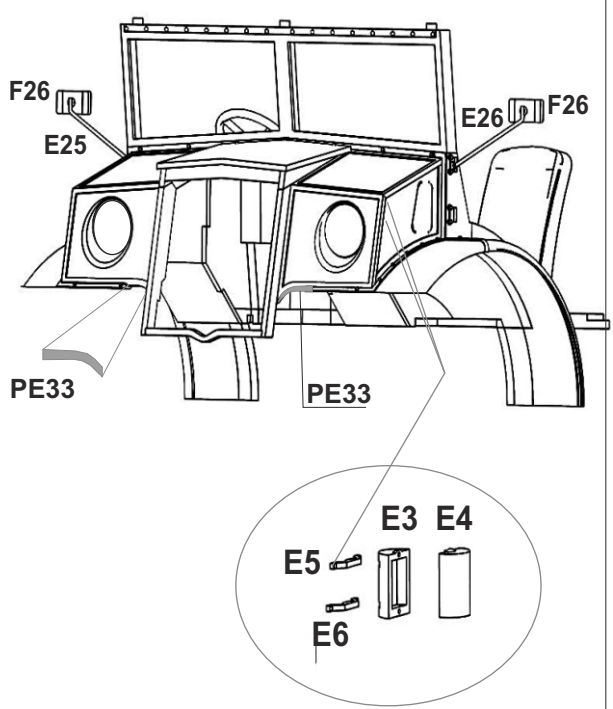
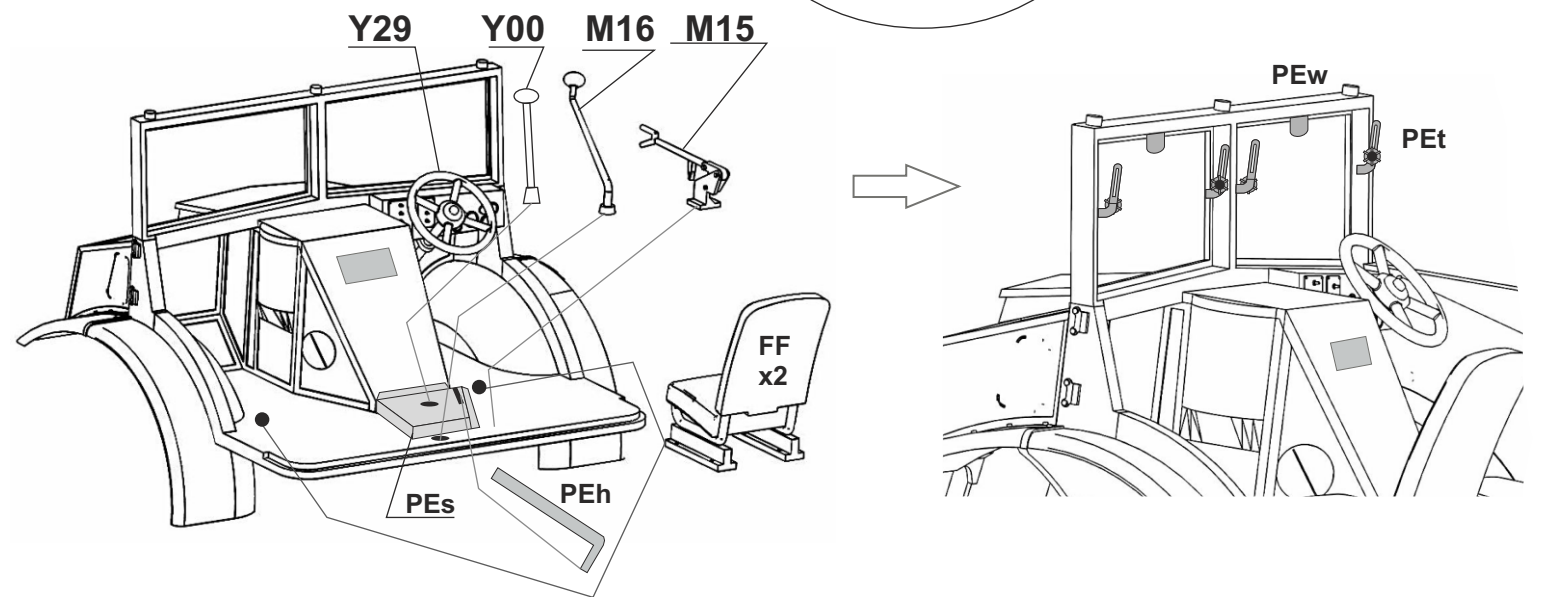
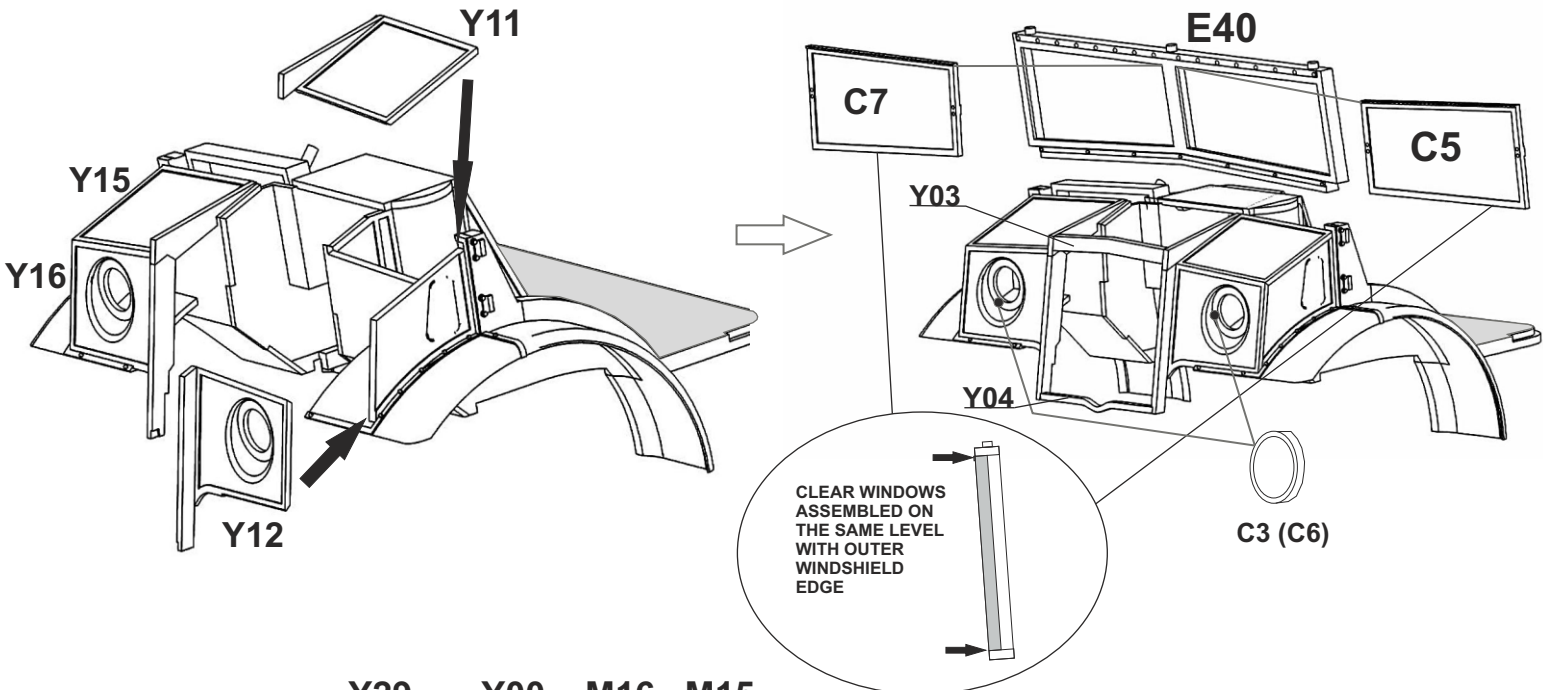



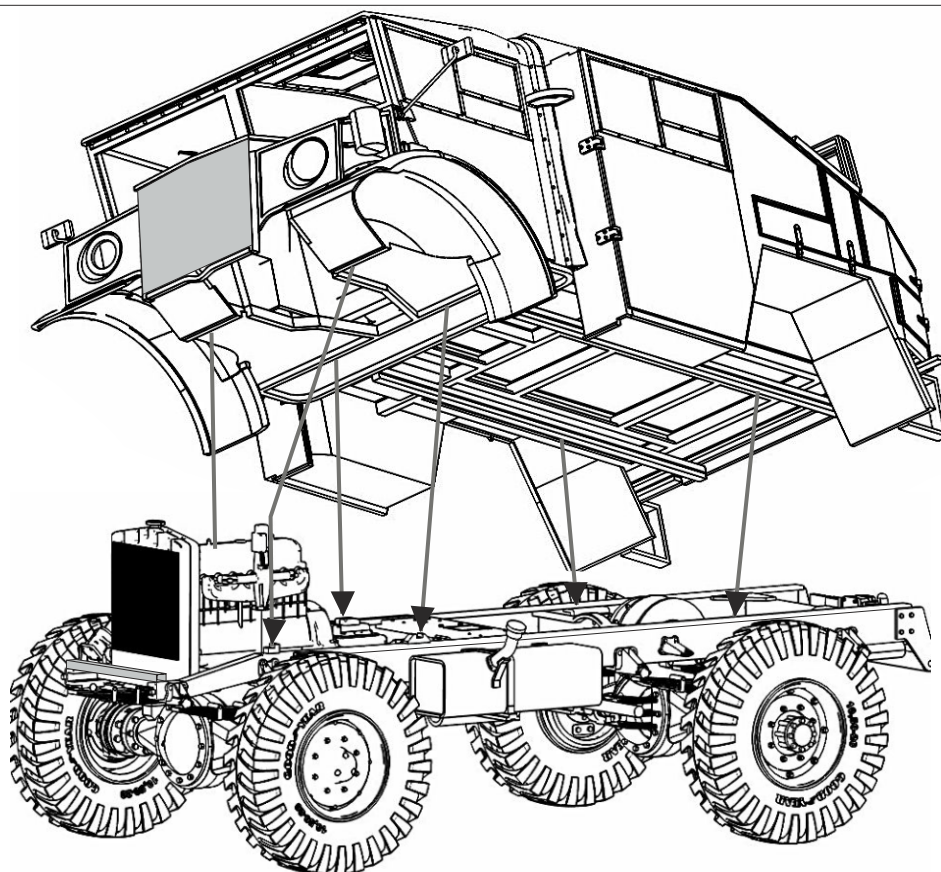
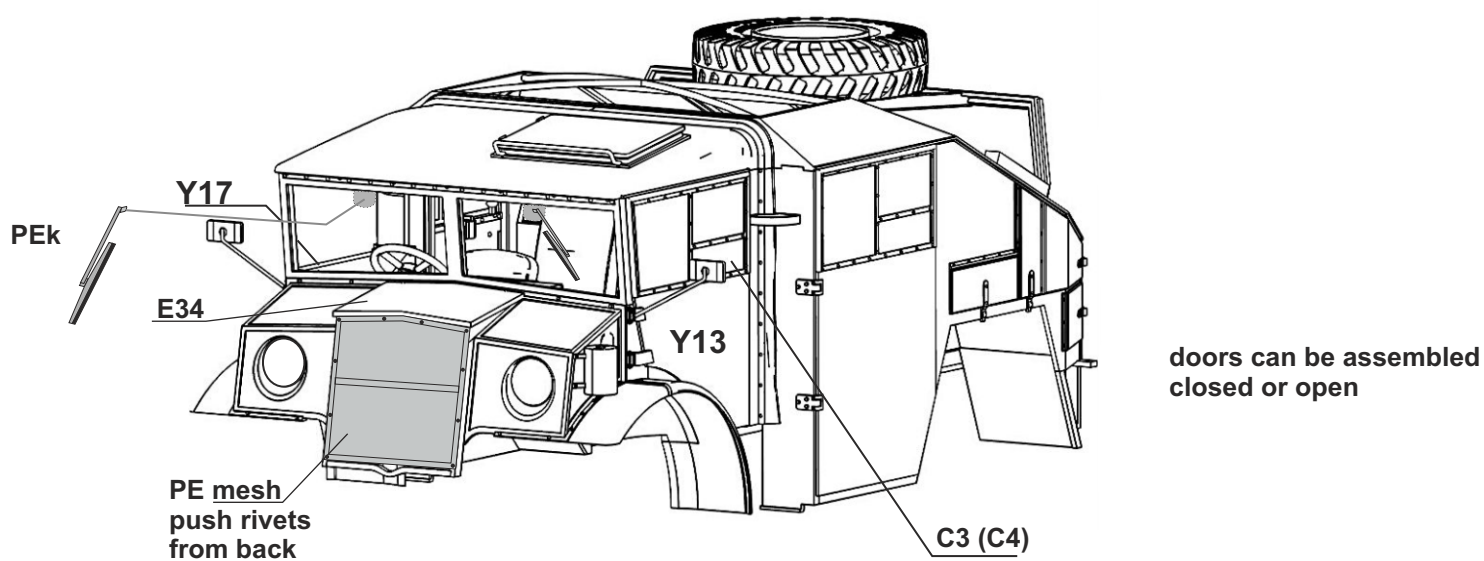
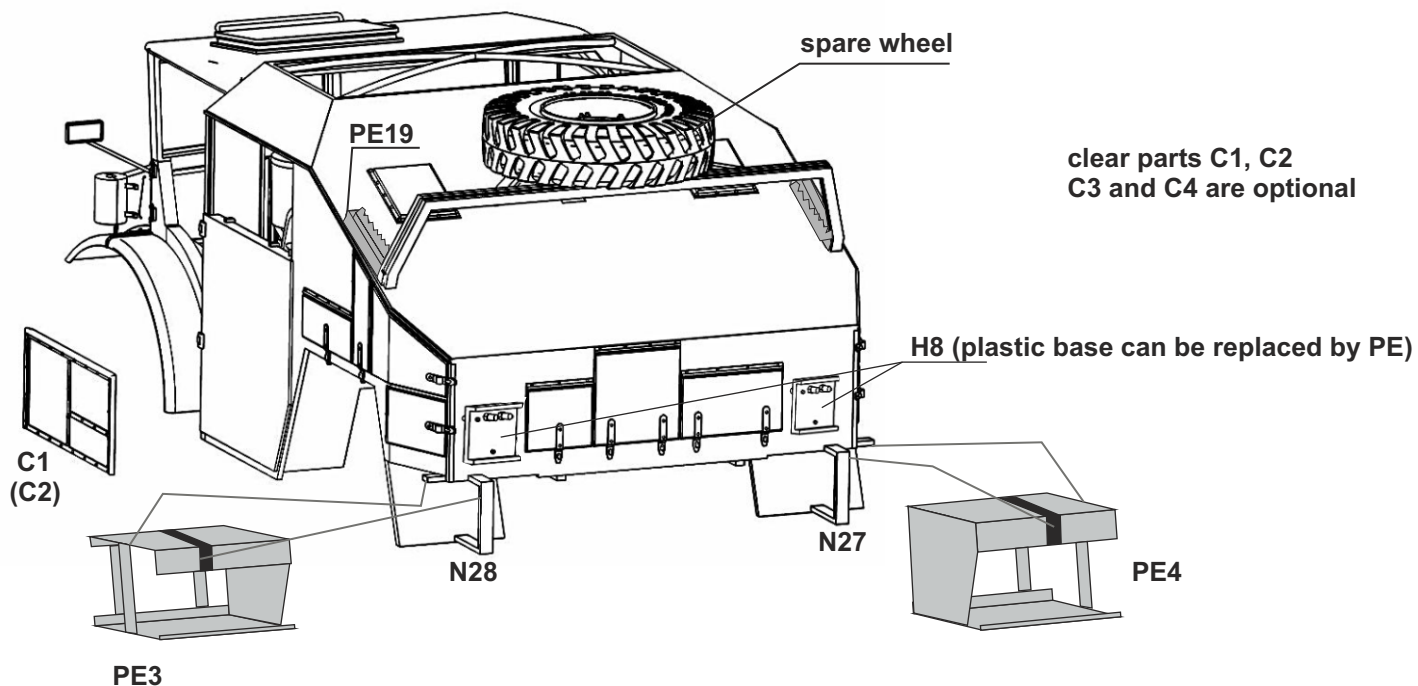



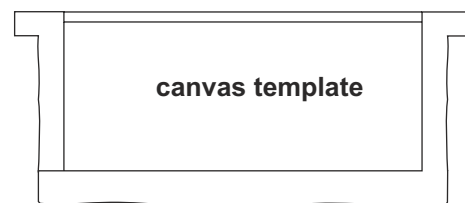
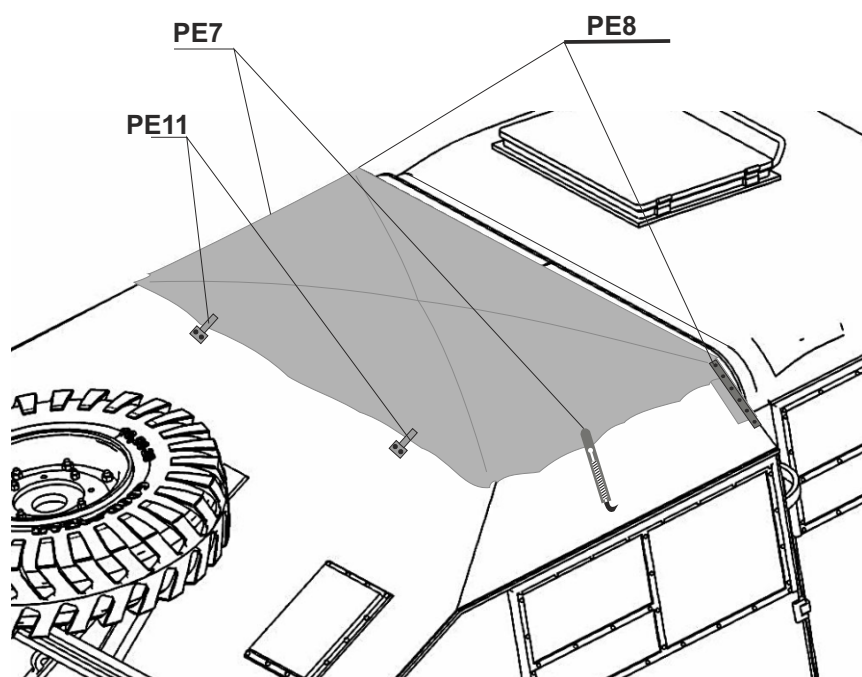
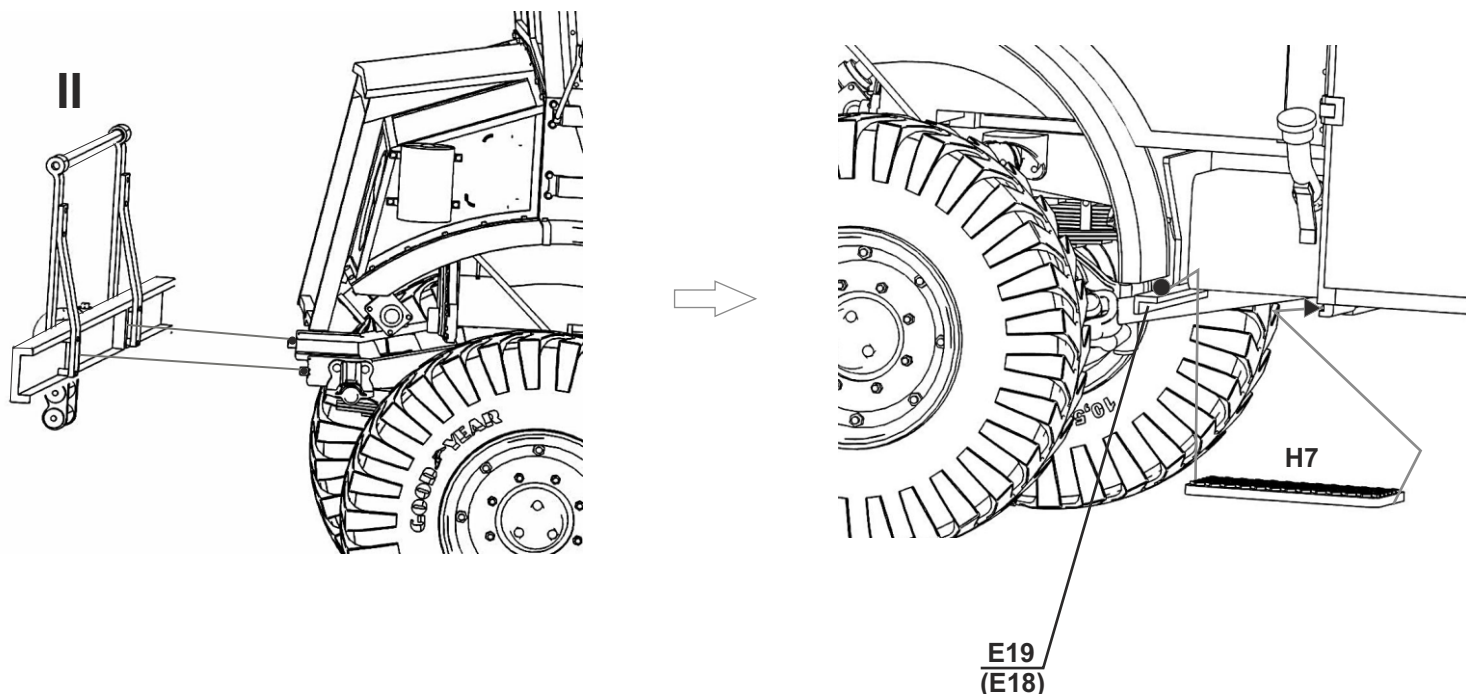

fine texture cloth for canvas included, you can use printed template and make up creased cloth canvas and glue it with C/A over the opening. Even better result can be achieved with use of thin paper napkin, soaked with water base paper glue, while wet, it can be perfectly formed - after drying it forms into tiny shell that can be again glued over the opening. Another possibility is to leave opening uncovered and roll the canvas on the back body

Additional detailing set to replace and upgrade plastic kit parts available in late January at [www.LZmodels.com](http://www.LZmodels.com)  
If you have experienced missing or damaged part, contact us directly for replacement at [info@mirror-models.com](mailto:info@mirror-models.com)

Hi-res assembly instructions in PDF available to download at  
<http://www.mirror-models.com/135-CMP-CGT-FAT-Cab13.html>